



Hamilton
Public Works

**Public Works Department
Corporate Assets and Strategic Planning Division**

**Crown Point East Neighbourhood Park: Closure
of a Portion of Public Assumed Alleyway and
Closure of Portion of Roxborough Avenue to
Vehicular Traffic (PW14051) – Ward 4**

Public Works Committee – May 22, 2014

~Providing services that bring our City to life !

Outline of Presentation

- Overview of application and Park development
- Illustration of new park
- Key Map and photographs
- Consultation with Neighbouring Property Owners
- Consultation with City Departments/Public Utilities
- Evaluation of Application
- Aerial Drawing of Subject Lands
- Recap of staff recommendations

→ Community
→ People
→ Processes
→ Finance



Hamilton
Public Works

Overview

- The Crown Point East neighbourhood is an area of parkland deficiency
- The City has purchased properties to assemble lands required to develop the Crown Point East Neighbourhood Park
- This plan includes:
 - the permanent closure of a portion of the public assumed alleyway between Province Street North and Graham Avenue North
 - the closure of a portion of Roxborough Avenue to vehicular traffic
 - the establishment of a new access to the remaining assumed alleyway
- This initiative supports the objectives set out in the Crown Point Neighbourhood Action Plan, endorsed by Council on February 23, 2014

→ Community
→ People
→ Processes
→ Finance



Hamilton
Public Works

Illustration of New Park

- Community
- People
- Processes
- Finance



Hamilton
Public Works

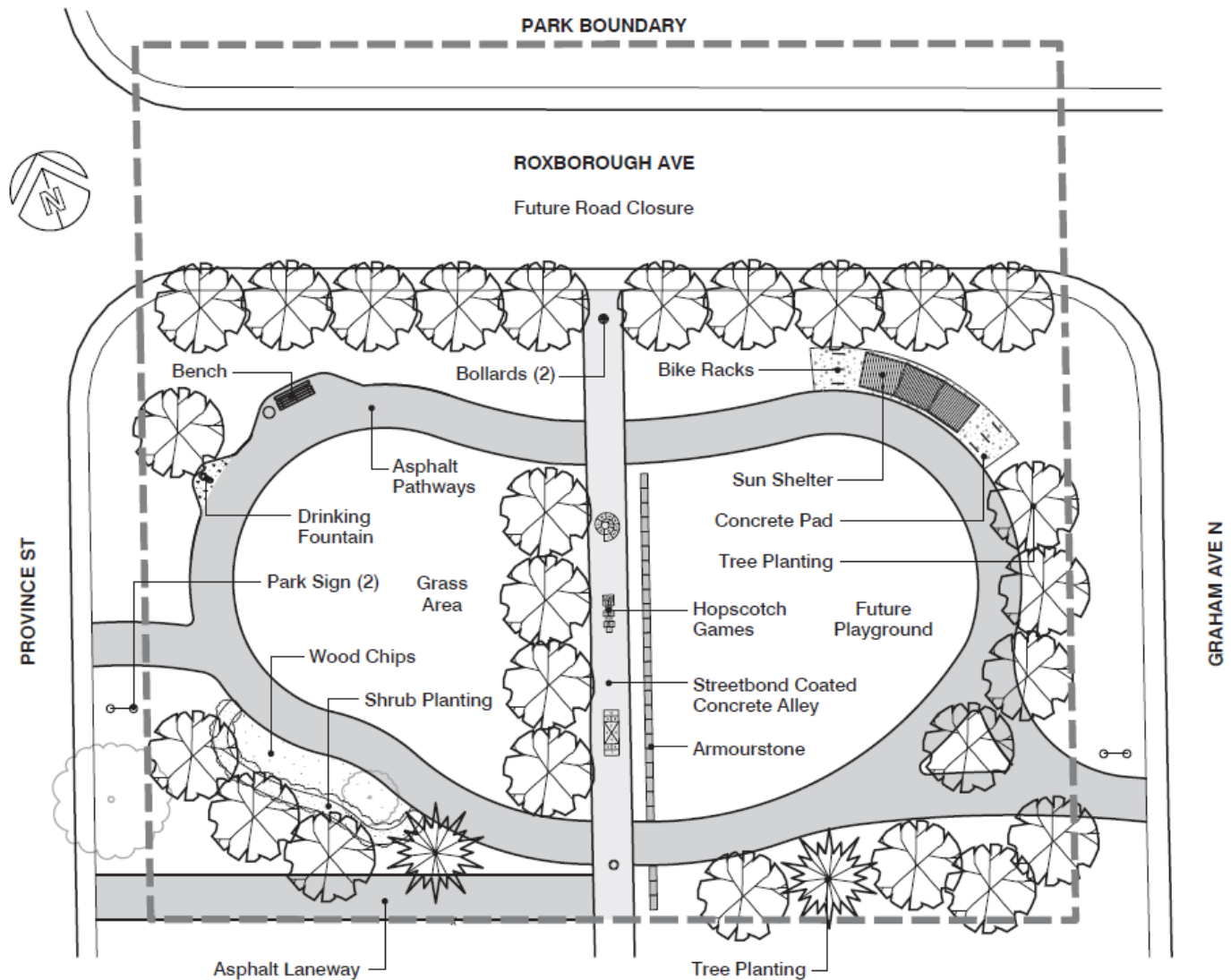

Alleyway Closure – Crown Point East neighbourhood

Key Map

- Community
- People
- Processes
- Finance



Hamilton
Public Works



Photographs (Roxborough area to be closed)

- Community
- People
- Processes
- Finance



Hamilton
Public Works



**Roxborough Ave to be closed
from Graham Ave North**

**Roxborough Ave to be closed
from Province St North**



Alleyway Closure – Crown Point East neighbourhood

Photograph (alleyway to be closed)

- Community
- People
- Processes
- Finance



Hamilton
Public Works



South end of alleyway to be closed - view towards Roxborough



North end of alleyway to be closed - view from Roxborough

Photograph (new access to alleyway)

- Community
- People
- Processes
- Finance



Hamilton
Public Works



East end of new access to the alley – view from alley to Province St North

West end of new access to the alley – view from Province St North



Consultation with Neighbouring Property Owners

- Two Public Information Centres (Nov. 1, 2011 and June 6, 2012) as well as a public barbeque were held to discuss the plans for the park
- Staff met with representatives and staff from Queen Mary Elementary School on three occasions to provide updates and seek input on this initiative
- Notice of the closures was provided to the owners of the 104 properties within a 121.9 metre (400') radius of the subject lands

→ Community
→ People
→ Processes
→ Finance



Hamilton
Public Works

Consultation with Neighbouring Property Owners

- Community
- People
- Processes
- Finance



Hamilton
Public Works

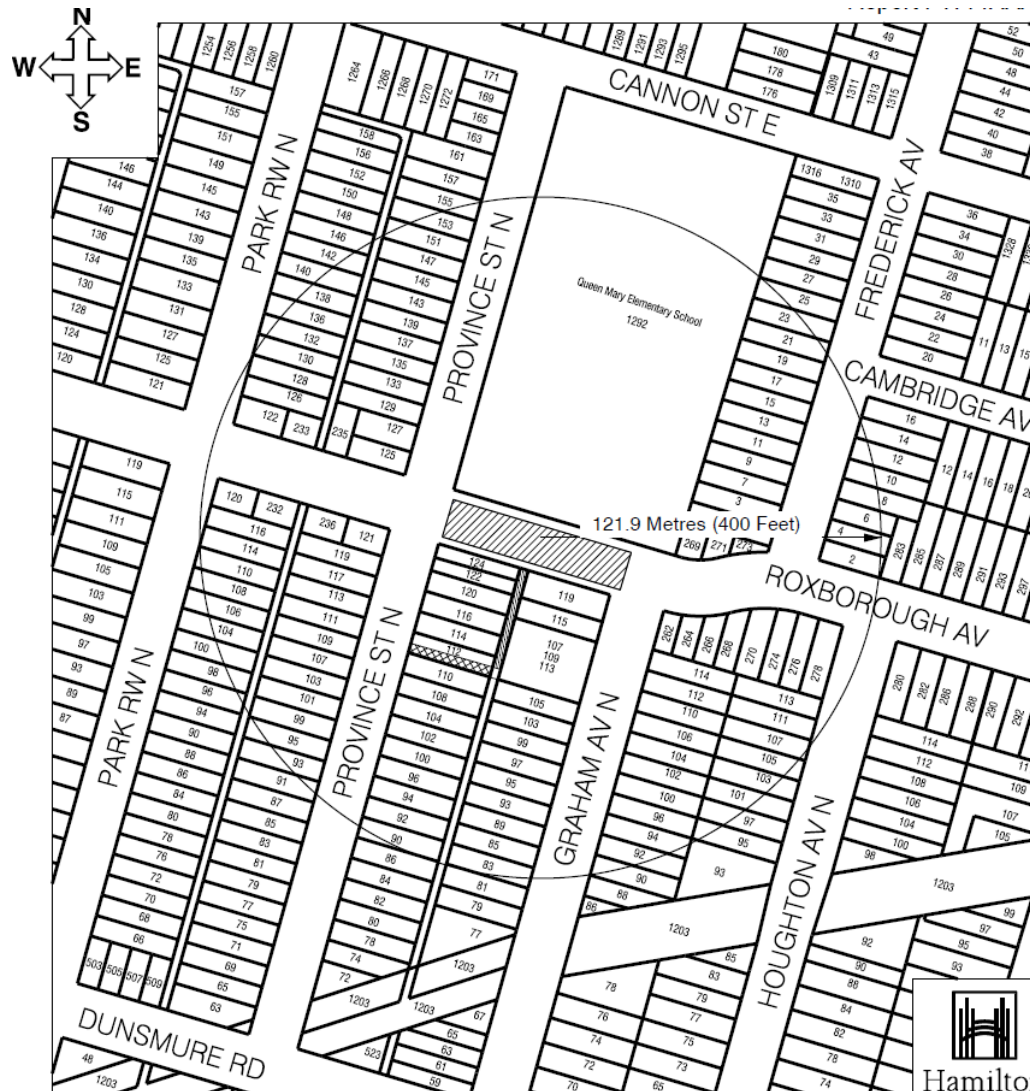

Consultation with Neighbouring Property Owners

- Responses to circulation:
 - 6 responses in support of the application
 - 11 responses in opposition of the application
- Summary of oppositions concerns:
 - Loss of Parking
 - Increased Time for Emergency Vehicles
 - Continued Access to remaining open alleyway
- Property owners who responded in opposition were invited to an additional meeting on March 3, 2014 to discuss their concerns

→ Community
→ People
→ Processes
→ Finance



Hamilton
Public Works

Consultation with Neighbouring Property Owners

Loss of Parking:

- Minimal impact to existing parking because the proposed area of closure along Roxborough is primarily a no stopping zone
- The reduction to on-street parking would be no more than five spaces

Emergency Vehicle Response Time:

- Hamilton Fire Department reviewed impact of closure
- Increased response time can be overcome with a change to the signage at the intersection of Kenilworth Avenue North and Cannon Street to allow authorized emergency vehicles to turn left

- Community
- People
- Processes
- Finance



Hamilton
Public Works

Consultation with Neighbouring Property Owners

Continued Access to the remaining open Alleyway:

- The inclusion of a new paved access way from Province Street connecting to the remaining open alleyway will ensure continuous access for residents using the alleyway for rear parking

→ Community
→ People
→ Processes
→ Finance



Hamilton
Public Works

Consultation with City Departments/Utilities

→ Community
→ People
→ Processes
→ Finance



Hamilton
Public Works

- **Planning and Economic Development Department:**
 - Development Engineering Division
 - Planning Division
 - Economic Development and Real Estate Division
 - Building Services Division
- **Public Works Department:**
 - Environmental Services Division
 - Transit Division
 - Corporate Assets and Strategic Planning Division
- **Hamilton Emergency Services Department**
- **Community Services Department:**
 - Neighbourhood and Community Initiatives Division
- **The following were also notified of the proposal:**
 - Ward Councillor
 - Public Utilities: Bell, Hydro One, Horizon Utilities and Union Gas

Consultation with City Departments/Utilities

Operations Division (Roads Operations)

- Indicated the closure of Roxborough will require changes to the current snow plowing and street sweeping routes

Engineering Division (Geomatics & Corridor Management)

- Provided comments on the functional design for the new paved access to the alleyway and the barriers at Roxborough to promote pedestrian safety

Transit Division (Transportation Planning)

- Requested that access be maintained for the balance of the open alleyway

- Community
- People
- Processes
- Finance



Hamilton
Public Works

Consultation with City Departments/Utilities

Corporate Assets & Strategic Planning (Traffic Operations)

- The Manager of Traffic Operations will bring the appropriate by-law to Council to amend the traffic by-law to permit authorized emergency vehicles to turn left on Cannon Street from Kenilworth under existing delegated authority

Community Services (Neighbourhood & Community Initiatives)

- Concurs that the development of the park will be a positive proposal for the Crown Point East Neighbourhood.

- Community
- People
- Processes
- Finance



Hamilton
Public Works

Evaluation of Application

- Approving the application will allow the City to proceed with the development of the park
- Funding for the development, which includes the creation of the new alleyway paved access was approved in the 2013 Capital Budget process
- The closure of a portion of Roxborough Avenue closed to vehicular traffic will provide a safe transition between Queen Mary Elementary School and the new park
- The closure of the portion of alleyway will allow for incorporation into the park design
- Establishing the new access will ensure current vehicular users of the remaining alleyway do not lose access to rear parking and garages

→ Community
→ People
→ Processes
→ Finance



Hamilton
Public Works

Aerial Drawing Representing Proposed Closure and Sale

- Community
- People
- Processes
- Finance



Hamilton
Public Works



Proposed Permanent Closure of a Portion of the Road Allowance of Roxborough Avenue North and a Portion of Public Assumed Alley between Province Street North and Graham Avenue North, Hamilton

Surveys & Technical Services
Public Works Department

LEGEND

- Road to be closed
- Alley to be closed
- Proposed new alley access

NTS
11-07-2013
Sketch By: MM

Alleyway Closure – Crown Point East neighbourhood

Summary of Recommendations

Staff is recommending that:

- The permanent closure of a portion of the assumed alleyway by approved
- The closure of a portion of Roxborough Avenue to vehicular traffic be approved
- The portion of land described in Report PW14051 to be established and laid out as a public highway to provide continued alleyway access be approved

→ Community
→ People
→ Processes
→ Finance



Hamilton
Public Works



Hamilton
Public Works

PW14051

Thank You

Andrew Grice

Manager of Policy and Programs

Corporate Assets and Strategic Planning