

LOCATION PLAN

PROPOSED STOP CONTROL:

John Frederick Drive at Garner Road East

Corporate Assets & Strategic Planning
PUBLIC WORKS DEPARTMENT

LEGEND

● EXISTING STOP

● STOP PROPOSED STOP

SCALE
NOT TO SCALE
DATE
August 11, 2016

62M - 1221 "Cesar Place"

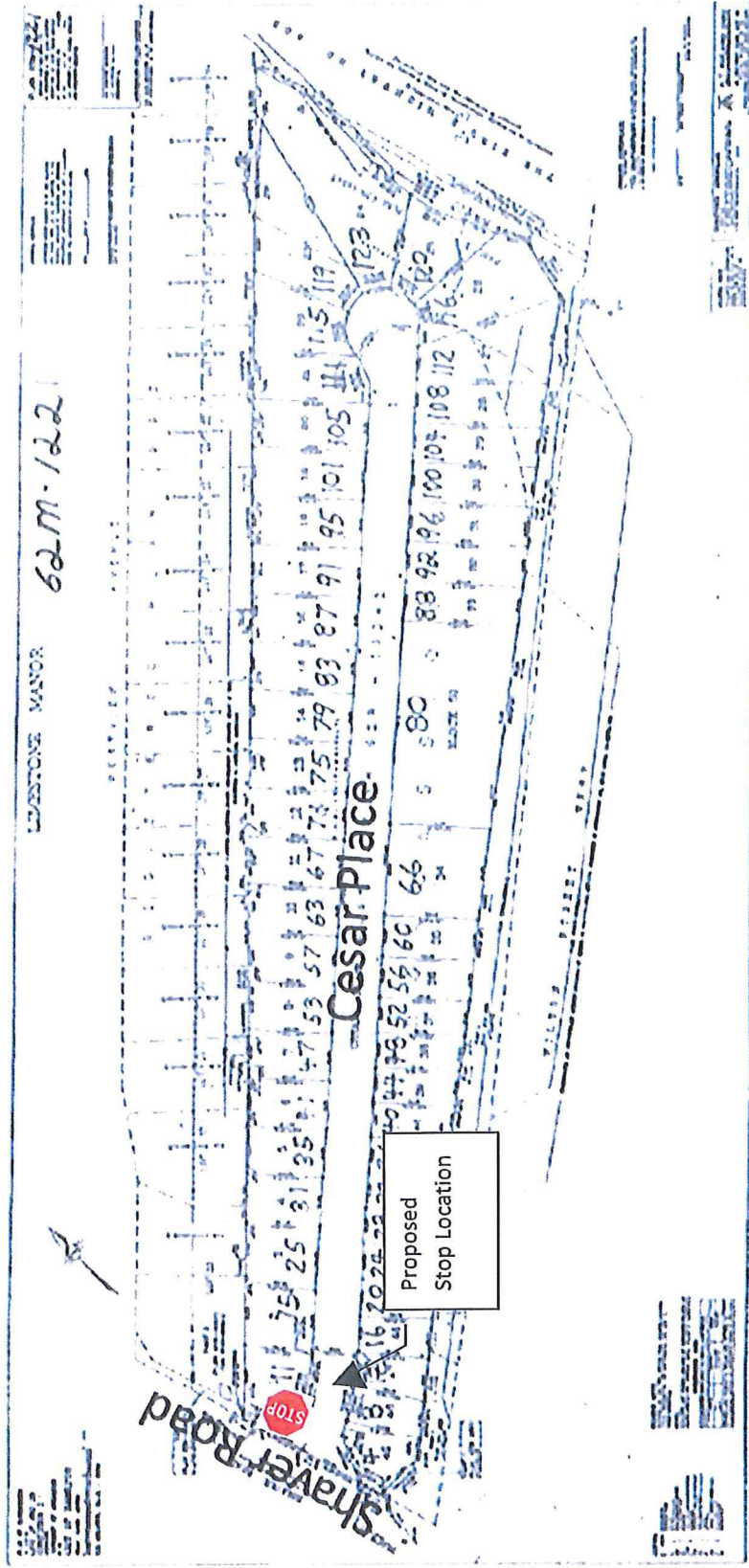

LEGEND

- EXISTING STOP
- PROPOSED STOP

PW Date: August 11, 2016

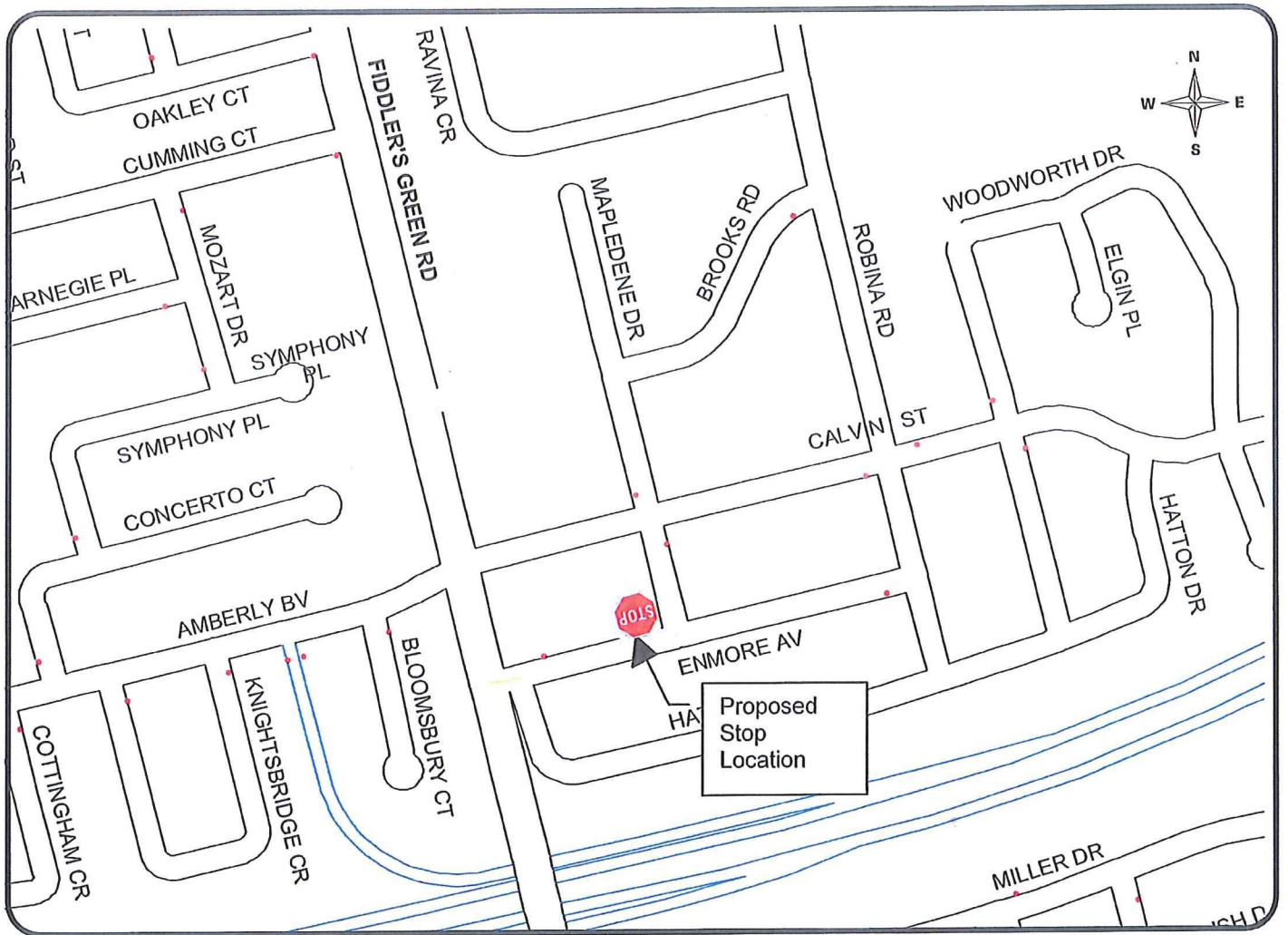

KEY MAP

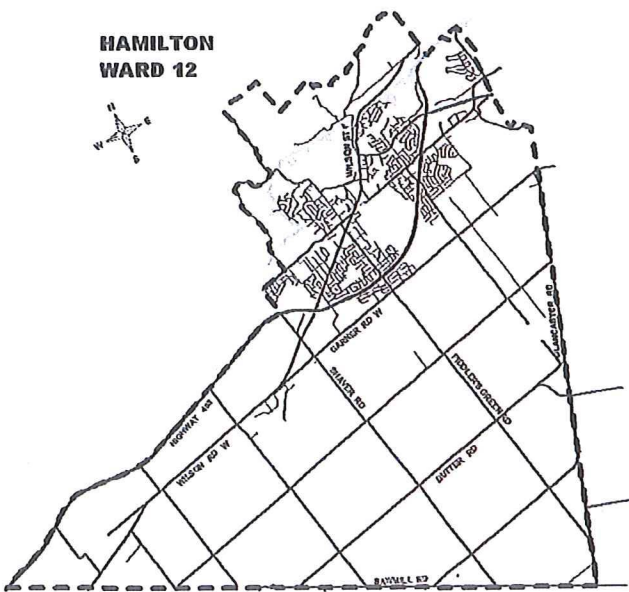

LOCATION PLAN

PROPOSED STOP CONTROL:

Mapledene Drive at Enmore Avenue

Corporate Assets & Strategic Planning
PUBLIC WORKS DEPARTMENT

LEGEND

● EXISTING STOP

● STOP PROPOSED STOP

SCALE
NOT TO SCALE

DATE
August 11, 2016

62M – 1222 “McMonies Drive”

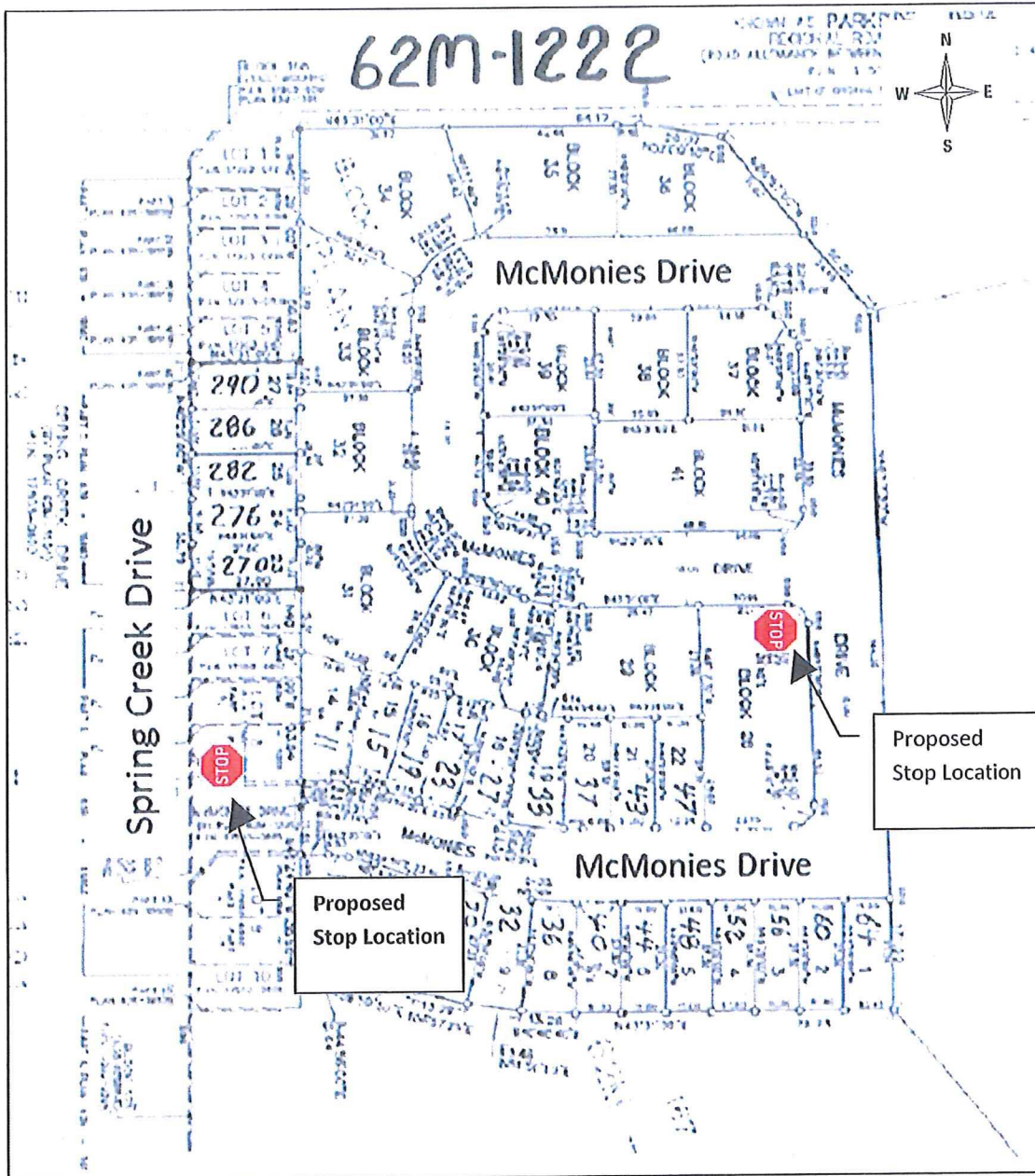

LEGEND	
	EXISTING STOP
	PROPOSED STOP

PW Date: August 11, 2016

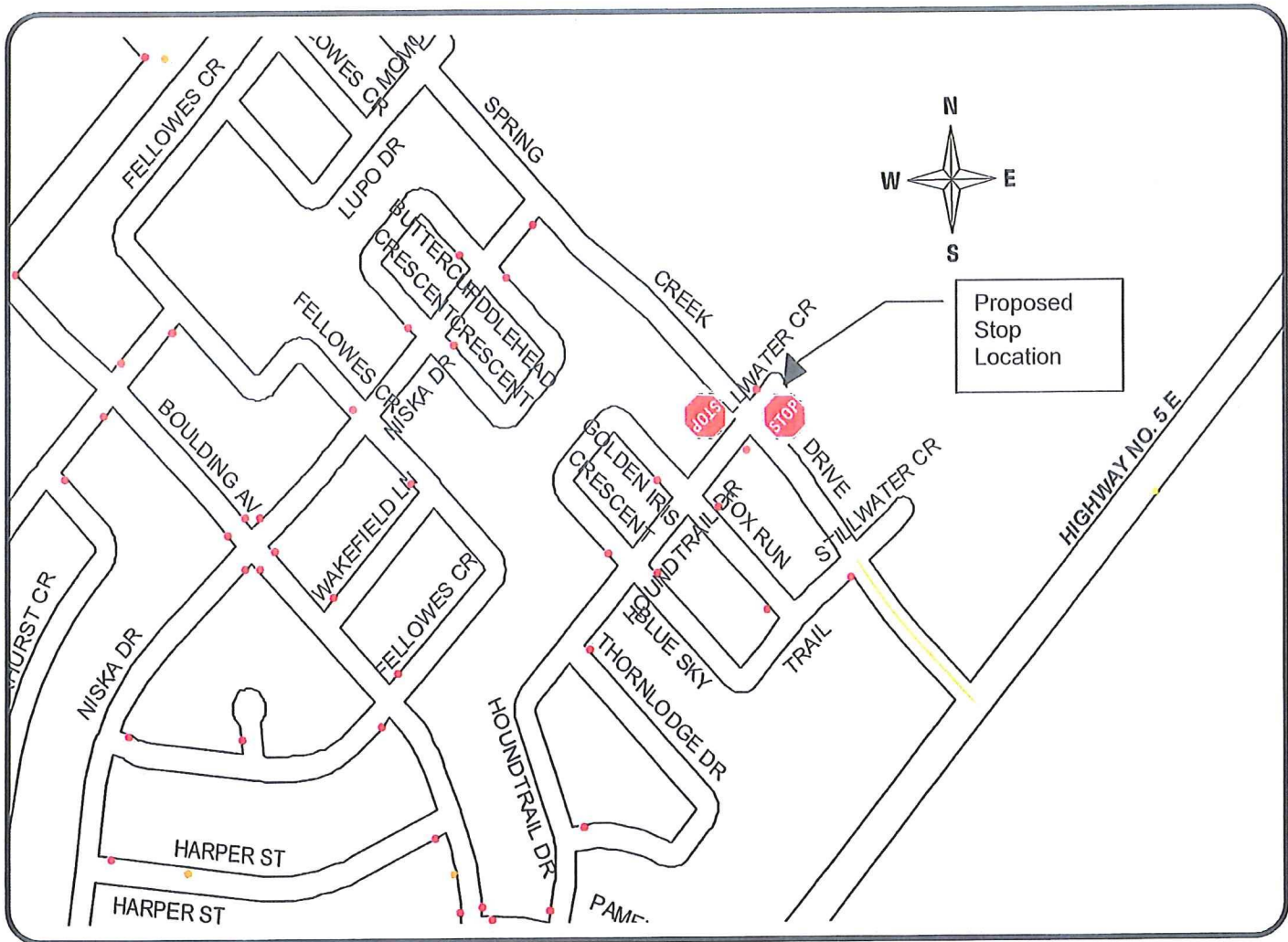

KEY MAP

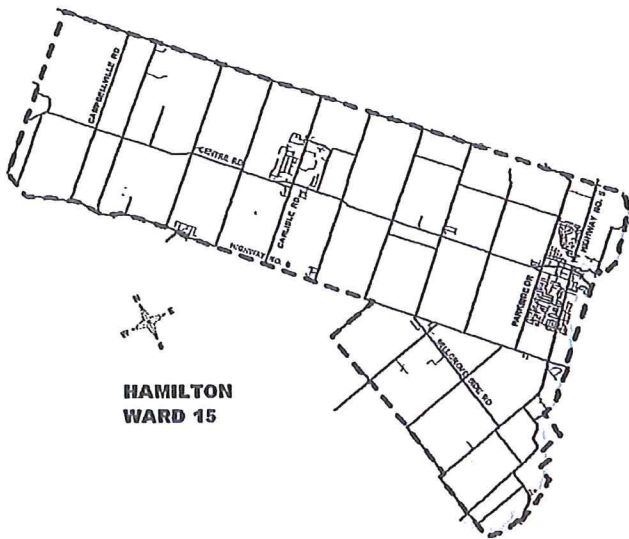

**HAMILTON
WARD 15**

LOCATION PLAN

PROPOSED STOP CONTROL:

Spring Creek Drive at Houndtrail
Drive/Stillwater Crescent

Corporate Assets & Strategic Planning
PUBLIC WORKS DEPARTMENT

LEGEND

- EXISTING STOP
- ⬢ STOP PROPOSED STOP

SCALE
NOT TO SCALE

DATE
August 11, 2016

62M – 1222 “Hiscott Drive, Hugill Way and Savage Drive”

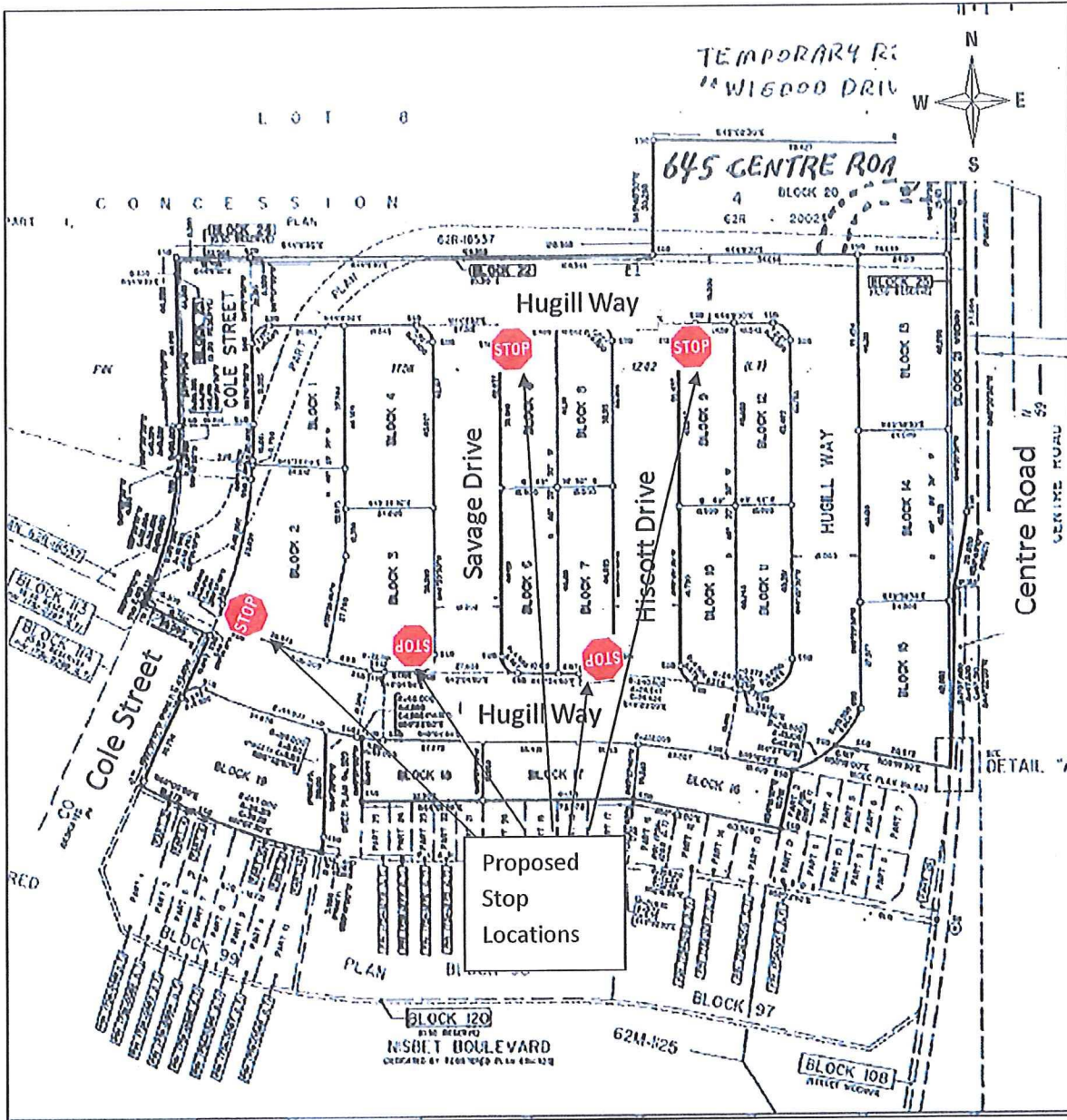

LEGEND	
	EXISTING STOP
	PROPOSED STOP

PW Date: August 11, 2016

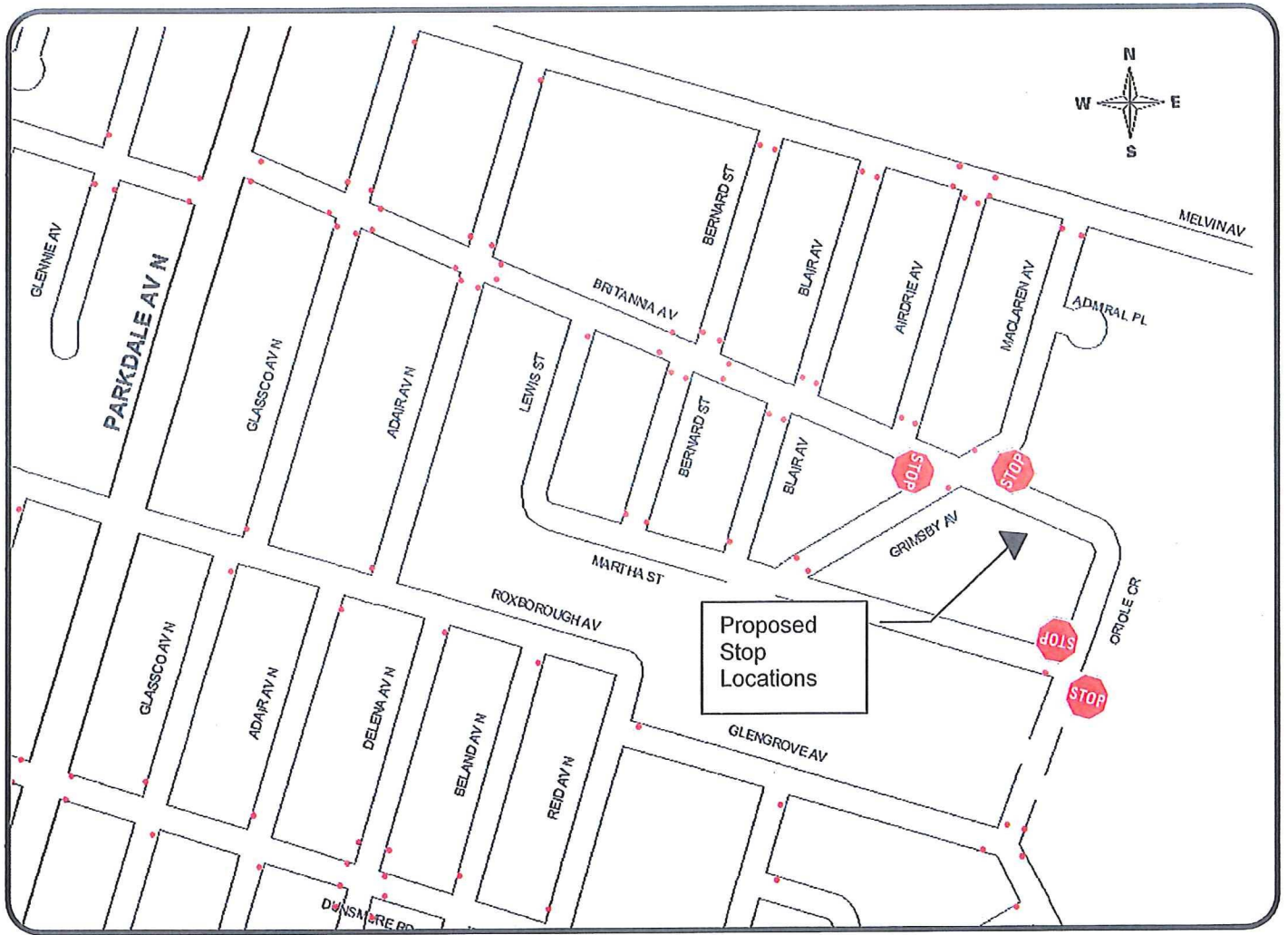

KEY MAP

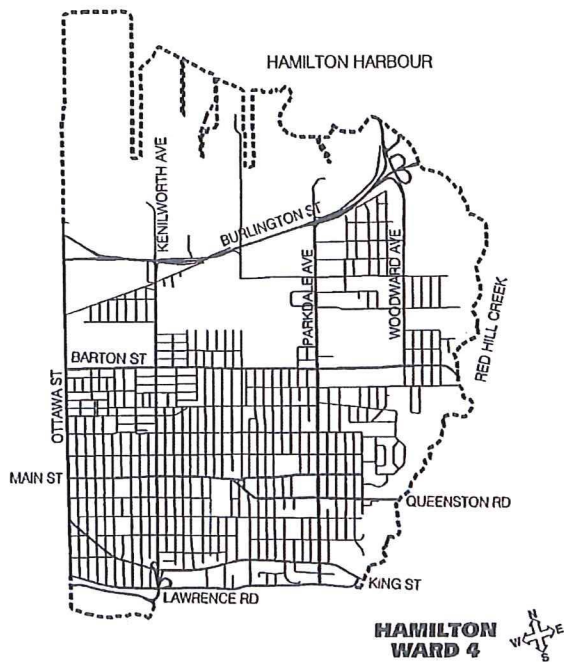

LOCATION PLAN

PROPOSED STOP CONTROL:
 Britannia Avenue at Grimsby Avenue/
 Maclaren Avenue
 &
 Oriole Crescent at Martha Street

Corporate Assets & Strategic Planning
 PUBLIC WORKS DEPARTMENT

LEGEND

- EXISTING STOP
- ⬮ PROPOSED STOP

SCALE
 NOT TO SCALE

DATE
 August 11, 2016

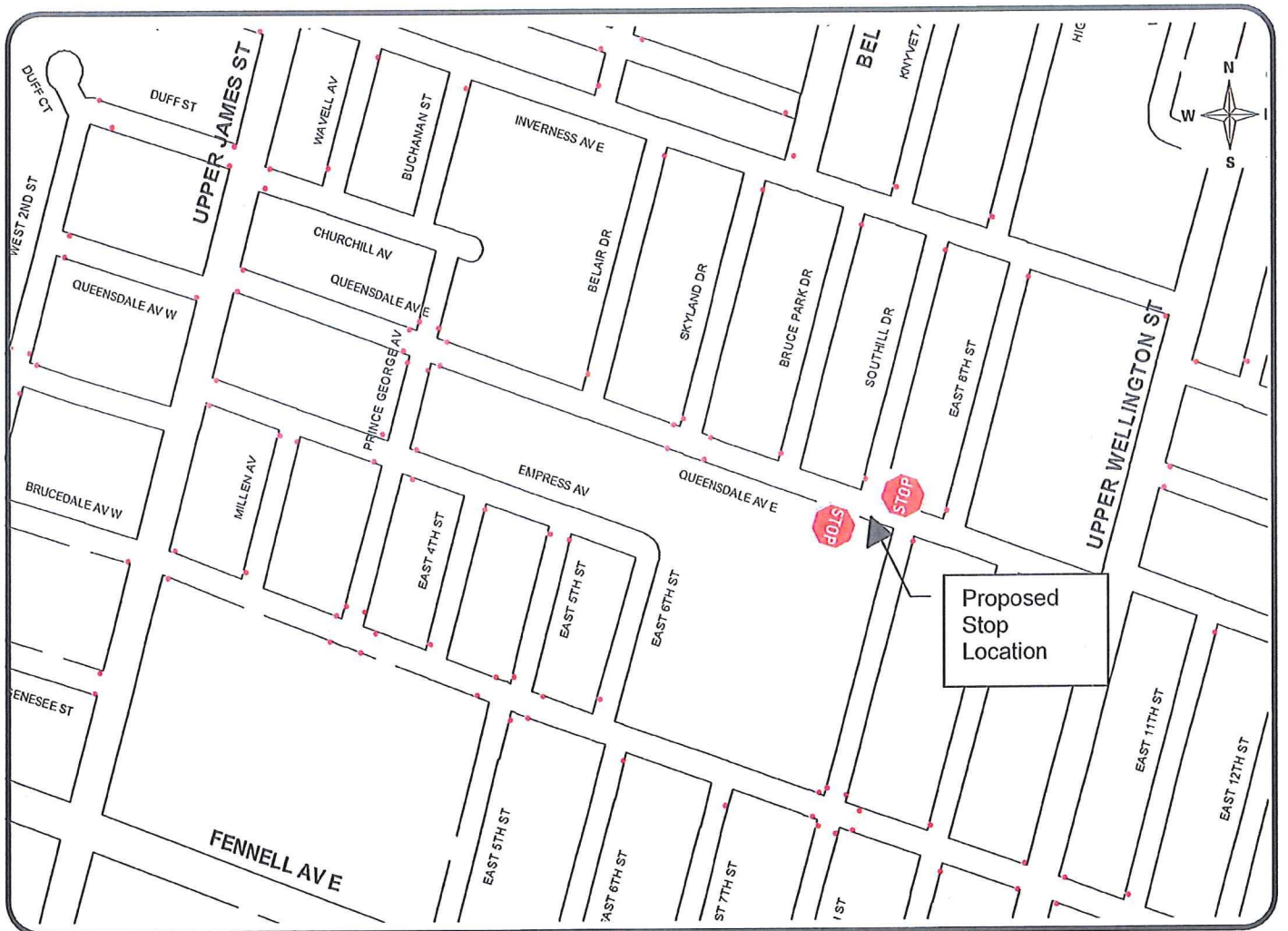

KEY MAP

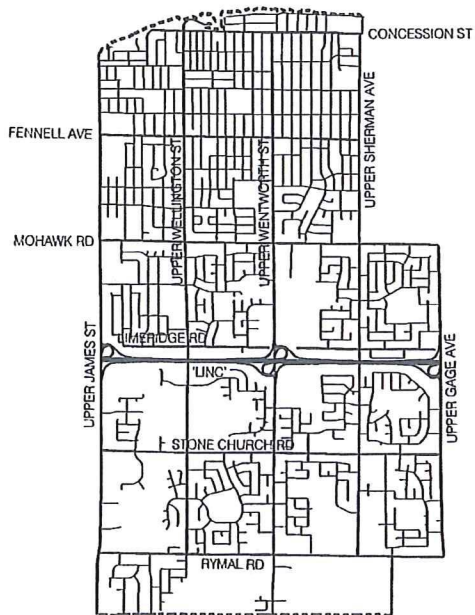

HAMILTON WARD 7

LOCATION PLAN

PROPOSED STOP CONTROL:

Queensdale Avenue at Southhill Drive

Corporate Assets & Strategic Planning
PUBLIC WORKS DEPARTMENT

LEGEND

- EXISTING STOP
- ⬮ PROPOSED STOP

SCALE
NOT TO SCALE

DATE
August 11, 2016

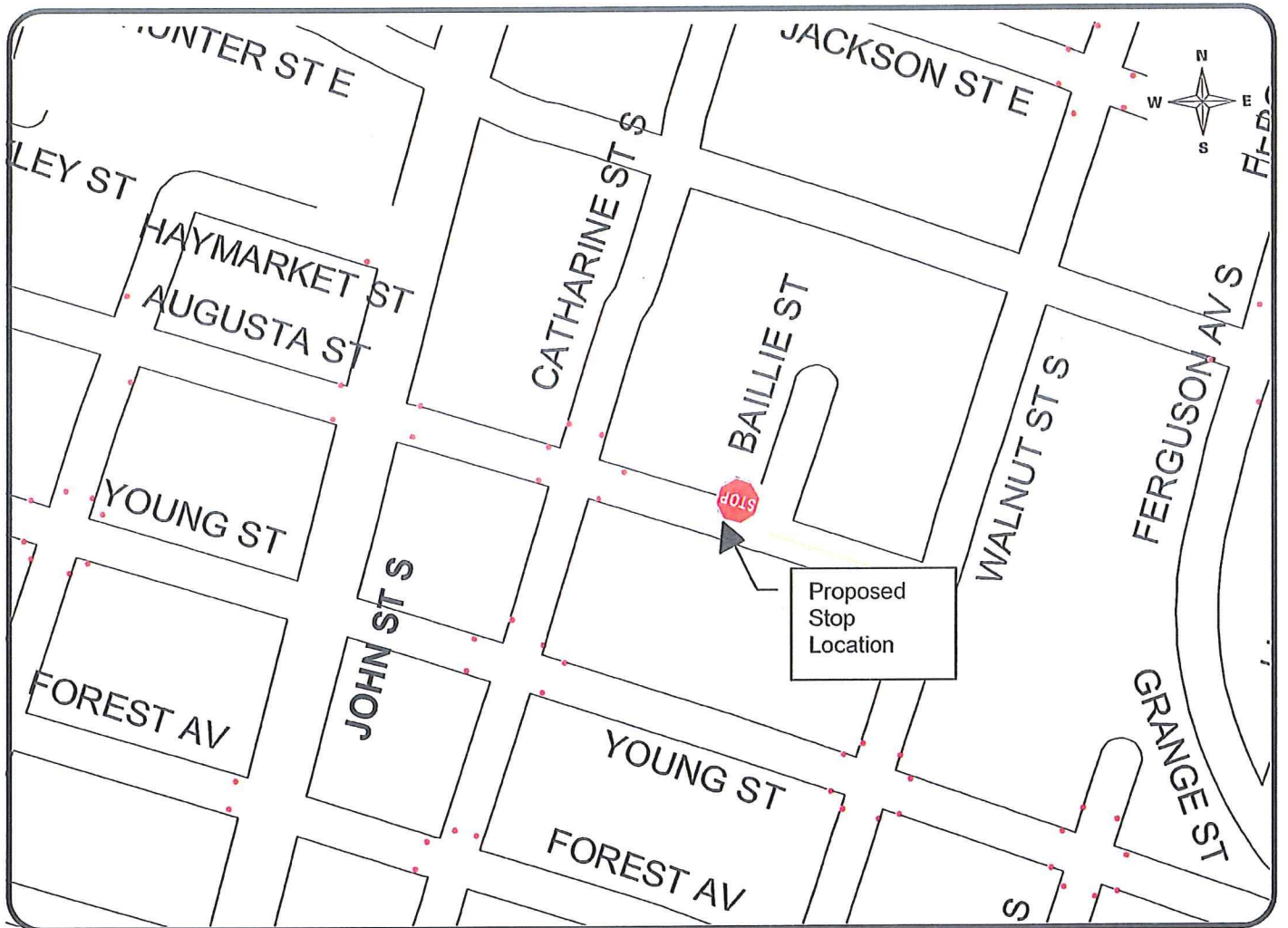

KEY MAP

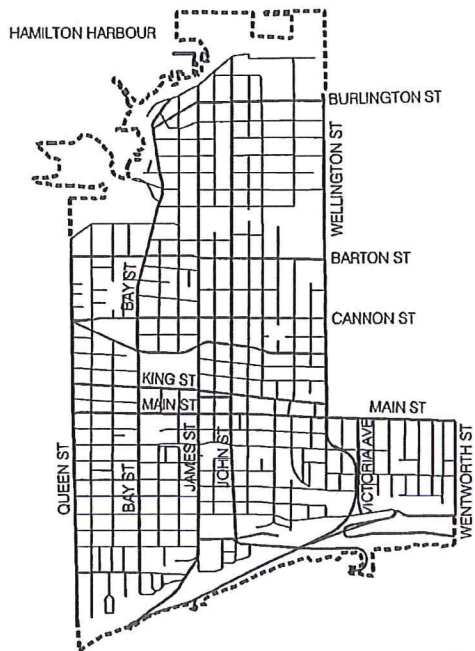

**HAMILTON
WARD 2**

LOCATION PLAN

PROPOSED STOP CONTROL:

Baillie Street at Augusta Street

Corporate Assets & Strategic Planning
PUBLIC WORKS DEPARTMENT

LEGEND

- EXISTING STOP
- PROPOSED STOP

SCALE
NOT TO SCALE

DATE
August 11, 2016

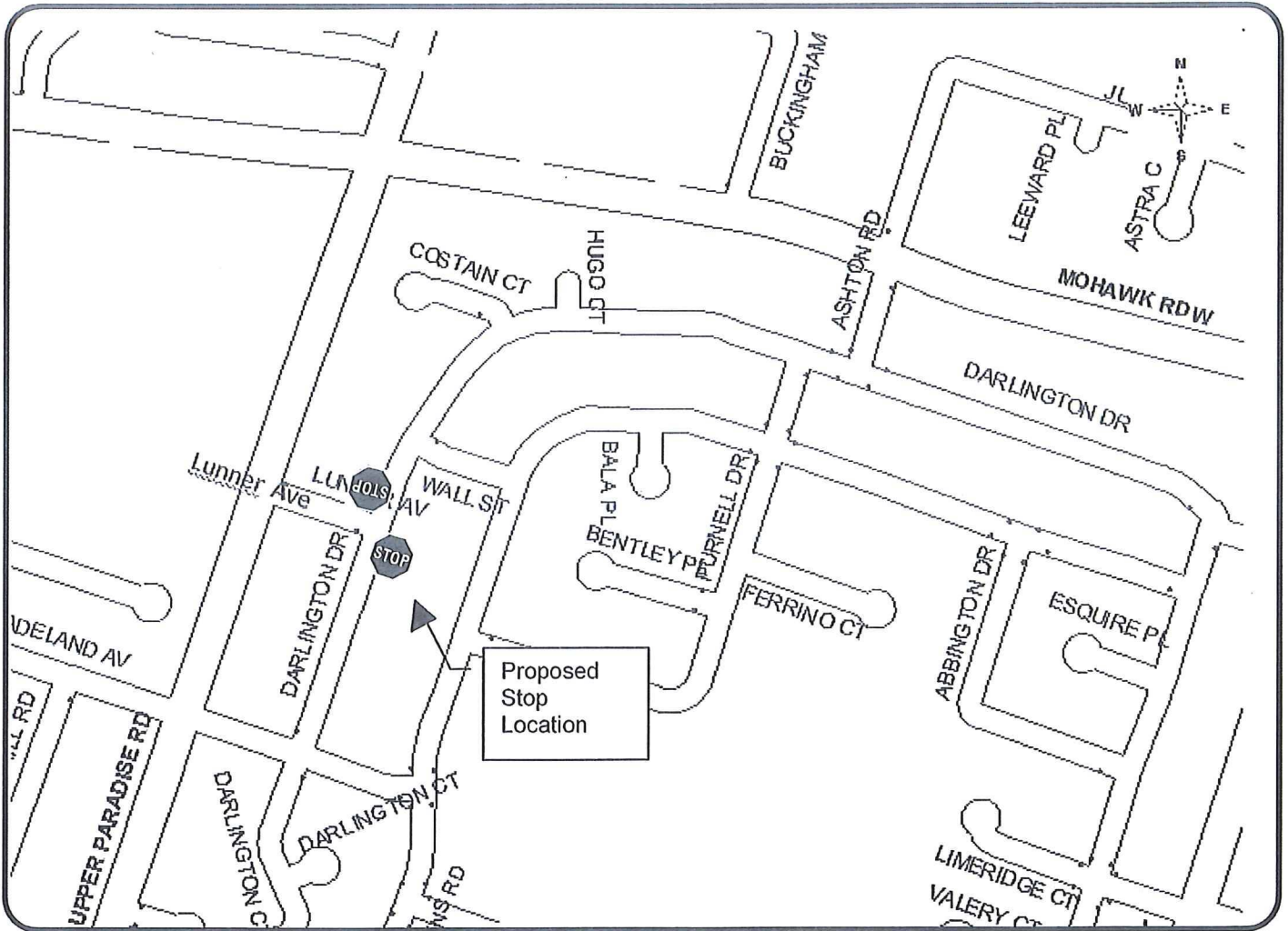

KEY MAP

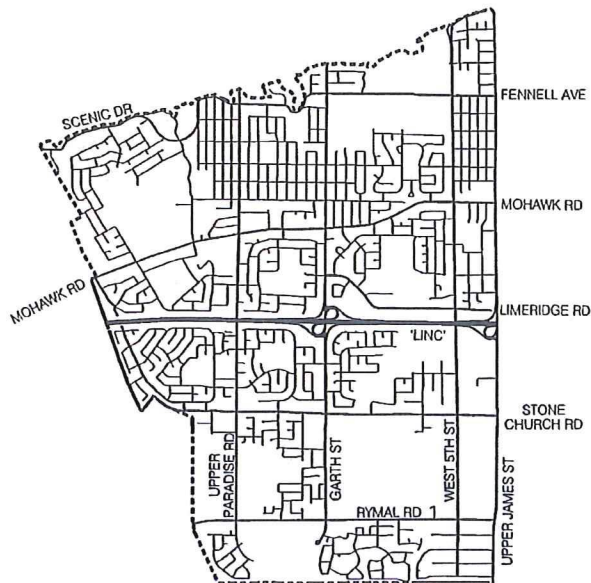

**HAMILTON
WARD 8**



LOCATION PLAN

PROPOSED STOP CONTROL:

Darlington Drive at Lunner Avenue

Corporate Assets & Strategic Planning
PUBLIC WORKS DEPARTMENT

LEGEND

● EXISTING STOP

⬮ PROPOSED STOP

SCALE
NOT TO SCALE

DATE
August 11, 2016

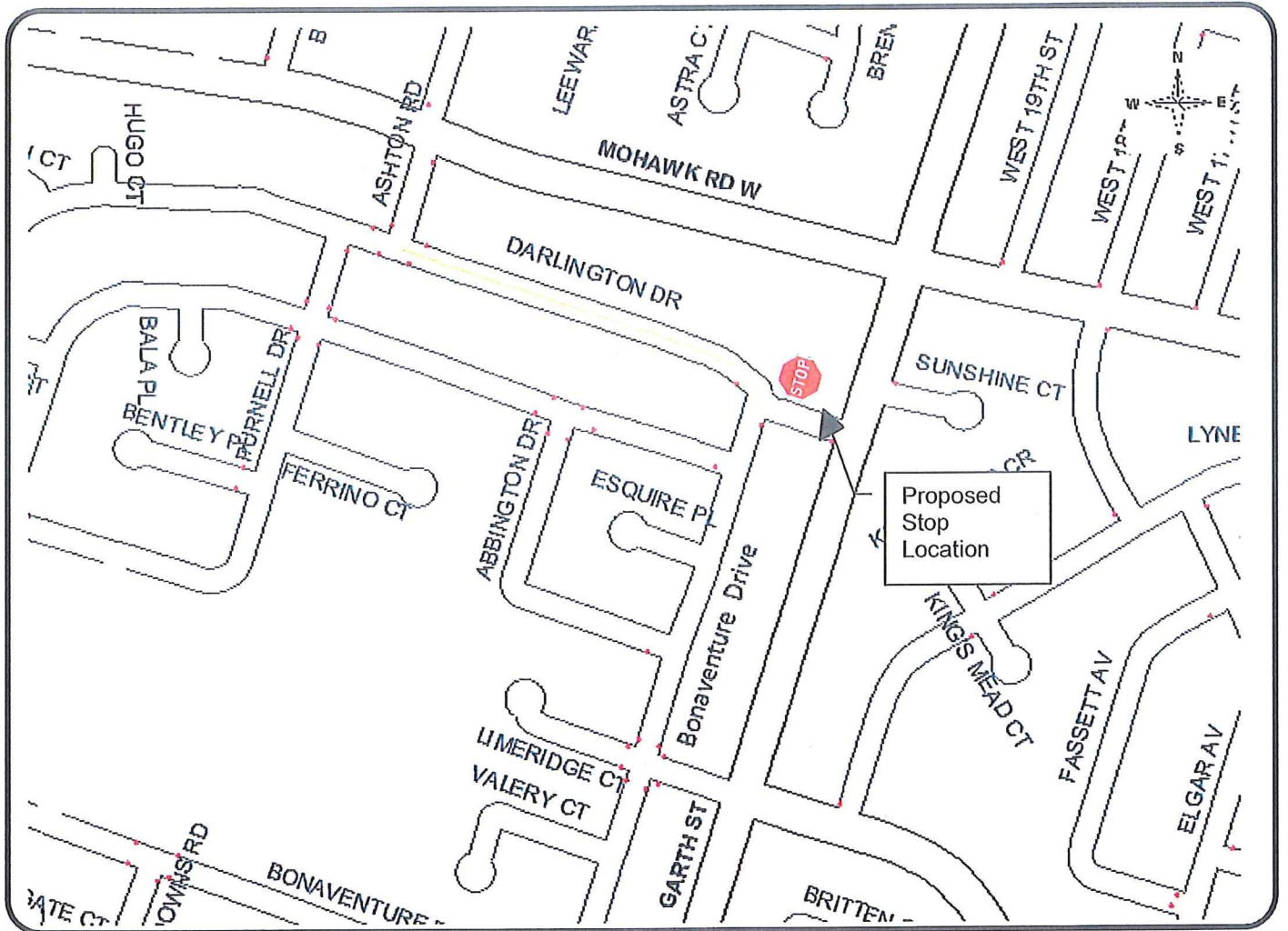

KEY MAP

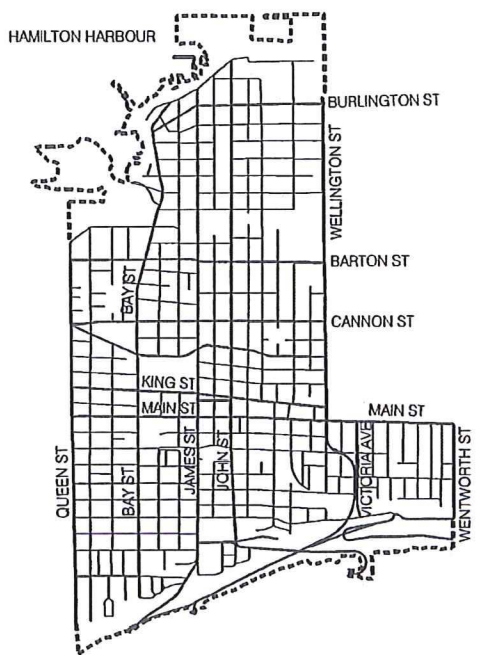

HAMILTON WARD 2



LOCATION PLAN

PROPOSED STOP CONTROL:

Darlington Drive at Bonaventure Drive

Corporate Assets & Strategic Planning
PUBLIC WORKS DEPARTMENT

LEGEND

● EXISTING STOP

● STOP PROPOSED STOP

SCALE
NOT TO SCALE

DATE
August 11, 2016



KEY MAP

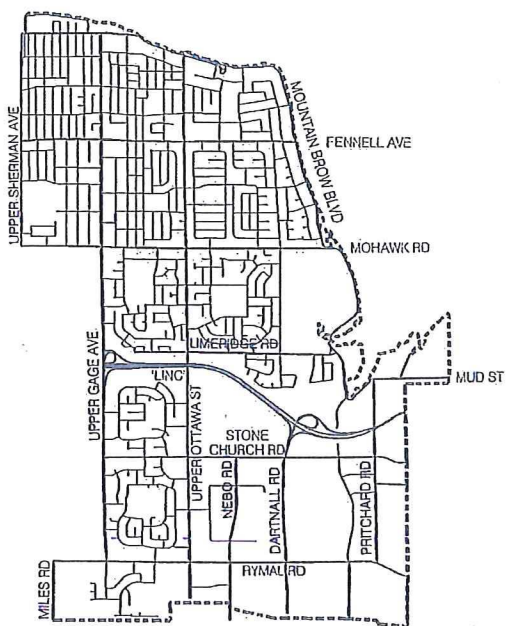

HAMILTON WARD 6

LOCATION PLAN

PROPOSED STOP CONTROL:

Kerr Street At East 44th Street

Corporate Assets & Strategic Planning
PUBLIC WORKS DEPARTMENT

LEGEND

- EXISTING STOP
- STOP PROPOSED STOP

SCALE
NOT TO SCALE

DATE
August 11, 2016

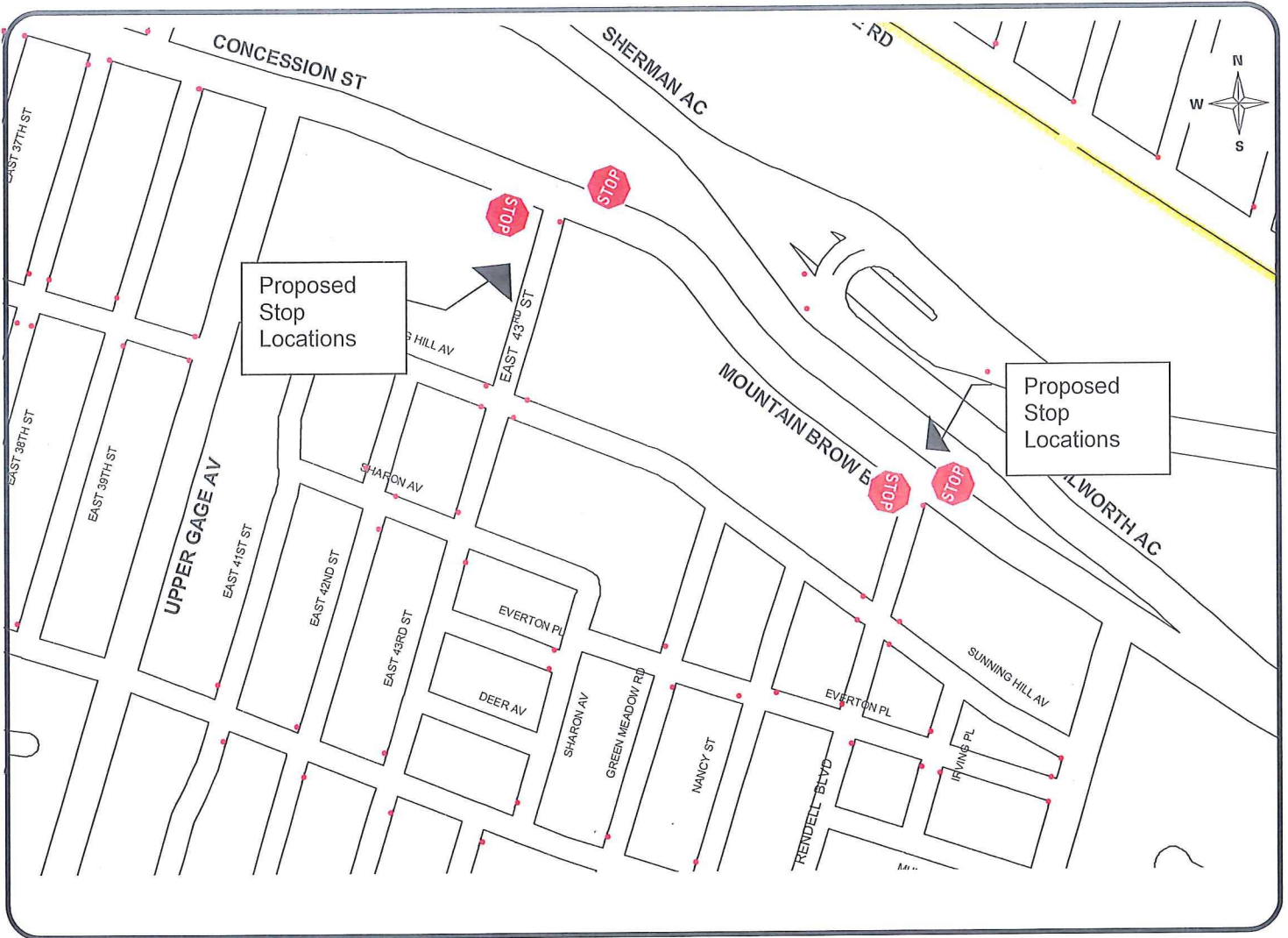

KEY MAP

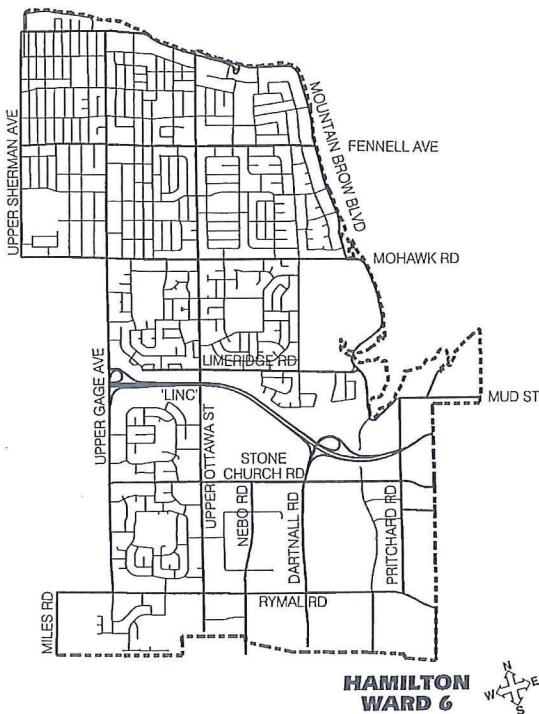

LOCATION PLAN

PROPOSED STOP CONTROL:

Mountain Brow Boulevard At Rendell Boulevard
 Concession Street At East 43rd Street

Corporate Assets & Strategic Planning
 PUBLIC WORKS DEPARTMENT

LEGEND

- EXISTING STOP
- PROPOSED STOP

SCALE
 NOT TO SCALE

DATE
 August 11, 2016

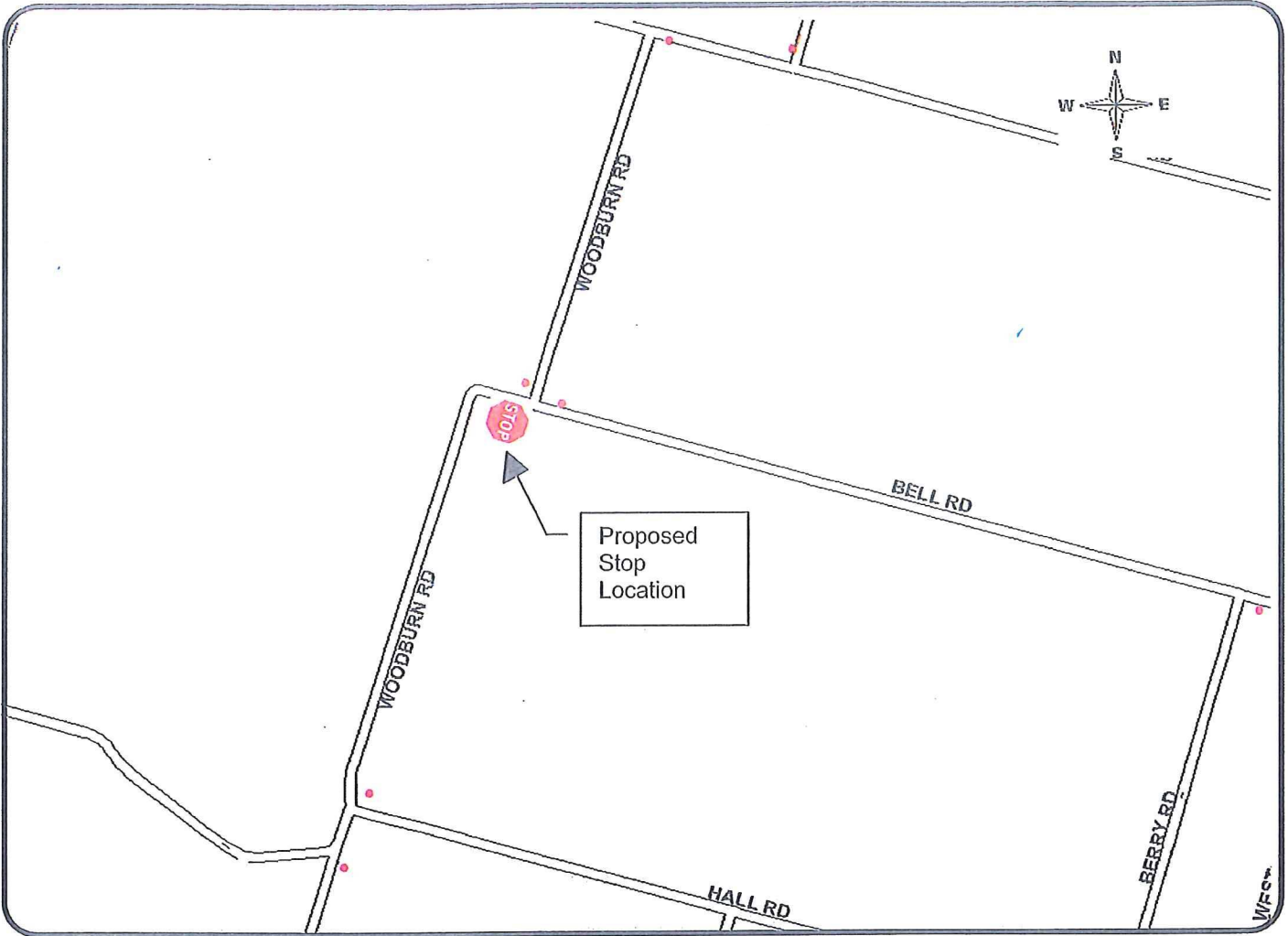

KEY MAP

**HAMILTON
WARD 11**

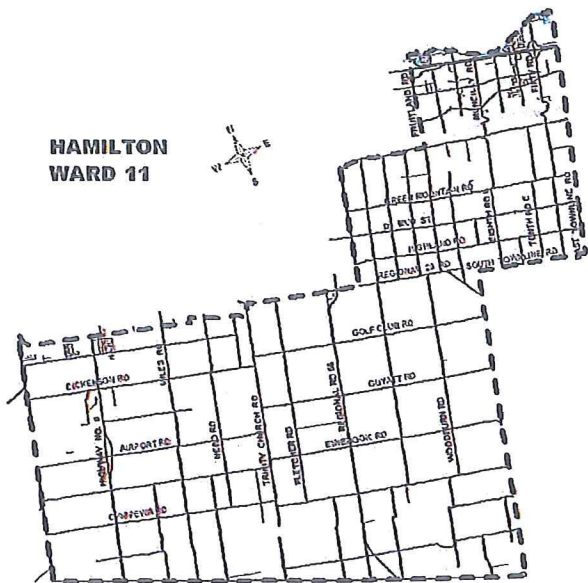

LOCATION PLAN

PROPOSED STOP CONTROL:

Bell Road at Woodburn Road

Corporate Assets & Strategic Planning
PUBLIC WORKS DEPARTMENT

LEGEND

- EXISTING STOP
- PROPOSED STOP

SCALE
NOT TO SCALE

DATE
August 11, 2016

