

Authority: Item 6, Planning Committee
Report: 17-019 (PED17194)
CM: November 22, 2017

Bill No. 256

CITY OF HAMILTON

BY-LAW NO. 17-

To Adopt:

**Official Plan Amendment No. 14 to the
Rural Hamilton Official Plan**

Respecting:

**582, 626, 632, 634 and 638 Brock Road, 790, 798, 822, 826 and 832 Concession 4
West, and 520, 526, 532, 536, 540, 542, 546, 550, 554, 559, 564, 565, 568, 580 and
588 Moxley Road
(Flamborough)**

NOW THEREFORE the Council of the City of Hamilton enacts as follows:

1. Amendment No. 14 to the Rural Hamilton Official Plan consisting of Schedule “1”, hereto annexed and forming part of this by-law, is hereby adopted.

PASSED this 22nd day of November, 2017.

F. Eisenberger
Mayor

R. Caterini
City Clerk

**Rural Hamilton Official Plan
Amendment No. 14**

The following text, together with:

Appendix "A" – Volume 1, Schedule D – Rural Land Use Designations

Appendix "B" – Volume 3, Appendix A – Site Specific Key Map

attached hereto, constitutes Official Plan Amendment 14 to the Rural Hamilton Official Plan.

1.0 Purpose and Effect:

The purpose and effect of this Amendment is to change the land use designation on Schedule "D", and to create a new site specific policy, to permit the extension of the Lafarge Dundas South Quarry.

2.0 Location:

The lands affected by this Amendment are known municipally as located at the south east corner of Concession 4 West and Brock Road, and known municipally as 582, 626, 632, 634 and 638 Brock Road, 790, 798, 822, 826 and 832 Concession 4 West, and 520, 526, 532, 536, 540, 542, 546, 550, 554, 559, 564, 565, 568, 580 and 588 Moxley Road, in the former Town of Flamborough.

3.0 Basis:

The amendment allows for the subject lands to be utilized for mineral aggregate extraction as an extension to the existing Lafarge Dundas South Quarry. The basis for permitting this amendment is as follows:

- The proposal has undergone a thorough technical review by the Combined Aggregate Review Team, comprising City staff, outside agencies, and peer reviewers.

Rural Hamilton Official Plan Amendment No. 14	Page 1 of 4	 Hamilton
--	----------------	---

- The proposal includes appropriate provisions to ensure protection of the natural environment and to minimize impacts to surrounding residents.
- The Provincial Policy Statement and Greenbelt Plan do not allow lands to be removed from a Prime Agriculture designation. Therefore, the lands west of Moxley Road will remain in the Agriculture designation with a site specific policy added to permit mineral aggregate extraction. The lands east of Moxley Road will be redesignated from Rural to Mineral Aggregate Resource Extraction.
- The proposal is consistent with the Provincial Policy Statement, 2014 and conforms to the Greenbelt Plan, 2017.

4.0 **Actual Changes:**

4.1 **Volume 1 – Parent Plan**

Schedules and Appendices

4.1.1 Appendices

- a) That Volume 1: Schedule D, be amended by re-designating a portion of the lands, known municipally as 520, 526, 532, 536, 540, 542, 546, 550, 554, 564, 568, 580, and 588 Moxley Road, from Rural to Mineral Aggregate Resource Extraction Area, as shown on Appendix "A" to this amendment.

4.2 **Volume 3 – Special Policy and Site Specific Areas**

Text Changes

4.2.1 Chapter B – Rural Site Specific Areas

- a) That Volume 3 – Chapter B - Rural Site Specific Areas be amended by adding a new site specific policy to a portion of the lands, as follows:

Rural Hamilton Official Plan Amendment No. 14	Page 2 of 4	 Hamilton
--	----------------	---

"R-36 Lands known municipally as 559 and 565 Moxley Road, 790, 798, 822, 826, and 832 Concession 4 West, and 582, 626, 632, 634 and 638 Brock Road, former Township of Flamborough

- 1.0 In addition to the uses permitted in Volume 1, Section D.2.0 – Agriculture Designation, the lands known municipally as 559 and 565 Moxley Road, 790, 798, 822, 826 and 832 Concession 4 West, and 582, 626, 632, 634 and 638 Brock Road and identified as Site Specific Policy R-36, designated Agriculture on Schedule "D", may also be used for the extraction of mineral aggregate resources and related accessory uses in accordance with Section D.6.4, and a license issued under the *Aggregate Resources Act*."

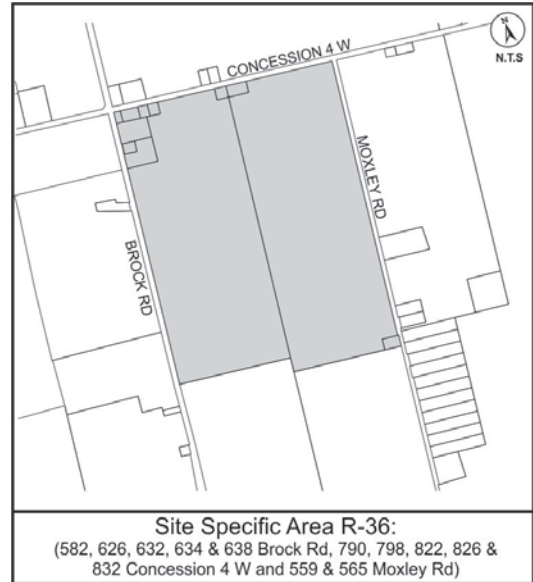

Schedules and Appendices

4.2.2 Appendices

- a) That Volume 3: Appendix A – Site Specific Key Map, be amended by identifying a portion of the lands, known municipally as 559 and 565 Moxley Road, 790, 798, 822, 826 and 832 Concession 4 West, and 582, 626, 632, 634 and 638 Brock Road, as Site Specific Policy Area R-36, as shown on Appendix "B" to this amendment.

5.0 Implementation:

An implementing Zoning By-Law Amendment will give effect to the intended uses on the subject lands.

This Official Plan Amendment is Schedule "1" to By-law No. 17-256 passed on the 22nd day of November, 2017.

**The
City of Hamilton**

F. Eisenberger
MAYOR

R. Caterini
CITY CLERK

--

Appendix A
APPROVED Amendment No. 14
to the Rural Hamilton Official Plan

 Lands to be redesignated from "Rural" to
"Mineral Aggregate Resource Extraction Areas"
(520, 526, 532, 536, 540, 542, 546, 550, 554, 564, 568, 580
and 588 Moxley Rd)

Date:
Nov. 15, 2017

Revised By:
HT/NB



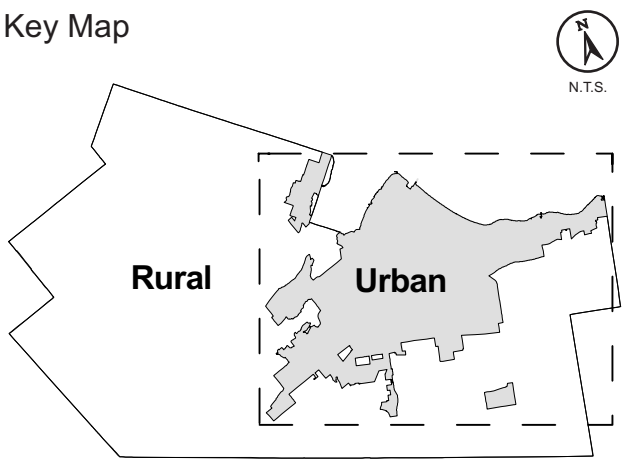

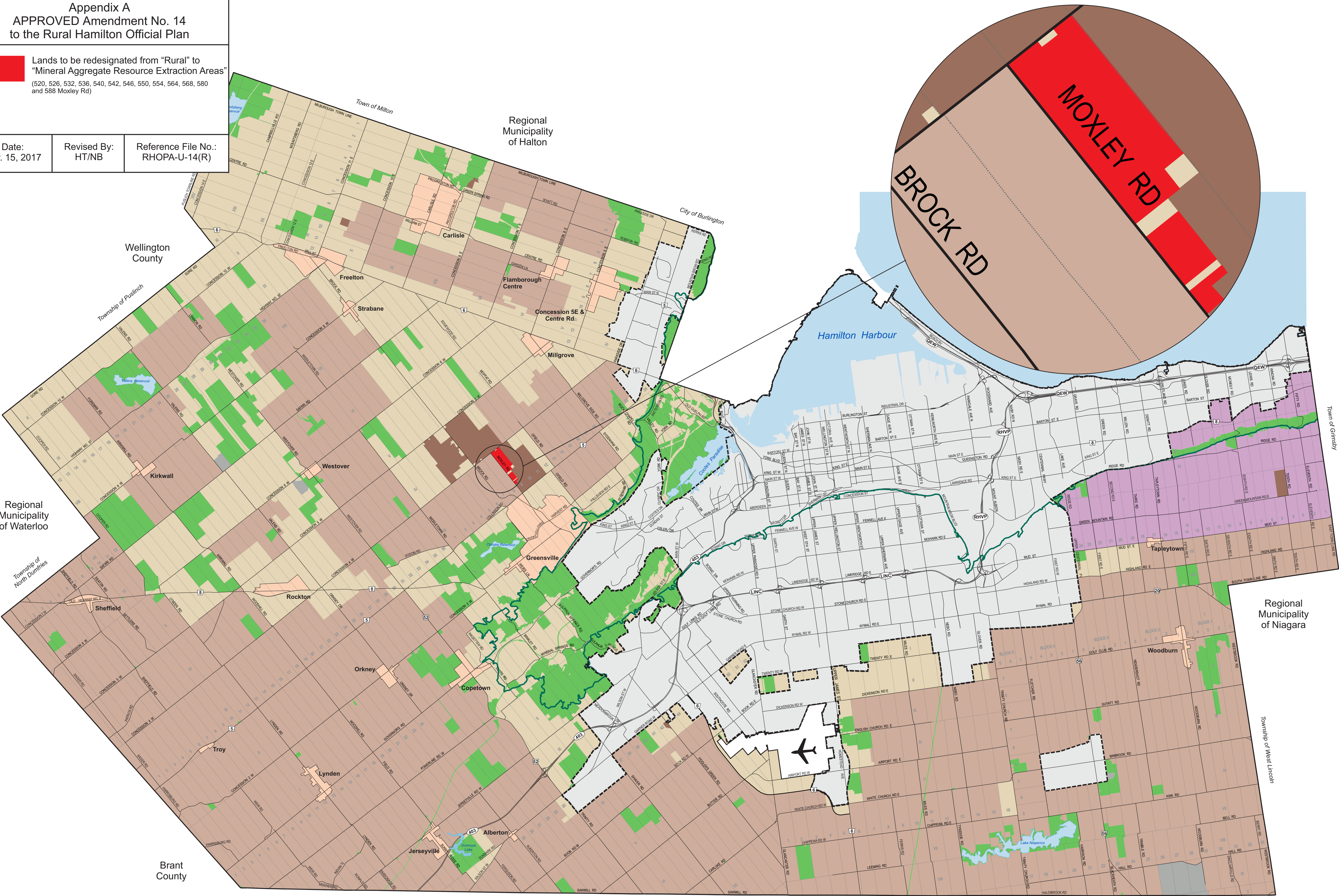

Reference File No.:
RHOPA-U-14(R)







Note: For Urban Land Use Designations, refer
to Schedule E-1 of the Urban Hamilton
Official Plan.



Legend

-  Rural Settlement Areas
- Rural Land Use Designations**
-  Agriculture
 -  Specialty Crop
 -  Rural
 -  Mineral Aggregate Resource Extraction Areas
 -  Open Space
 -  Utility

Other Features

-  Urban Area
-  John C. Munro Hamilton International Airport
-  Niagara Escarpment
-  Urban Boundary
-  Municipal Boundary

Council Adoption: September 27, 2006
Ministerial Approval: December 24, 2008
Effective Date: March 7, 2012

Rural Hamilton Official Plan
Schedule D
Rural Land Use Designations

Appendix B
APPROVED Amendment No. 14
to the Rural Hamilton Official Plan

 Lands to be identified as
Site Specific Area R-36

(582, 626, 632, 634 & 638 Brock Rd, 790, 798, 822, 826
& 832 Concession 4 W and 559 and 565 Moxley Rd)

Date:
Nov. 15, 2017

Revised By:
HT/NB

Reference File No.:
RHOPA-14(F)

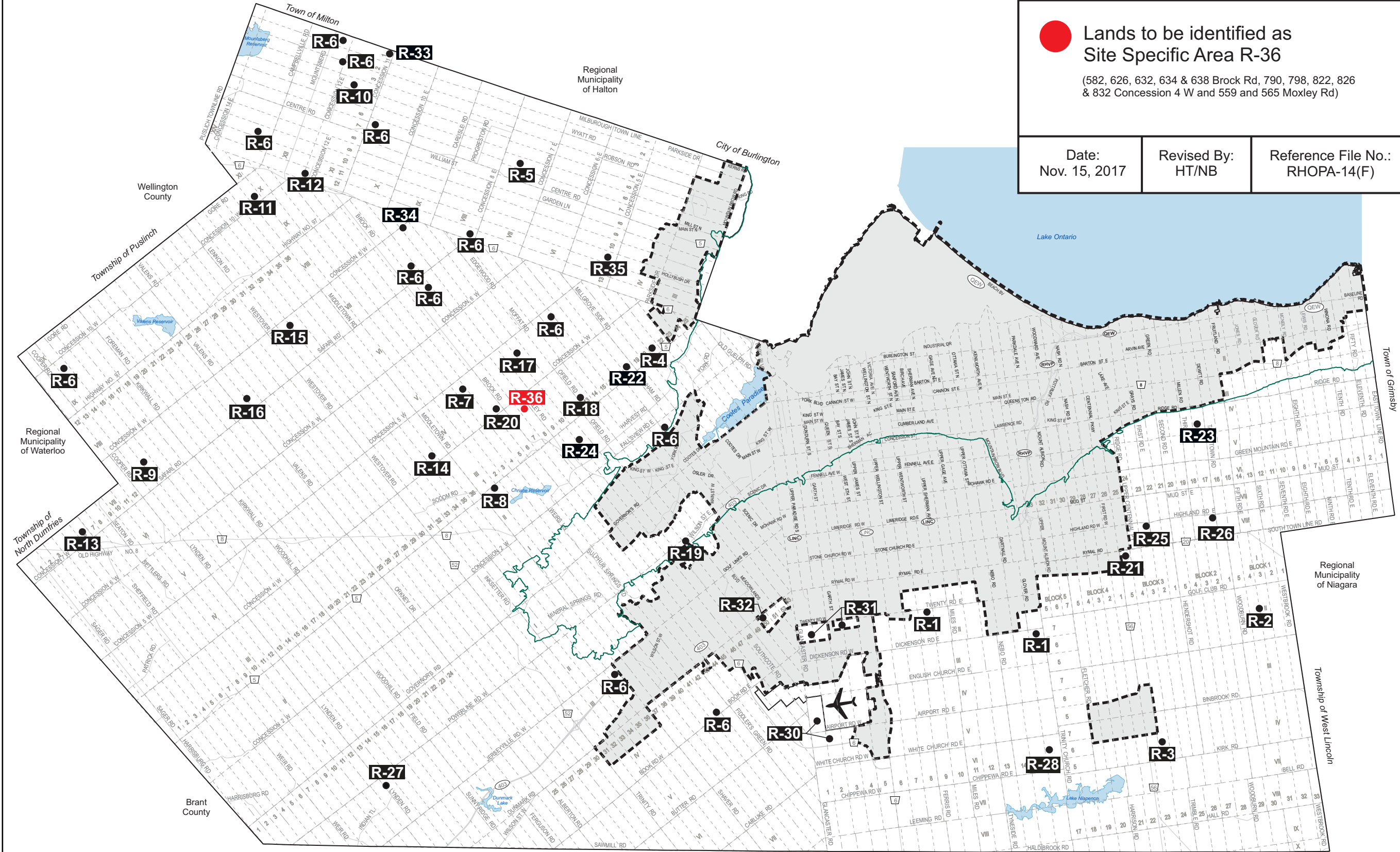

Legend

- Site Specific Areas (SSA)
- R-** Refers to Rural Site Specific Area #, Volume 3, Chapter B
- Other Features**
 - Urban Area
 - John C. Munro Hamilton International Airport
 - Niagara Escarpment
 - Urban Boundary
 - Municipal Boundary

Council Adoption: September 27, 2006
Ministerial Approval: December 24, 2008
Effective Date: March 7, 2012

Rural Hamilton Official Plan
Volume 3: Appendix A
Site Specific Key Map

Not To Scale

Date: Feb. 28, 2017

PLANNING & ECONOMIC DEVELOPMENT DEPARTMENT

© Teramet Land Information Services Inc. and its licensors. [2009]
May Not be Reproduced without Permission. THIS IS NOT A PLAN
OF SURVEY