

Rural Mapping Amendments

The following properties were identified as having incorrect Conservation / Hazard Land Rural (P6), (P7) and / or (P8) Zone boundaries. They were brought to staff's attention through various means, including Site Plan Control applications, Minor Variance applications, and general inquiries. Staff reviewed Environmental Impact Statements (EIS), Conservation Authority regulated areas, Provincial mapping, and municipal aerial photos to determine the correct zone boundary locations. In some cases, only certain zone boundaries were amended for each property; in other cases, the entire zone was amended. See also Schedules "B1", "B2", "B3", "B4", "B5", "B6", "B7", "B8", "B9", "B10", "B11" and "B12" to Appendix "A".

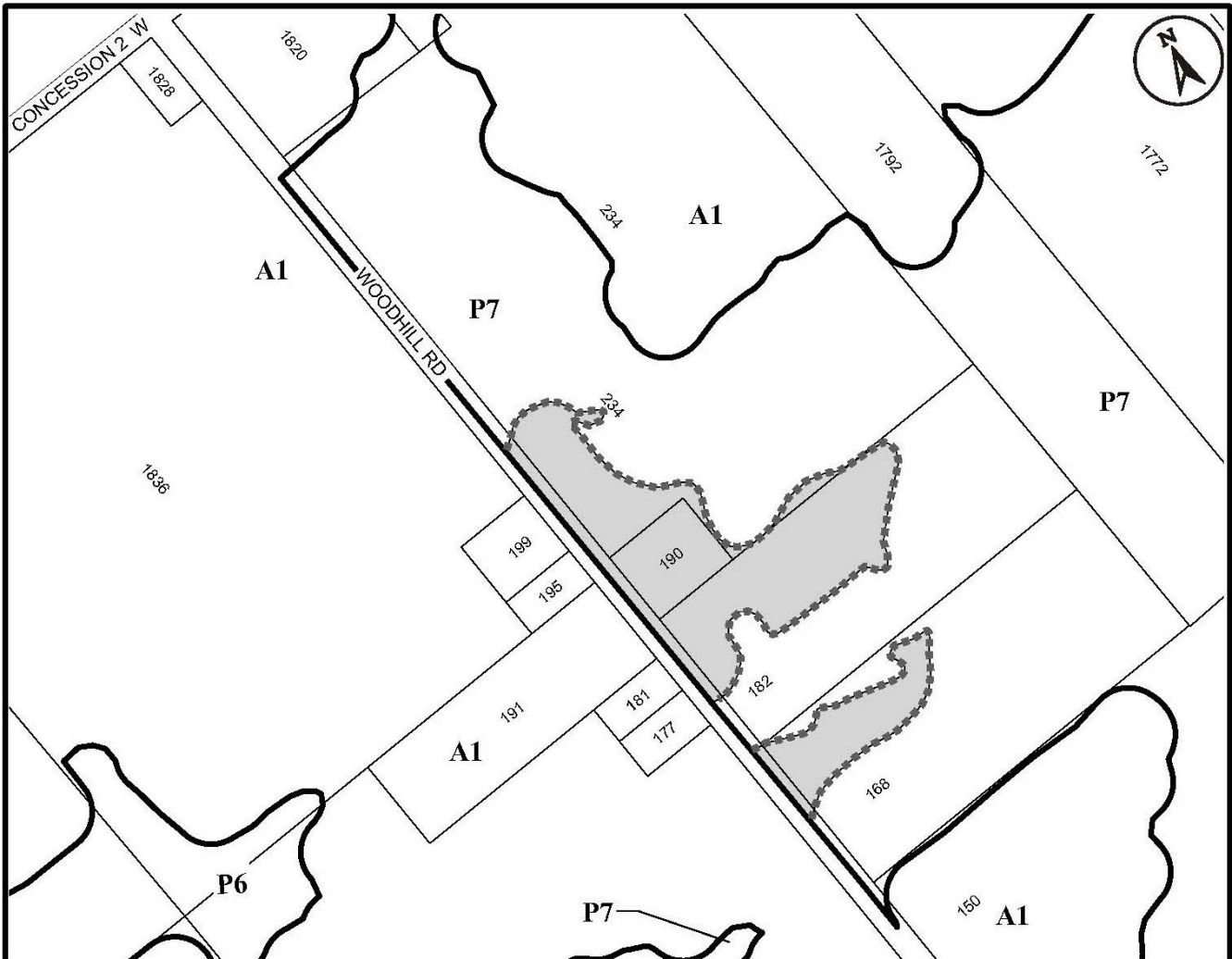

● Site Location

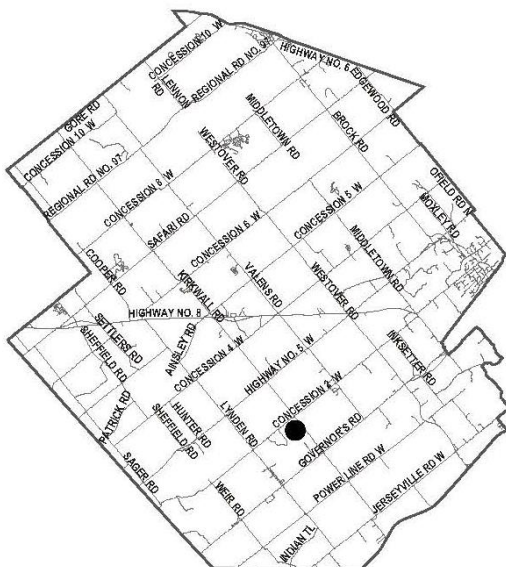

Key Map - Ward 14

N.T.S.

Location Map



PLANNING AND ECONOMIC DEVELOPMENT DEPARTMENT

File Name/Number:
 168, 182, 190 & 234 Woodhill Rd

Date:
 August 11, 2017

Appendix "A"

Scale:
 N.T.S.

Planner/Technician:
 MG/NB

Subject Property

168, 182, 190 and 234 Woodhill Road, Flamborough

- Change in Zoning from Conservation/Hazard Land (P7) to Agriculture (A1) Zone
- Proposed Zoning Boundary Adjustment
- Existing Zoning Boundary



● Site Location

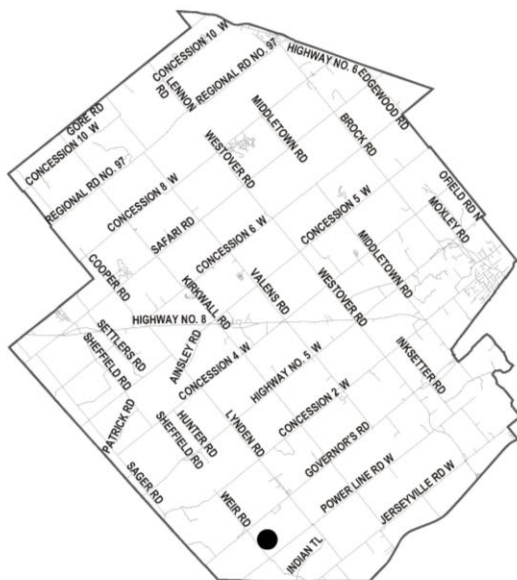

Key Map - Ward 14

N.T.S.



Location Map



PLANNING AND ECONOMIC DEVELOPMENT DEPARTMENT

File Name/Number:
767, 831 and 893 Weir Rd.

Date:
April 24, 2018





Appendix "A"

Scale:
N.T.S.

Planner/Technician:
MG/AL

Subject Property

767, 831 and 893 Weir Road, Ancaster

-  Change in Zoning from Conservation/Hazard Land (P7) Zone to Agriculture (A1) Zone
-  Change in Zoning from Agriculture (A1) Zone to Conservation/Hazard Land (P7) Zone
-  Proposed Zoning Boundary Adjustment
-  Existing Zoning Boundary

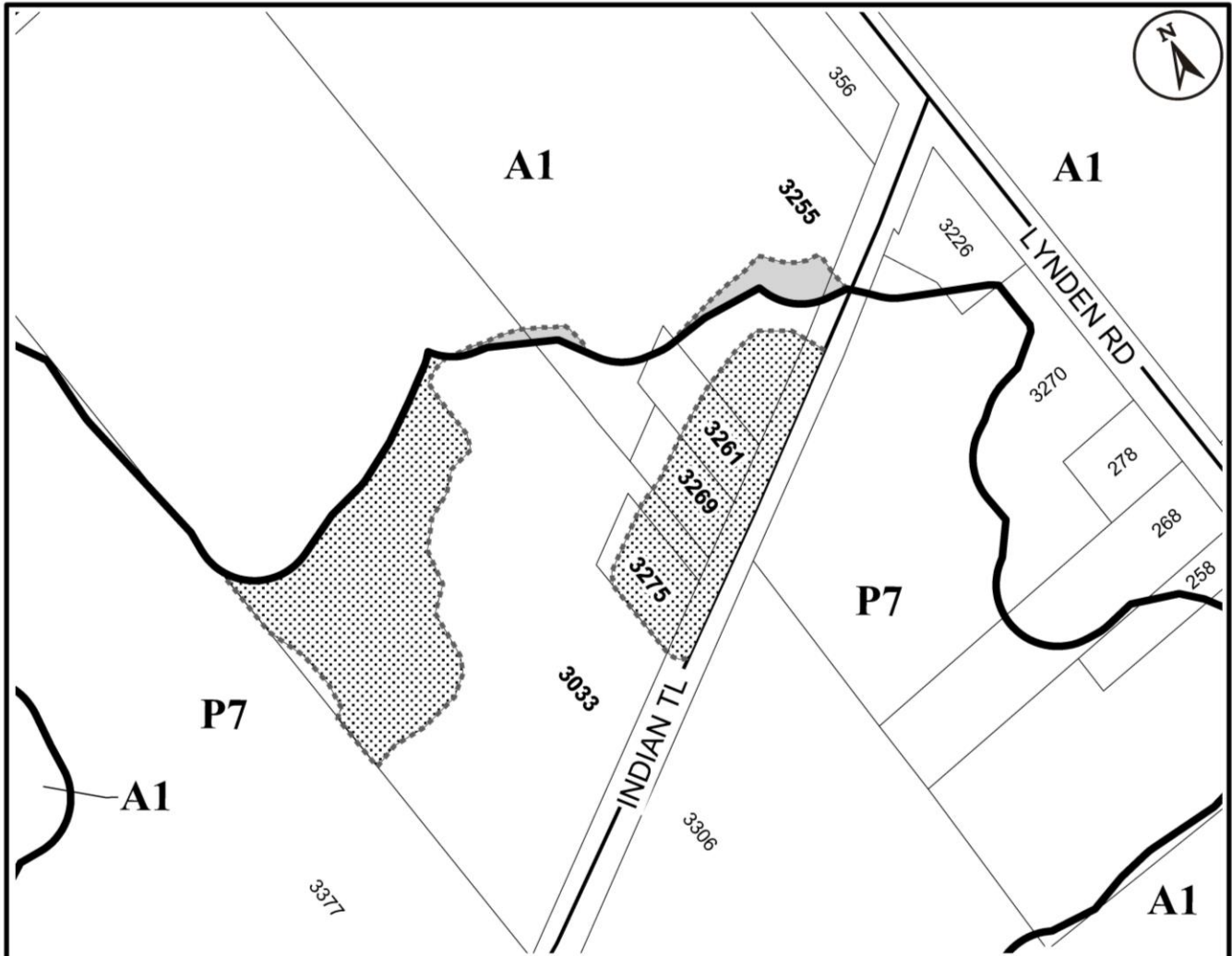

● Site Location



Key Map - Ward 14

N.T.S.



Location Map



Hamilton

PLANNING AND ECONOMIC DEVELOPMENT DEPARTMENT

File Name/Number:

3303, 3275, 3269, 3261 & 3255 Indian Trail

Date:

March 1, 2018

Appendix "A"

Scale:
N.T.S.

Planner/Technician:
MG/NB

Subject Property

3255, 3261, 3269, 3275 & 3303 Indian Trail, Ancaster

 Change in Zoning from Conservation/Hazard Land (P7) Zone to Agriculture (A1) Zone

 Change in Zoning from Agriculture (A1) Zone to Conservation/Hazard Land (P7) Zone

 Proposed Zoning Boundary Adjustment

 Existing Zoning Boundary



● Site Location



Key Map - Ward 11

N.T.S.



Location Map



Hamilton

PLANNING AND ECONOMIC DEVELOPMENT DEPARTMENT

File Name/Number:
3065 Tisdale Rd

Date:
May 31, 2018

Appendix "A"

Scale:
N.T.S.

Planner/Technician:
MG/AL

Subject Property

3065, 3295, 3311, 3323, 3335, 3341, 3349, 3359, 3369, 3379, 3383, 3385, 3395, 3403, 3409 Tisdale Road & 5050, 5056, 5084, 5126, 5134, 5144, 5150, 5156, 5164 Chippewa Road East, Glanbrook

 Lands to be rezoned from Conservation/Hazard Land - Rural (P6) Zone to Conservation/Hazard Land - Rural (P7) Zone

 Lands to be rezoned from Rural (A2) Zone to Conservation/Hazard Land - Rural (P7) Zone

 Lands to be rezoned from Conservation/Hazard Land Rural - (P6) Zone to Rural (A2) Zone

 Proposed Zoning Boundary Adjustment

 Existing Zoning Boundary

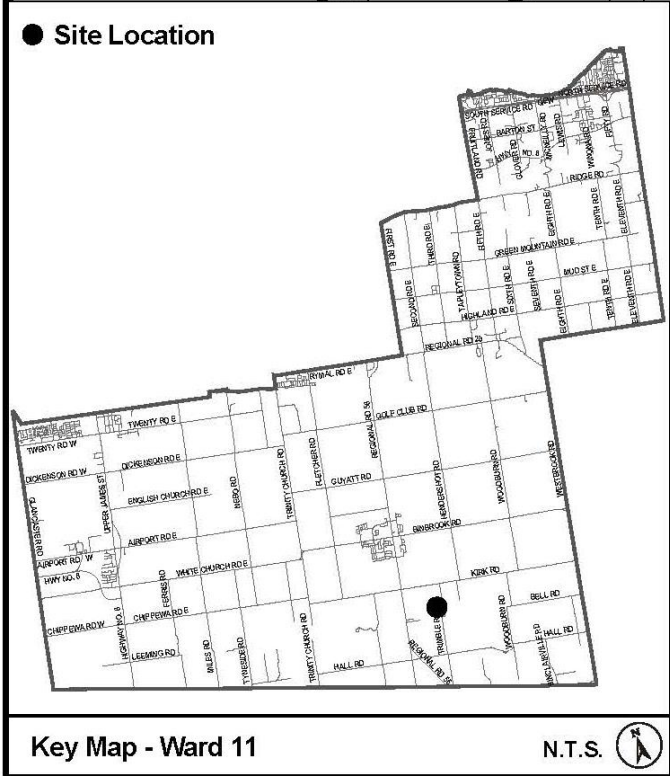

<h2 style="margin: 0;">Location Map</h2>		 Hamilton
PLANNING AND ECONOMIC DEVELOPMENT DEPARTMENT		
File Name/Number: 4250 Trimble Rd	Date: August 14, 2017	
Appendix "A"	Scale: N.T.S.	Planner/Technician: MG/NB
Subject Property 4250 Trimble Road, Glanbrook		
	Change in Zoning from Conservation/Hazard Land (P7) Zone to Agriculture (A1) Zone	
	Proposed Zoning Boundary Adjustmant	
	Existing Zoning Boundary	
N.T.S.		

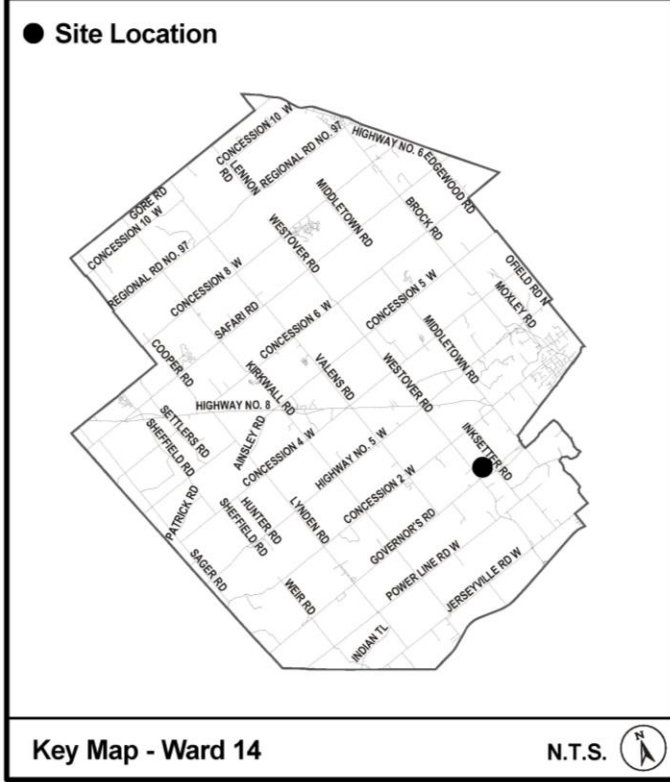
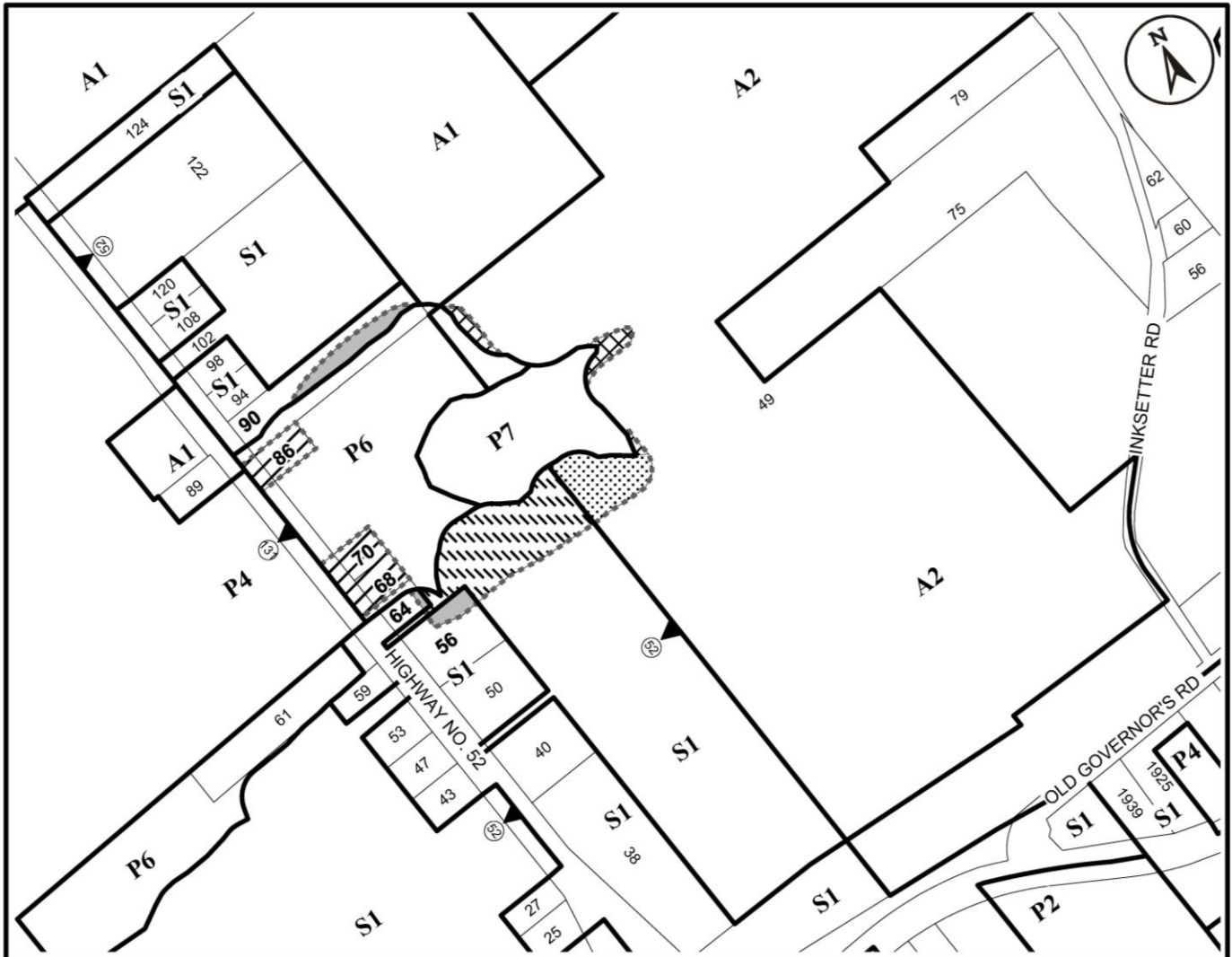

<h2 style="margin: 0;">Location Map</h2>		 Hamilton
PLANNING AND ECONOMIC DEVELOPMENT DEPARTMENT		
File Name/Number: Part of 49 Inksetter Rd.	Date: April 24, 2018	
Appendix "A"	Scale: N.T.S.	Planner/Technician: MG/NB
Subject Property Part of 49 Inksetter Road & 56, 64, 68, 70, 86 & 90 Highway 52, Flamborough		
<ul style="list-style-type: none"> Change in Zoning from Settlement Residential (S1, S2) to Conservation/Hazard Land (P6) Change in Zoning from Settlement Residential (S1) to Conservation/Hazard Land (P6) Change in Zoning from Rural (A2) to Conservation/Hazard Land (P6) Change in Zoning from Rural (A2) to Conservation/Hazard Land (P7) Change in Zoning from Conservation/Hazard Land (P6) to Settlement Residential (S1) Proposed Zoning Boundary Adjustmant Existing Zoning Boundary 		



● Site Location



Key Map - Ward 14

N.T.S.

Location Map



Hamilton

PLANNING AND ECONOMIC DEVELOPMENT DEPARTMENT

File Name/Number:
554, 560 & Hunter Rd.

Date:
March 1, 2018

Appendix "A"

Scale:
N.T.S.

Planner/Technician:
MG/NB

Subject Property

554, 560 & 568 Hunter Road, Flamborough

- Change in Zoning from Agriculture (A1) Zone to Conservation/Hazard Land (P7) Zone
- Change in Zoning from Conservation/Hazard Land (P7) Zone to Agriculture (A1) Zone
- Proposed Zoning Boundary Adjustmant
- Existing Zoning Boundary

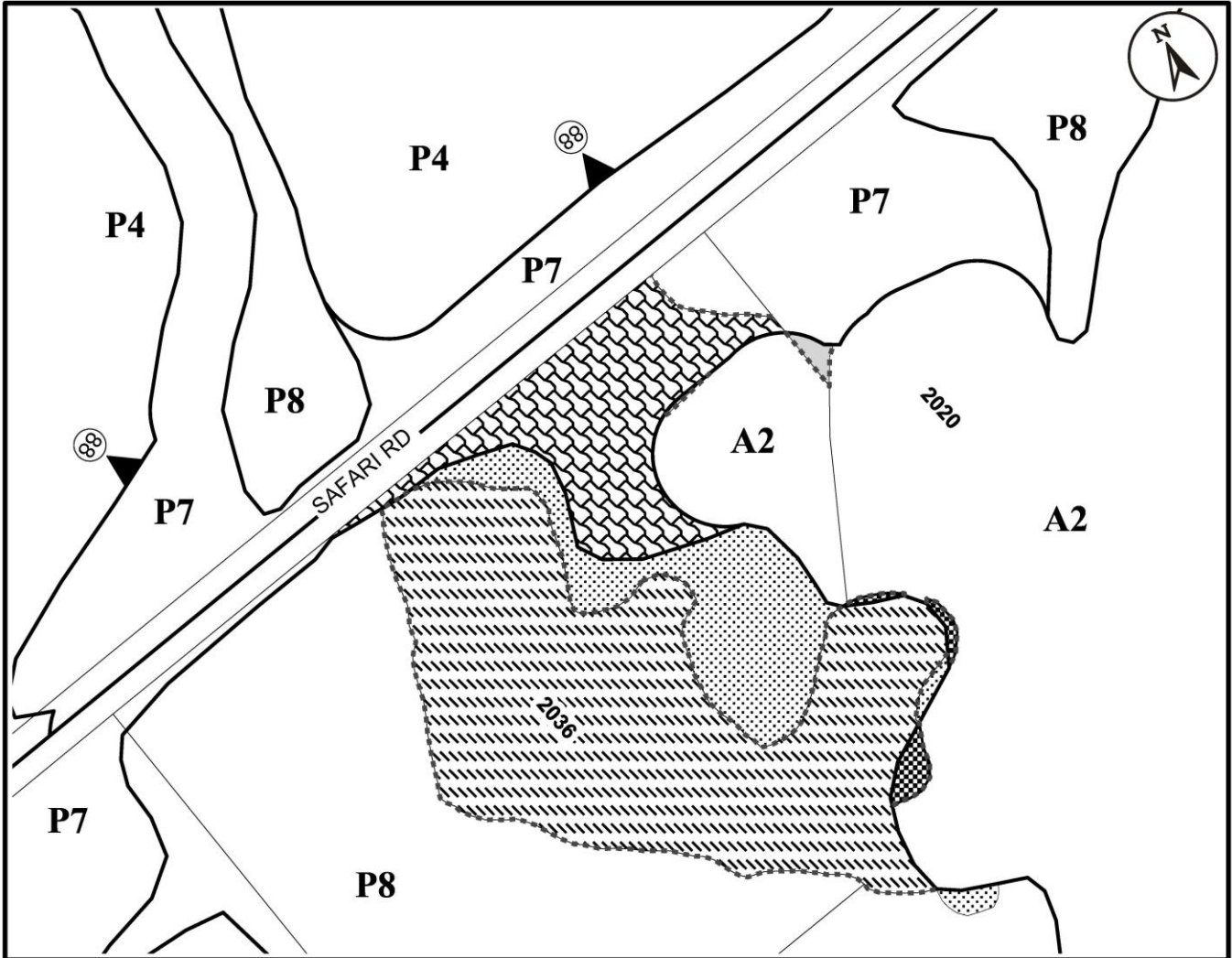

● Site Location

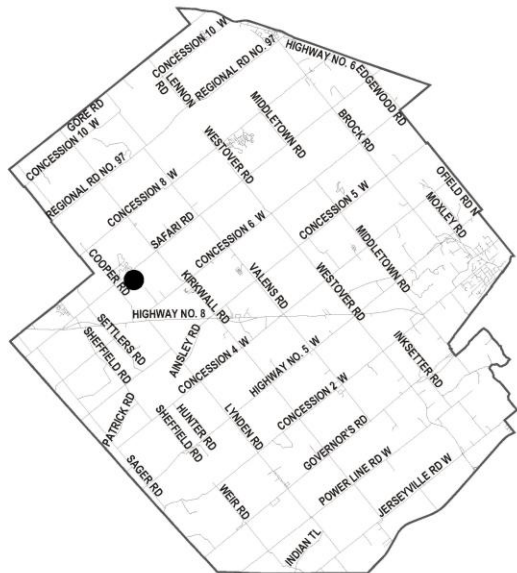

Key Map - Ward 14

N.T.S.



Location Map



PLANNING AND ECONOMIC DEVELOPMENT DEPARTMENT

File Name/Number:
2020 & 2036 Safari Rd

Date:
May 22, 2018

Appendix "A"

Scale:
N.T.S.

Planner/Technician:
MG/NB

Subject Property

2020 & 2036 Safari Road

- Change in Zoning from Conservation/Hazard Land (P8) to Conservation/Hazard Land (P6)
- Change in Zoning from Conservation/Hazard Land (P8) to Rural (A2)
- Change in Zoning from Rural (A2) to Conservation/Hazard Land (P7)
- Change in Zoning from Conservation/Hazard Land (P7) to Rural (A2)
- Change in Zoning from Rural (A2) to Conservation/Hazard Land (P6)
- Proposed Zoning Boundary Adjustment
- Existing Zoning Boundary



● Site Location

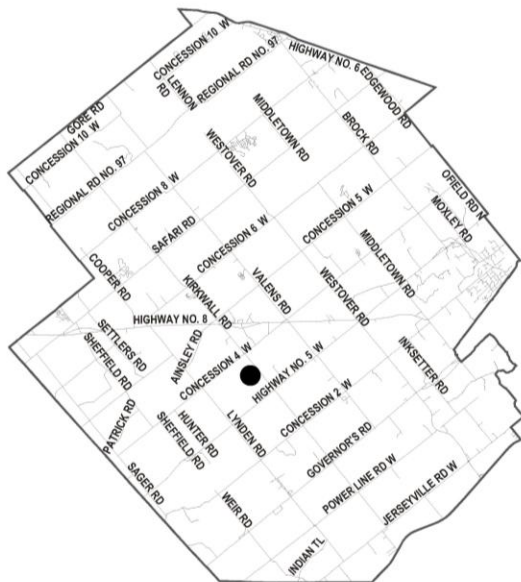

Key Map - Ward 14

N.T.S.

Location Map



Hamilton

PLANNING AND ECONOMIC DEVELOPMENT DEPARTMENT

File Name/Number:

953, 971, 977, 989 and 1005 Kirkwall Rd

Date:

March 1, 2018

Appendix "A"

Scale:
N.T.S.

Planner/Technician:
MG/NB

Subject Property

953, 971, 977, 989 and 1005 Kirkwall Road, Flamborough



Change in Zoning from Rural (A2) Zone to Conservation/Hazard Lands (P7) Zone



Change in Zoning from Conservation/Hazard Lands (P7) Zone to Rural (A2) Zone



Proposed Zoning Boundary Adjustmant



Existing Zoning Boundary

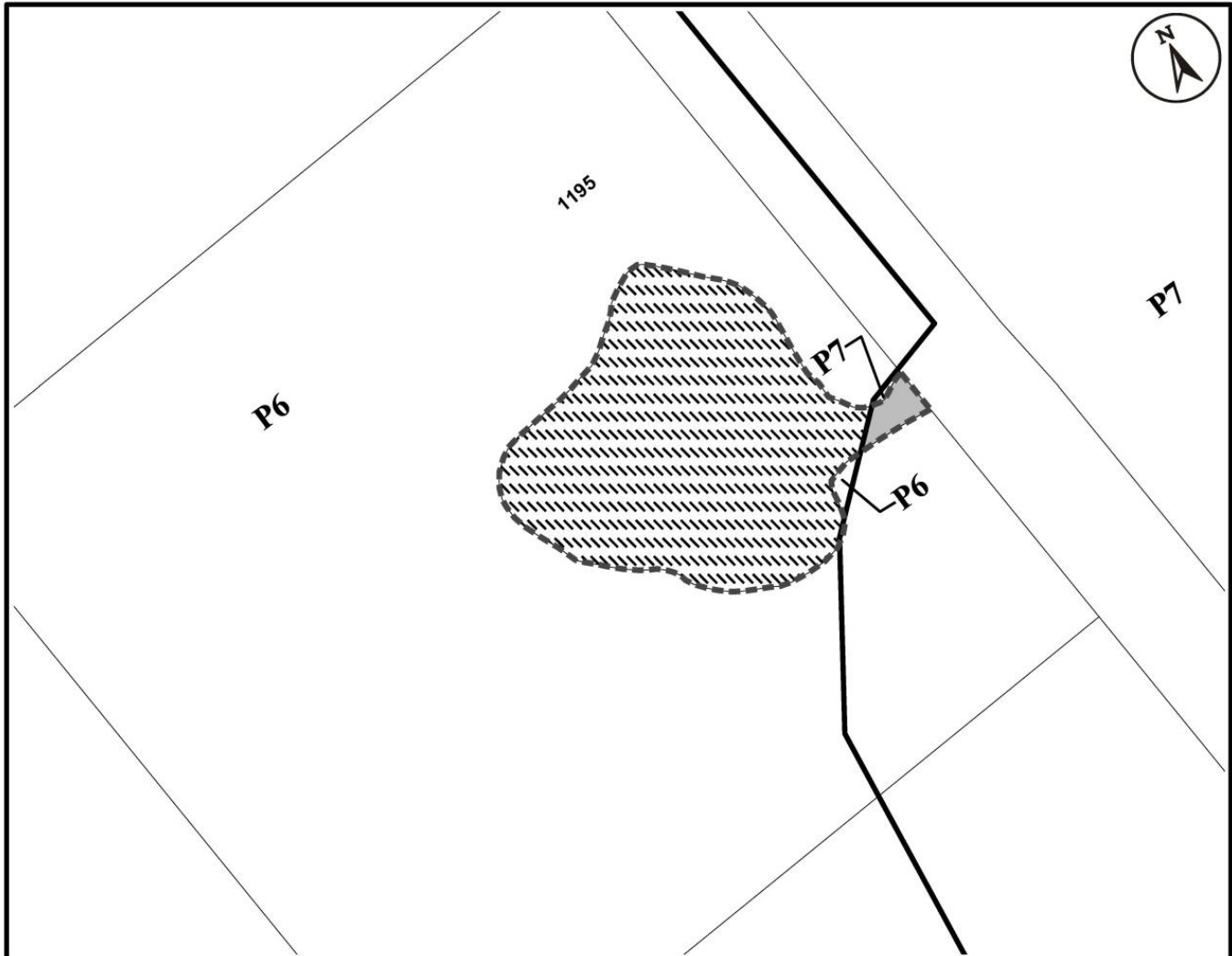

● Site Location

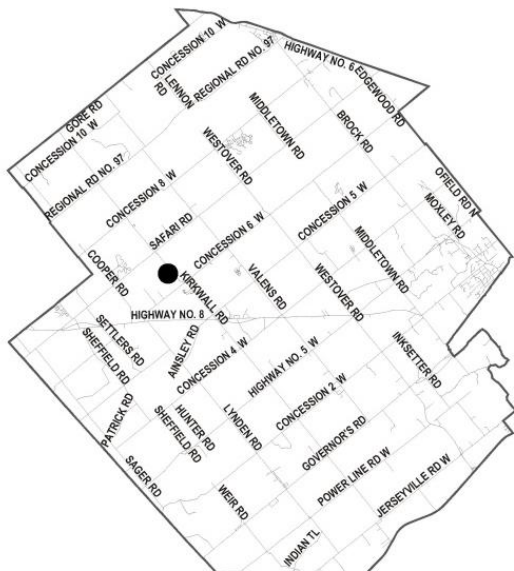

Key Map - Ward 14

N.T.S.

Location Map



Hamilton

PLANNING AND ECONOMIC DEVELOPMENT DEPARTMENT

File Name/Number:
1195 Kirkwall Rd

Date:
March 2, 2018

Appendix "A"

Scale:
N.T.S.

Planner/Technician:
MG/AL

Subject Property

1195 Kirkwall Road

Change in Zoning from Conservation/Hazard Land (P6) to Rural (A2)

Change in Zoning from Conservation/Hazard Land (P7) to Rural (A2)

Proposed Zoning Boundary Adjustment

Existing Zoning Boundary

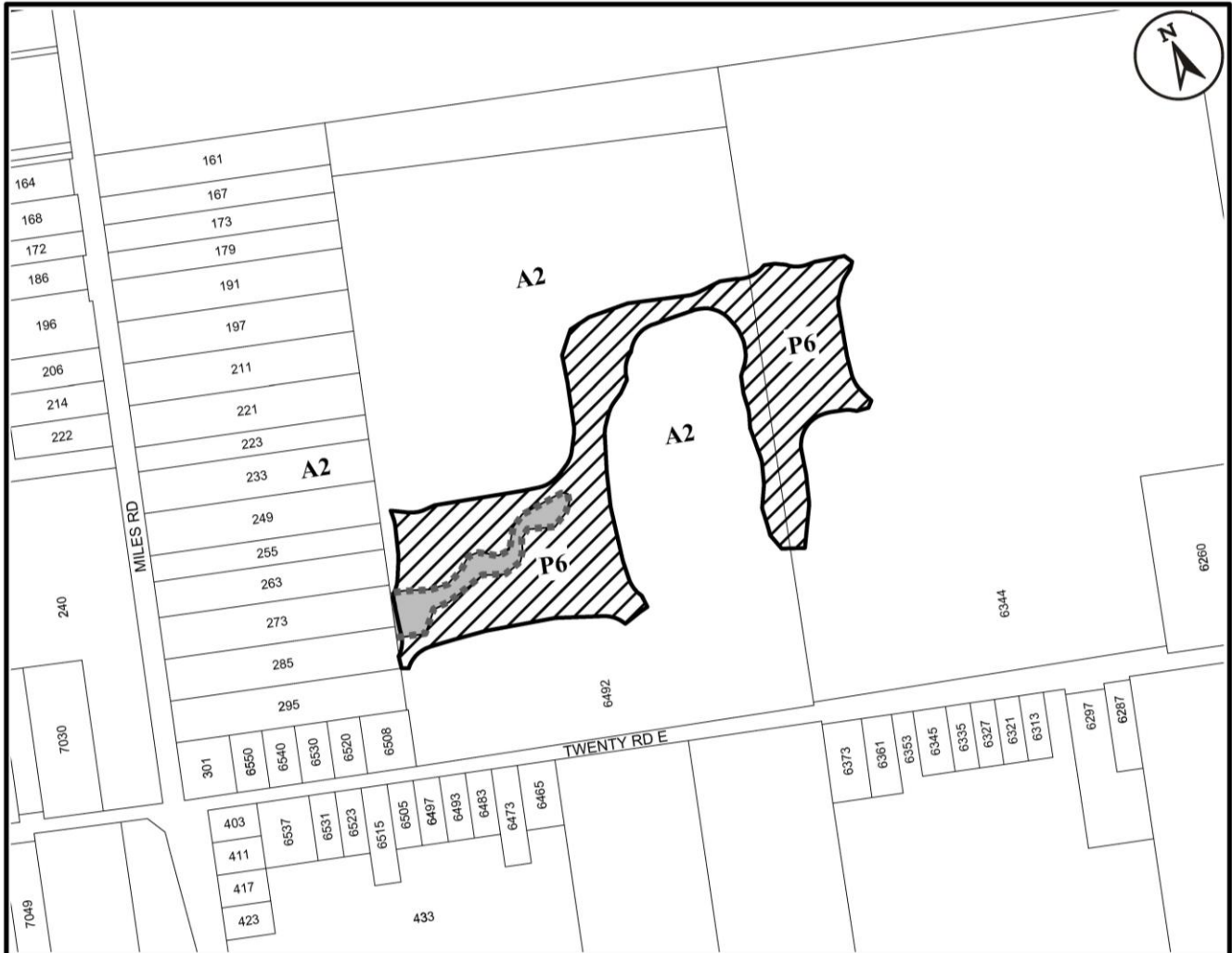

● Site Location



Key Map - Ward 11

N.T.S.

Location Map



PLANNING AND ECONOMIC DEVELOPMENT DEPARTMENT

File Name/Number:
6492 Twenty Rd E

Date:
April 24, 2018

Appendix "A"

Scale:
N.T.S.

Planner/Technician:
MG/NB

Subject Property

6492 & 6344 Twenty Road East

- Change in Zoning from Conservation/Hazard Lands (P6) Zone to Conservation/Hazard Lands (P8) Zone
- Change in Zoning from Conservation/Hazard Lands (P6) Zone to Rural (A2) Zone
- Proposed Zoning Boundary Adjustment
- Existing Zoning Boundary

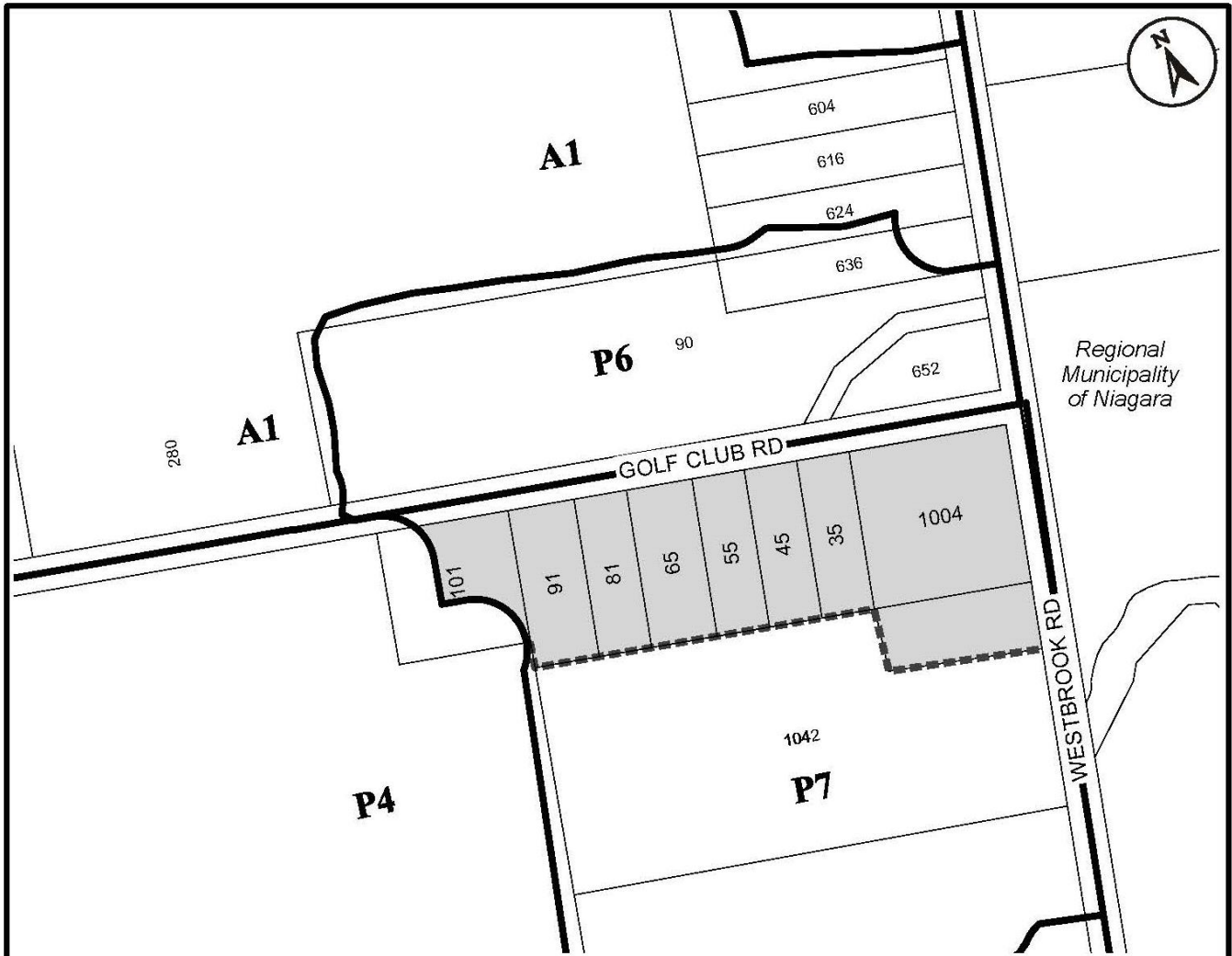

● Site Location

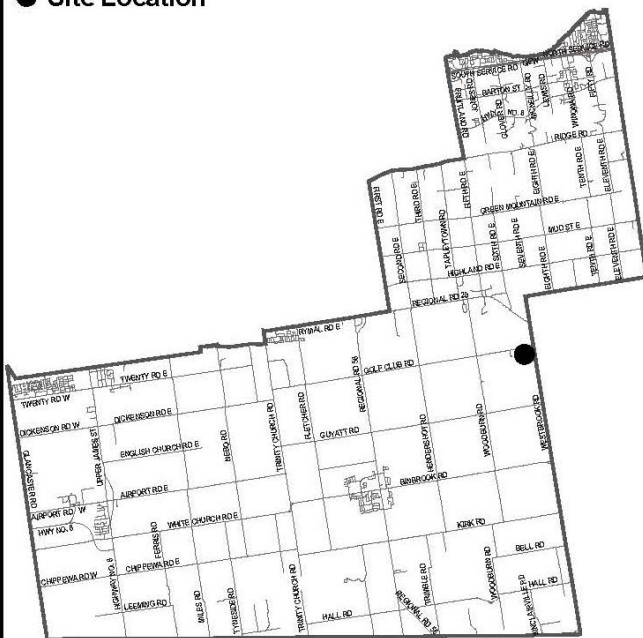

Key Map - Ward 11

N.T.S.



Location Map



Hamilton

PLANNING AND ECONOMIC DEVELOPMENT DEPARTMENT

File Name/Number:
Housekeeping Amendment

Date:
May 31, 2018

Appendix "A"

Scale:
N.T.S.

Planner/Technician:
MG/NB

Subject Property

1004 Westbrook Road, Part of 1042 Westbrook Road,
35, 45, 55, 65, 81, 91 Golf Club Road and Part of 1101 Golf Club Road

- Lands to be rezoned from Conservation/Hazard Land Rural (P7) Zone to Agriculture (A1) Zone
- Proposed Zoning Boundary Adjustment
- Existing Zoning Boundary