

CERTIFIED
 Regulation 22/04

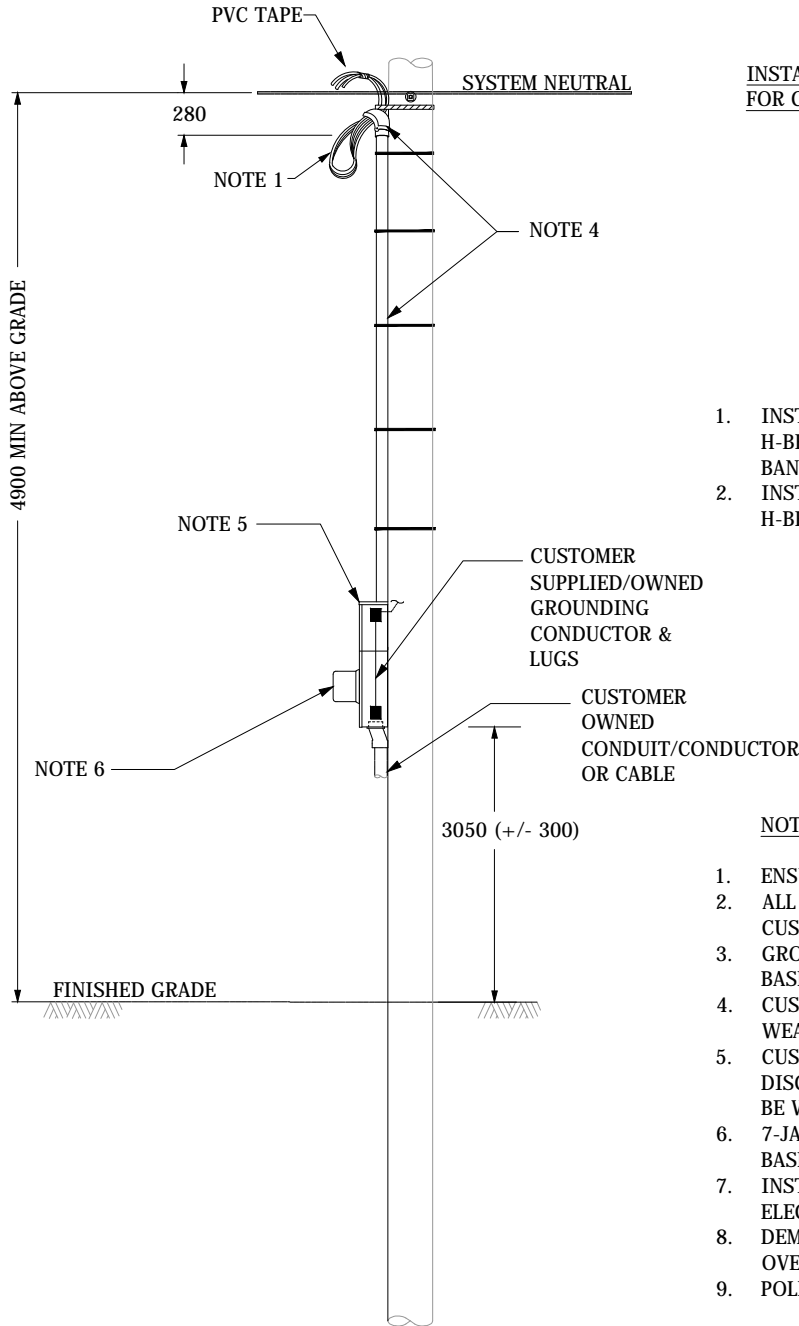

INSTALLATION OF MOUNTING H-BRACKET FOR CUSTOMER OWNED EQUIPMENT.

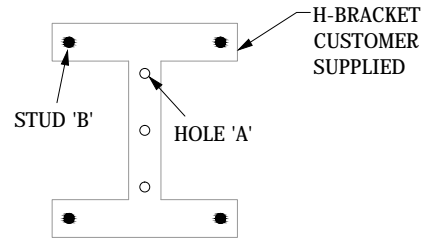

1. INSTALL 3 3/8 x 3" LAG BOLTS THROUGH H-BRACKET HOLES (A) INTO WOOD POLE. USE BANDING ON CONCRETE POLE.
2. INSTALL CABINET ONTO THREADED STUDS (B) ON H-BRACKET AND INSTALL NUTS.

NOTES:

1. ENSURE DRIP LOOP (915mm) IS INSTALLED.
2. ALL EQUIPMENT/MATERIALS SHOWN WILL BE SUPPLIED BY CUSTOMER, INSTALLED BY HUC CREWS.
3. GROUND AND BOND 3 PHASE DISCONNECT AND METER BASE AS PER 41-99 AND 27-51.
4. CUSTOMER SUPPLIED/OWNED CONDUIT, CONDUCTOR, AND WEATHER HEADS.
5. CUSTOMER SUPPLIED/OWNED 347/600V 100/200A 3 PHASE DISCONNECT/BREAKER (FUSED). DISCONNECT/BREAKER TO BE WATERPROOF AND LOCKABLE.
6. 7-JAW 200A METER OWNED BY HORIZON UTILITIES, METER BASE SUPPLIED/OWNED BY CUSTOMER.
7. INSTALLATION TO BE INSPECTED AND APPROVED BY ELECTRICAL SAFETY AUTHORITY (ESA).
8. DEMARCATION POINT IS THE POINT OF CONNECTION TO OVERHEAD SECONDARY BUS/SERVICE.
9. POLE EXISTING AND OWNED BY HORIZON UTILITIES.

ALL DIMENSIONS ARE IN mm UNLESS OTHERWISE SPECIFIED



DRAWING STATUS	BY	DATE DD/MM/YY
DRAWN:	BN	22/04/15
CHECKED:	RM	28/05/15
APPROVED:	DH	28/05/15

TEMPORARY SERVICE
 INSTALLATION 600V
 WYE SERVICE
 100A/200A

REFERENCE DRAWINGS:		
DRAWINGS NOT TO SCALE	41-99 27-51	
DRAWING #	SHEET#	REVISION#
27-14B	1	1