



Hamilton

COMMITTEE OF ADJUSTMENT

City Hall, 5th floor, 71 Main Street West, Hamilton, ON L8P 4Y5
Telephone (905) 546-2424, ext. 4221, 3935 Fax (905) 546-4202
E-mail: cofa@hamilton.ca

NOTICE OF PUBLIC HEARING
Minor Variance

You are receiving this notice because you are either:

- Assessed owner of a property located within 60 metres of the subject property
 - Applicant/agent on file, or
 - Person likely to be interested in this application
-

APPLICATION NO.: HM/A-20:210
APPLICANTS: Ken Bekendam on behalf of the owner Christopher Micucci
SUBJECT PROPERTY: Municipal address **13 Gibson Ave., Hamilton**
ZONING BY-LAW: Zoning By-law 6593, as Amended by By-law 92-281
ZONING: "D" (Urban Protected Residential - One and Two Family) district
PROPOSAL: To permit the conversion of an existing single family dwelling to a two family dwelling, notwithstanding,

1. The minimum lot area for a 2 family dwelling under Section 19 of the Zoning By-law shall be 157 square metres instead of the minimum required 270 square metres.
2. No parking spaces shall be required instead of the minimum required 1 parking space per unit for a converted dwelling.
3. The minimum front yard landscaped area shall be 24% instead of the required 50% front yard minimum landscaped area for a converted dwelling.
4. The minimum driveway width shall be 2.7m instead of the minimum 2.8m driveway width.

NOTES:

1. The requested variances are written as requested by the applicant.
2. The applicant is proposing to establish parking spaces through a Boulevard Parking Agreement with the City (currently under review) as the parking spaces provided on the site plan are undersized. The parking space within the driveway is 5.01 metres in length and the parking space in the front yard is 3.05m in length. As part of the landscaped area of the front yard is being removed, this deficiency is to be addressed through Variance #3.

This application will be heard by the Committee as shown below:

DATE: Thursday, November 5th, 2020
TIME: 1:45 p.m.
PLACE: Via video link or call in (see attached sheet for details)
To be streamed at www.hamilton.ca/committeeofadjustment
for viewing purposes only

PUBLIC INPUT

Written: If you would like to submit written comments to the Committee of Adjustment you may do so via email or hardcopy. Please see attached page for complete instructions, including deadlines for submitting to be seen by the Committee.

Orally: If you would like to speak to this item at the hearing you may do so via video link or by calling in. Please see attached page for complete instructions, including deadlines for registering to participate.

MORE INFORMATION

For more information on this matter, including access to drawings illustrating this request:

- Visit www.hamilton.ca/committeeofadjustment
- Call 905-546-CITY (2489) or 905-546-2424 extension 4221, 4130, or 3935
- Email Committee of Adjustment staff at cofa@hamilton.ca

DATED: October 20th, 2020.



Jamila Sheffield,
Secretary-Treasurer
Committee of Adjustment

Information respecting this application is being collected under the authority of the Planning Act, R.S.O., 1990, c. P. 13. All comments and opinions submitted to the City of Hamilton on this matter, including the name, address, and contact information of persons submitting comments and/or opinions, will become part of the public record and will be made available to the Applicant and the general public.

ADDRESS	13 GIBSON AVENUE - HAMILTON - ON.		
ZONING TYPE	D		
LOT AREA	157.00 SQ M (1690.00 SQ FT)		
LOT FRONTAGE	7.92m [26.00']		
FLOOR AREAS	ALLOWED	EXISTING	PROPOSED
BASEMENT			NO CHANGE
MAIN FLOOR			NO CHANGE
SECOND FLOOR			NO CHANGE
THIRD FLOOR			NO CHANGE
SETBACKS			
FRONT			NO CHANGE
SIDE			NO CHANGE
BACK			NO CHANGE
SIDE			NO CHANGE

1. ALL CONSTRUCTION TO COMPLY WITH THE REVISED ONTARIO BUILDING CODE 2012.
2. ALL DIMENSIONS ARE MEASURED TO ROUGH FRAMING OR TO MASONRY SURFACES UNLESS OTHERWISE NOTED.
3. ALL DOORS AND WINDOW OPENINGS ARE MEASURED TO ROUGH FRAMING OR MASONRY OPENINGS.
4. CONTRACTOR IS TO VERIFY WINDOW OPENINGS WITH WINDOW MANUFACTURER PRIOR TO COMMENCING WORK.
5. READ ARCHITECTURAL DRAWINGS IN CONJUNCTION WITH STRUCTURAL, MECHANICAL AND ELECTRICAL DRAWINGS.
6. ELEVATION REFERENCES ARE BASED ON 100'-0" = 131.70m GEODETIC ELEVATIONS AS NOTED ON A1 SITE PLAN.
7. ALL DIMENSIONS MUST BE CHECKED AGAINST THE ARCHITECTURAL DRAWINGS AND THE FIELD CONDITIONS BEFORE COMMENCING FABRICATION, AND INCONSISTENCIES ARE TO BE REPORTED TO THE CONSULTANT BEFORE PROCEEDING WITH THE WORK.
8. THE CONTRACTOR SHALL PROPERLY SUPERVISE THE WORK AND ENSURE THAT THE WORK IS INSTALLED TO THE CORRECT LINES AND LEVELS, THAT THE CONNECTIONS AND DETAILS CONFIRM TO THE DRAWING DETAILS AND SHALL COORDINATE THE INTERFACING OF ALL WORK WITH ALL SUB-TRADES.
9. PROVIDE POSITIVE FRONT YARD SLOPE TO MUNICIPAL SEWER FOR WATER RUN-OFF.
10. CONTRACTOR TO BE RESPONSIBLE FOR VERIFYING THE LOCATIONS OF ALL EXISTING UNDERGROUND AND ABOVE UTILITIES AND SERVICES. VARIOUS UTILITIES CONCERNED TO BE GIVEN REQUIRED ADVANCING NOTICE PRIOR TO ANY DIGGING, FOR STAKE OUT.
11. REFER TO LANDSCAPING PLAN FOR PLANTING CONFIRM LAYOUT WITH LANDSCAPE CONTRACTOR
12. DESIGNER NOT RESPONSIBLE FOR ACCURACY OF SURVEY DRAWING.

OWNER AND CONTRACTOR IS FULLY RESPONSIBLE FOR VERIFYING ALL EXISTING STRUCTURAL CONDITIONS PRIOR TO ANY WORK, ANY AND ALL DISCREPANCIES SHALL BE REPORTED TO THE OWNER PRIOR TO ANY WORK. OWNER AND CONTRACTOR IS FULLY RESPONSIBLE FOR SHORING EXISTING STRUCTURE PRIOR TO ANY WORK.

THESE DRAWINGS DO NOT REPRESENT A COMPREHENSIVE AND EXHAUSTIVE GUIDE FOR COMPLIANCE WITH THE ONTARIO BUILDING CODE. IT IS ASSUMED THAT THE CONTRACTOR HAS REASONABLY SUFFICIENT KNOWLEDGE OF THE ONTARIO BUILDING CODE IN ORDER TO PERFORM ALL WORK AS PER THESE DRAWINGS IN SUCH A WAY THAT WILL COMPLY WITH ALL ASPECTS OF THE O.B.C. AND WILL NOT CONTRAVENE ANY OTHER APPLICABLE LAWS.

BASED ON HAMILTON SITE MAPS
AND MEASUREMENTS ON SITE
DESIGNER ASSUMES NO
RESPONSIBILITY FOR ACCURACY
OF HAMILTON MAPS.
THIS SITE SHALL NOT BE USED FOR
ANY OTHER PURPOSES.
NO WORK TO ENCROACH
ONTO ADJOINING PROPERTIES

The site plan for 13 Gibson Avenue shows a proposed 2-unit dwelling with a total area of 59.59 SQ m (641.47 SQ FT). The plan includes a front porch, a deck, and two parking spaces, each with a car icon and dimensions (2.77 and 2.74 respectively). The property is bounded by a widened driveway approach on the left, Gibson Avenue on the top and bottom, and a sidewalk on the left. Dimensions are provided for all boundaries and internal spaces, including setbacks and lot widths. A north arrow is located in the bottom right corner.

13 GIBSON AVENUE
59.59 SQ m (641.47 SQ FT)
PROPOSED
2 UNIT DWELLING

Key features and dimensions include:

- Front Porch:** 2.07m wide, 3.05m deep.
- Deck:** 0.94m wide, 4.56m deep.
- Parking Spaces:** Two spaces, each 2.74m wide and 7.92m deep.
- Setbacks:** 0.29m front setback, 0.65m side setbacks.
- Lot Dimensions:** 19.81m wide by 7.92m deep.
- Surrounding Areas:** 1.30m wide sidewalk, 2.74m wide driveway approach.

LANDSCAPED AREA = 9.75 SQ m = 24.04%
HARD SURFACE AREA = 30.82 SQ m = 75.96%



LEGAL SECOND SUITES

www.legalsecondsuites.com

**13 GIBSON AVENUE
HAMILTON, ON.**

SITE PLAN METRIC

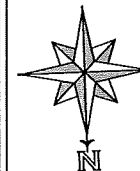
$$\frac{1''}{8} = 1'$$

2 UNIT CONVERSION

SEPT 2020

SP1.01

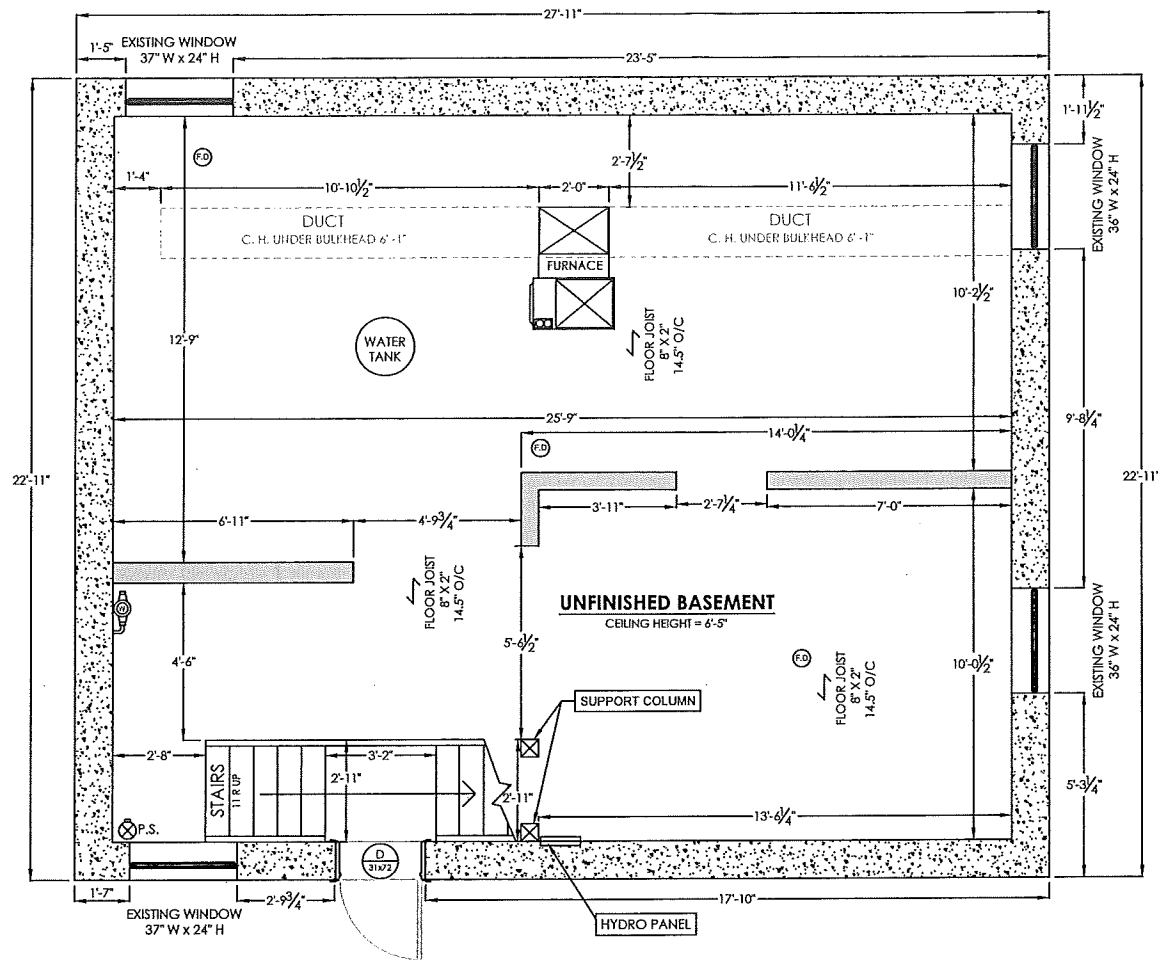

ELETRONIC STAMP

PLANS LEGEND	
	BATH
	EXHAUST FAN
	SPECIFICATION TAG
	SMOKE ALARM
	CARBON MONOXIDE ALARM
	CEILING HEIGHT
	STRUCTURAL BEAM OR WALL
	PLUMBING STACK
	WATER METER
	FLOOR DRAIN
	STRUCTURAL COLUMN
	FOUNDATION WALL
	EXISTING EXTERIOR WALLS
	NEW EXTERIOR WALLS
	EXISTING INTERIOR WALLS
	NEW INTERIOR WALLS
	STRUCTURAL WALLS
	NEW STRUCTURAL BEAMS
	WINDOWS
	SUPPLY REGISTER
	RETURN GRILLE
	DOOR TYPE
	DOOR SIZE
DOOR LEGEND	
A.	PANEL DOOR
B.	FIRE DOOR w/ SELF CLOSER (45 MIN)
C.	FIRE DOOR w/ SELF CLOSER (20 MIN)
D.	EXTERIOR DOOR
E.	BIFOLD CLOSET
F.	SLIDING DOOR
G.	POCKET DOOR



LEAD DESIGNER &
CONSULTANT

KEN BEKENDAM
kenbekendam@gmail.com
C: (905)-961-0647
(855) - KINGHMS (546-4467)

LEAD ENGINEER

ROBERT MENDEZ P. ENG. 100054193
robertmendez@yahoo.com
C: (416)-807-1572

www.legalsecondsuites.com



ADDRESS:

13 GIBSON AVENUE
HAMILTON, ON.

EXISTING BASEMENT

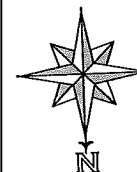

SCALE:

$\frac{1}{4}" = 1'$

PROJECT:

2 UNIT
CONVERSION

DATE:

SEPT 2020

SHEET#:

A1.01

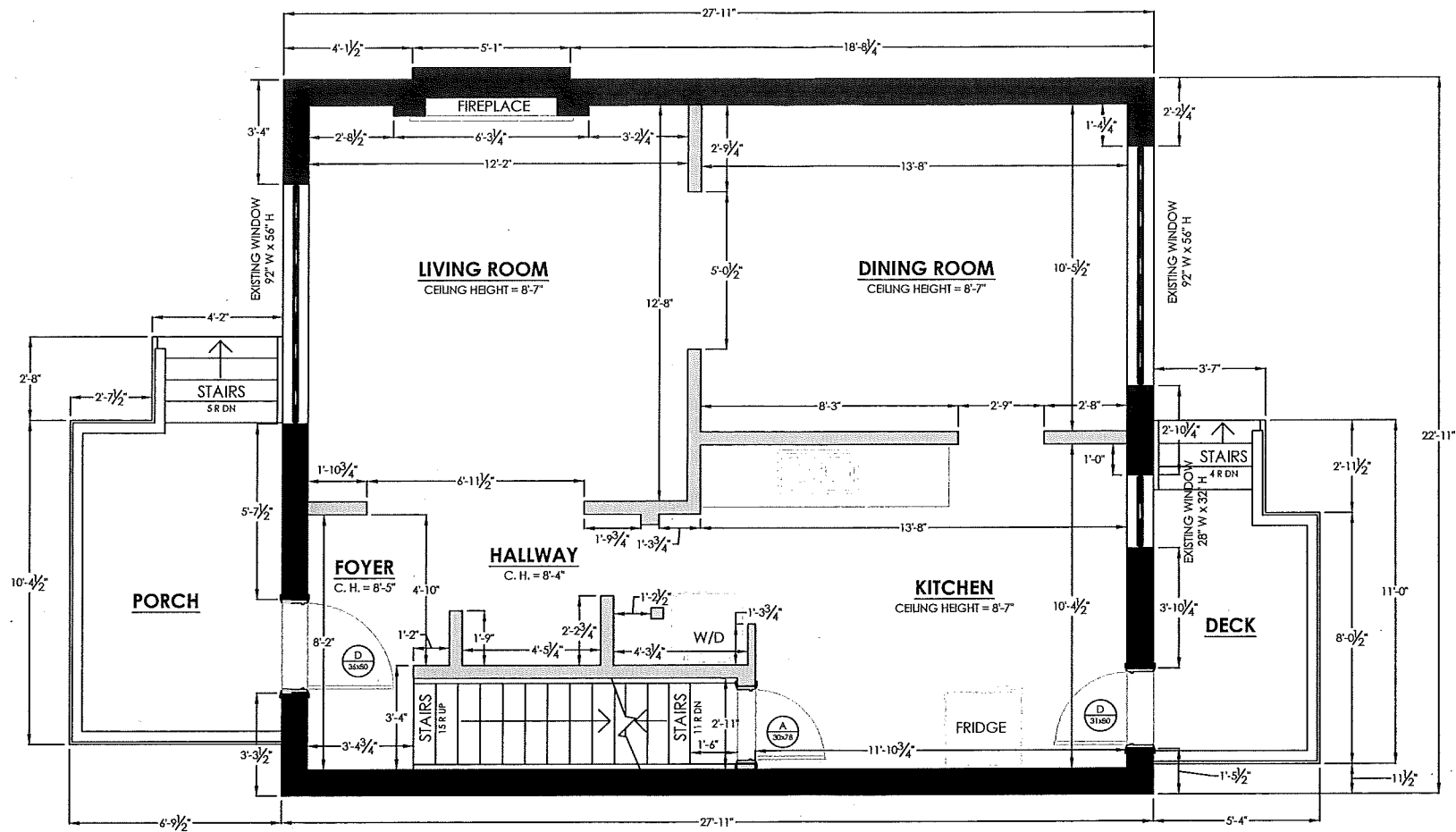

ELETRONIC STAMP

BATH	ROOM NAME
EF	EXHAUST FAN
2	SPECIFICATION TAG
SA	SMOKE ALARM
CGMA	CARBON MONOXIDE ALARM
C.H. = 8'-10"	CEILING HEIGHT
	STRUCTURAL BEAM OR WALL
P.S.	PLUMBING STACK
WM	WATER METER
FD	FLOOR DRAIN
SC	STRUCTURAL COLUMN
	FOUNDATION WALL
	EXISTING EXTERIOR WALLS
	NEW EXTERIOR WALLS
	EXISTING INTERIOR WALLS
	NEW INTERIOR WALLS
	STRUCTURAL WALLS
	NEW STRUCTURAL BEAMS
	WINDOWS
SUPPLY	SUPPLY REGISTER
RETURN	RETURN GRILLE
A 30x60	DOOR TYPE DOOR SIZE
DOOR LEGEND A. PANEL DOOR B. FIRE DOOR w/ SELF CLOSER (45 MIN) C. FIRE DOOR w/ SELF CLOSER (20 MIN) D. EXTERIOR DOOR E. BIFOLD CLOSET F. SLIDING DOOR G. POCKET DOOR	



LEAD DESIGNER & CONSULTANT
 KEN BEKENDAM
 kenbekendam@gmail.com
 C: (905)-961-0647
 (855) - KINGHMS (546-4467)

LEAD ENGINEER
 ROBERT MENDEZ P. ENG. 100054193
 robertmendez@yahoo.com
 C: (416)-807-1572

www.legalsecondsuites.com



ADDRESS:
**13 GIBSON AVENUE
 HAMILTON, ON.**

EXISTING GROUND FLOOR



SCALE:
1/4" = 1'

PROJECT:
**2 UNIT
 CONVERSION**

DATE:
SEPT 2020

SHEET#:
A1.02

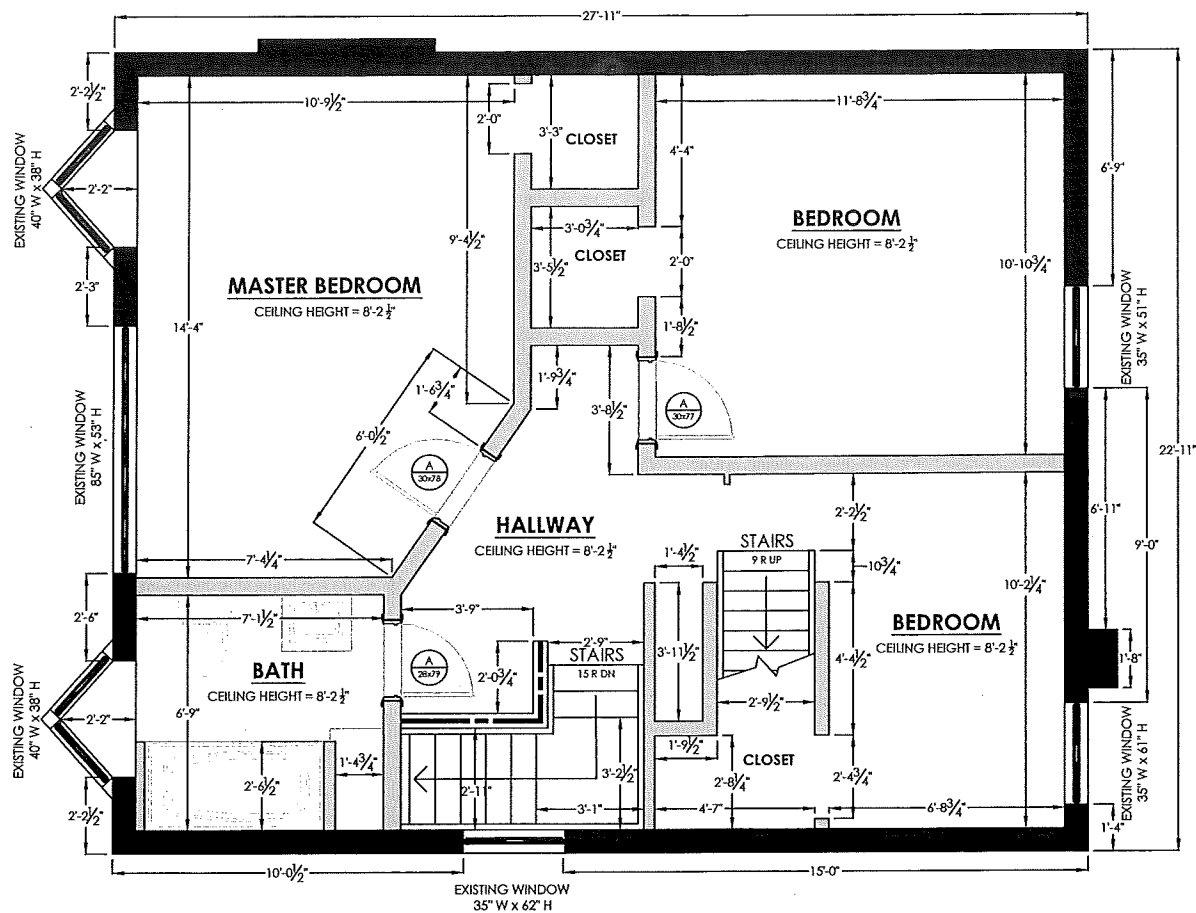

ELETRONIC STAMP

PLANS LEGEND	
	BATH
	EXHAUST FAN
	SPECIFICATION TAG
	SMOKE ALARM
	CARBON MONOXIDE ALARM
	CEILING HEIGHT
	STRUCTURAL BEAM OR WALL
	PLUMBING STACK
	WATER METER
	FLOOR DRAIN
	STRUCTURAL COLUMN
	FOUNDATION WALL
	EXISTING EXTERIOR WALLS
	NEW EXTERIOR WALLS
	EXISTING INTERIOR WALLS
	NEW INTERIOR WALLS
	STRUCTURAL WALLS
	NEW STRUCTURAL BEAMS
	WINDOWS
	SUPPLY REGISTER
	RETURN GRILLE
	DOOR TYPE
	DOOR SIZE
DOOR LEGEND	
A.	PANEL DOOR
B.	FIRE DOOR w/ SELF CLOSER (45 MIN)
C.	FIRE DOOR w/ SELF CLOSER (20 MIN)
D.	EXTERIOR DOOR
E.	BIFOLD CLOSET
F.	SLIDING DOOR
G.	POCKET DOOR



LEAD DESIGNER & CONSULTANT

KEN BEKENDAM
kenbekendam@gmail.com
C: (905)-961-0647
(855) - KINGHMS (546-4467)

LEAD ENGINEER

ROBERT MENDEZ P. ENG. 100054193
robertmendez@yahoo.com
C: (416)-807-1572

www.legalsecondsuites.com



ADDRESS:

13 GIBSON AVENUE
HAMILTON, ON.

EXISTING SECOND FLOOR

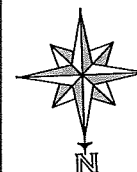

SCALE:

1/4" = 1'

PROJECT:

2 UNIT
CONVERSION

DATE:

SEPT 2020

SHEET#:

A1.03

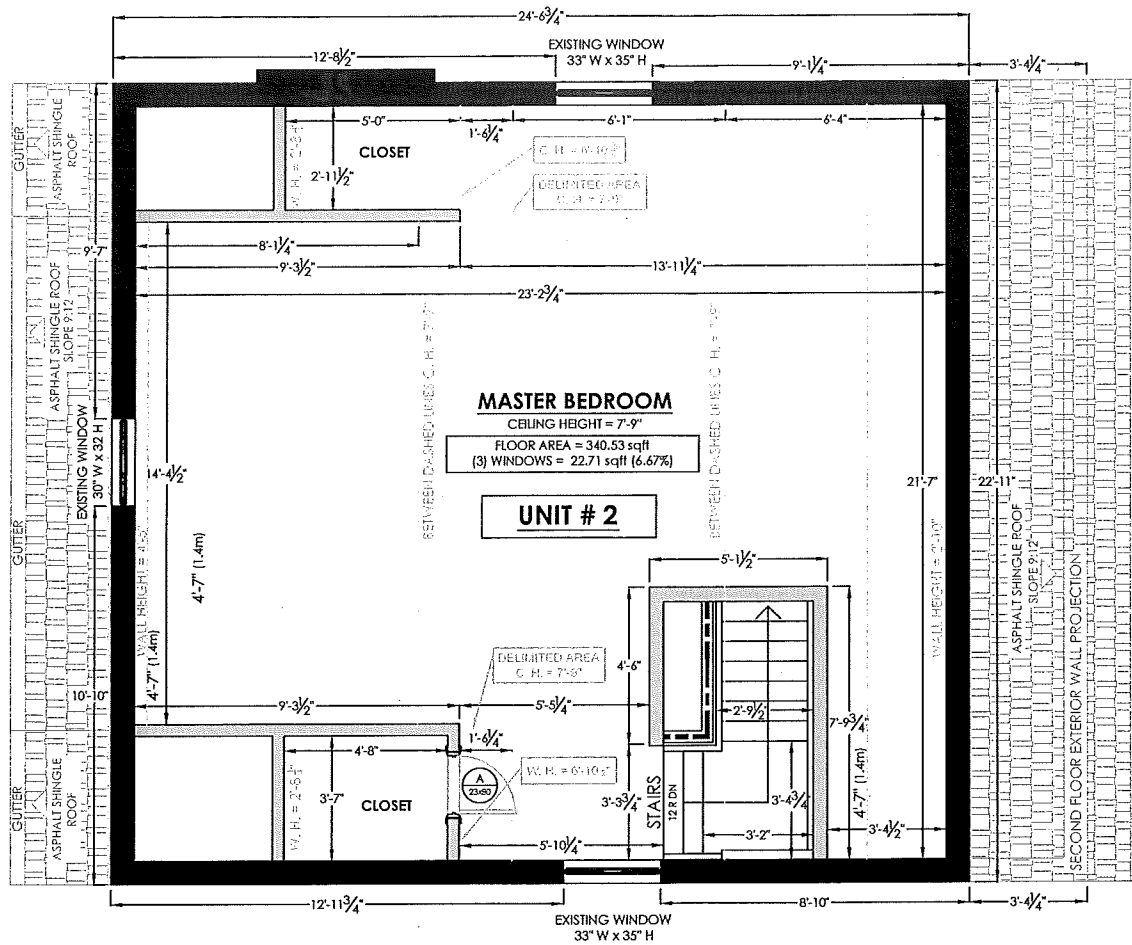

NOTE: NO CHANGES TO THIS FLOOR

NOTE: ALL SMOKE ALARMS
TO BE INTERCONNECTED

ELECTRONIC STAMP

PLANS LEGEND	
BATH	ROOM NAME
EF	EXHAUST FAN
2	SPECIFICATION TAG
SA	SMOKE ALARM
CMA	CARBON MONOXIDE ALARM
C.H. = 8'-10"	CEILING HEIGHT
	STRUCTURAL BEAM OR WALL
P.S.	PLUMBING STACK
WM	WATER METER
FD	FLOOR DRAIN
SC	STRUCTURAL COLUMN
	FOUNDATION WALL
	EXISTING EXTERIOR WALLS
	NEW EXTERIOR WALLS
	EXISTING INTERIOR WALLS
	NEW INTERIOR WALLS
	STRUCTURAL WALLS
	NEW STRUCTURAL BEAMS
	WINDOWS
SUPPLY	SUPPLY REGISTER
RETURN	RETURN GRILLE
A 20/25	DOOR TYPE DOOR SIZE
DOOR LEGEND	
A. PANEL DOOR	
B. FIRE DOOR w/ SELF CLOSER (45 MIN)	
C. FIRE DOOR w/ SELF CLOSER (20 MIN)	
D. EXTERIOR DOOR	
E. BIFOLD CLOSET	
F. SLIDING DOOR	
G. POCKET DOOR	



KING HOMES
DESIGN | BUILD | MANAGE

LEAD DESIGNER & CONSULTANT
KEN BEKENDAM
kenbekendam@gmail.com
C: (905)-961-0647
(855) - KINGHMS (546-4467)

LEAD ENGINEER
ROBERT MENDEZ P. ENG. 100054193
robertmendez@yahoo.com
C: (416)-807-1572



**LEGAL
SECOND
SUITES**

www.legalsecondsuites.com

ADDRESS:

**13 GIBSON AVENUE
HAMILTON, ON.**

**EXISTING / PROPOSED ATTIC
UNIT #2**

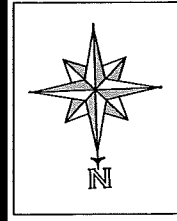

SCALE:

1/4" = 1'

PROJECT:

**2 UNIT
CONVERSION**

DATE:

SEPT 2020

SHEET#:

A1.04

NEW SEPARATION BETWEEN UNITS TO HAVE A FIRE RESISTANCE RATING OF 30 MINS AS PER O.B.C. 9.10.9.14 AND PART 11 COMPLIANCE - C152 AND STC50

- EX. WOOD JOISTS @ 16" O.C.
- 6" THICK ABSORPTIVE MATERIAL IN CAVITY (FIBRE FROM ROCK/SLAG W/ MIN 90mm & MIN. SURFACE AREA MASS OF 2.8 KG/SQ. M
- RESILIENT METAL CHANNELS SPACED @ 16" O.C.
- 1 LAYER 5/8" TYPE X GYPSUM BOARD ON CEILING SIDE

- NEW 2 x 4 STUD WALL SPACED 16" O.C.
- 3.5" THICK ABSORPTIVE MATERIAL
- RESILIENT METAL CHANNELS SPACED 24" O.C.
- 2 LAYERS 5/8" TYPE X GYPSUM BOARD ON CHANNEL SIDE
- 1 LAYER 5/8" TYPE X GYPSUM BOARD ON OTHER SIDE

EX. 1/2" REGULAR GYPSUM BOARD TO REMAIN AS IS
- ADDITIONAL LAYER OF 5/8" TYPE X TO BE APPLIED OVER
EXISTING

EX. LATH AND PLASTER TO REMAIN AS IS
- MEETS A 30 MIN FRR AS PER ONTARIO FIRE MARSHALL
- WITH INTERCONNECTED SMOKE DETECTORS IN EACH DWELLING UNIT

- EX. 1/2" REGULAR GYPSUM BOARD OR PLASTER TO REMAIN
- AS PER PART 11 C143.1, HUD REHABILITATION GUIDELINES, "GUIDELINE ON FIRE RATINGS OF ARCHAIC MATERIALS AND ASSEMBLIES"
- WITH INTERCONNECTED SMOKE DETECTORS IN EACH DWELLING UNIT

- USE FIRE RATED FOAM TESTED IN ACCORDANCE WITH CAN/ULC-S115 (EG. HILTI FIRE FOAM CP 620 OR 3M FIRE BARRIER SEALANT CP 25WB+)

- ADDRESSED WITH IN-DUCT SMOKE DETECTOR:
- SEE NOTE NEAR FURNACE ON FLOOR PLAN

- USE ULC RATED FIRE-RATED ACCESS PANELS (MIN. 45 MINS.)

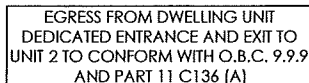





























STOVE TO BE
VENTED OUTSIDE

DRYER TO BE
VENTED OUTSIDE

EGRESS FROM DWELLING UNIT
DEDICATED ENTRANCE AND EXIT TO
UNIT 1 TO CONFORM WITH O.B.C. 9.9.9
AND PART 11 C136 (A)

PIANS I LEGEND

PLANS LEGEND		BATH	ROOM NAME
		E.F.	EXHAUST FAN
		2	SPECIFICATION TAG
		S.A.	SMOKE ALARM
		C.M.A.	CARBON MONOXIDE ALARM
		C.H. = 8'-10'	CEILING HEIGHT
			STRUCTURAL BEAM OR WALL
		P.S.	PLUMBING STACK
			WATER METER
		F.D.	FLOOR DRAIN
			STRUCTURAL COLUMN
			FOUNDATION WALL
			EXISTING EXTERIOR WALLS
			NEW EXTERIOR WALLS
DOOR LEGEND			EXISTING INTERIOR WALLS
			NEW INTERIOR WALLS
			STRUCTURAL WALLS
			NEW STRUCTURAL BEAMS
			WINDOWS
		SUPPLY	SUPPLY REGISTER
		RETURN	RETURN GRILLE
		A 30x40	DOOR TYPE DOOR SIZE
			A. PANEL DOOR
			B. FIRE DOOR w/ SELF CLOSER (45 MIN)
			C. FIRE DOOR w/ SELF CLOSER (20 MIN)
			D. EXTERIOR DOOR
			E. BIFOLD CLOSET
			F. SLIDING DOOR
		G. POCKET DOOR	

DOOR LEGEND



KING HOMES
DESIGN | BUILD | MANAGE

KEN BEKENDAM
kenbekendam@gmail.com
C: (905)-961-0647
(855) - KINGHMS (546-4467)



LEGAL SECOND SUITES

LEAD ENGINEER ROBERT MENDEZ P. ENG. 100054193
robertmendez@yahoo.com
C: (416)-807-1572

www.legalsecondsuites.com

**13 GIBSON AVENUE
HAMILTON, ON.**

**PROPOSED GROUND FLOOR
UNIT #1**

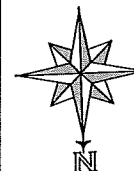
$$\frac{1''}{4} = 1'$$

2 UNIT CONVERSION

SEPT 2020

A1.06

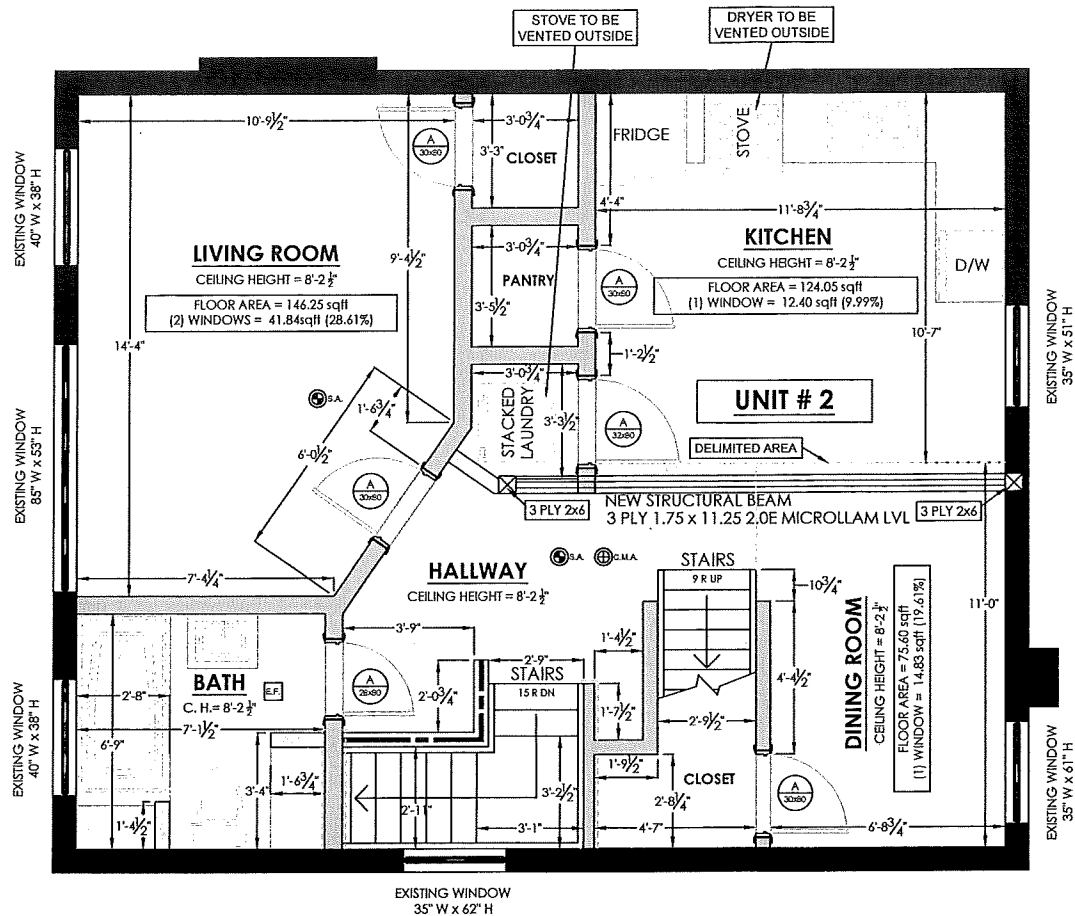

SEPARATION BETWEEN UNITS:
NEW SEPARATION BETWEEN UNITS TO HAVE A FIRE RESISTANCE RATING OF 30 MINS AS PER O.B.C. 9.10.9.14 AND PART 11 COMPLIANCE - C152 AND STC50
BASEMENT CEILING (SEPARATING SECOND SUITE; F8D NEW PORTIONS ONLY)
- EX. WOOD JOISTS @ 14" O.C.
- 6" THICK ABSORPTIVE MATERIAL IN CAVITY (FIBRE FROM ROCK/SLAG W/ MIN 90mm & MIN. SURFACE AREA MASS OF 2.8 KG/SQ. M)
- RESILIENT METAL CHANNELS SPACED @ 16" O.C.
- 1 LAYER 5/8" TYPE X GYPSUM BOARD ON CEILING SIDE
NEW SHARED PARTITIONS: W4A
- NEW 2 x 4 STUD WALL SPACED 16" O.C.
- 3.5" THICK ABSORPTIVE MATERIAL
- RESILIENT METAL CHANNELS SPACED 24" O.C.
- 2 LAYERS 5/8" TYPE X GYPSUM BOARD ON CHANNEL SIDE
- 1 LAYER 5/8" TYPE X GYPSUM BOARD ON OTHER SIDE
EXISTING SHARED PARTITIONS:
EX. 1/2" REGULAR GYPSUM BOARD TO REMAIN AS IS
- ADDITIONAL LAYER OF 5/8" TYPE X TO BE APPLIED OVER EXISTING
EX. LATH AND PLASTER TO REMAIN AS IS
- MEETS A 30 MIN FRR AS PER ONTARIO FIRE MARSHALL
- WITH INTERCONNECTED SMOKE DETECTORS IN EACH DWELLING UNIT
EXISTING CEILING (15 MIN FRR BETWEEN DWELLING UNITS)
- EX. 1/2" REGULAR GYPSUM BOARD OR PLASTER TO REMAIN
- AS PER PART 11 C143.1, HUD REHABILITATION GUIDELINES, "GUIDELINE ON FIRE RATINGS OF ARCHAIC MATERIALS AND ASSEMBLIES"
- WITH INTERCONNECTED SMOKE DETECTORS IN EACH DWELLING UNIT
FOR PIPE AND WIRE PENETRATIONS:
- USE FIRE RATED FOAM TESTED IN ACCORDANCE WITH CAN/ULC-S115 (EG. HILT FIRE FOAM CP 620 OR 3M FIRE BARRIER SEALANT CP 25WB+)
FOR HVAC DUCTING:
- ADDRESSED WITH IN-DUCT SMOKE DETECTOR;
- SEE NOTE NEAR FURNACE ON FLOOR PLAN
FOR SERVICE ITEMS IN FIRE SEPARATION (VALVES, METERS, ELECTRICAL BOXES, ETC):
- USE ULC RATED FIRE-RATED ACCESS PANELS (MIN. 45 MINS.)

ELETRONIC STAMP

BATH	ROOM NAME
E.F.	EXHAUST FAN
2	SPECIFICATION TAG
S.A.	SMOKE ALARM
C.M.A.	CARBON MONOXIDE ALARM
C.H. = 8'-10"	CEILING HEIGHT
	STRUCTURAL BEAM OR WALL
P.S.	PLUMBING STACK
W.M.	WATER METER
F.D.	FLOOR DRAIN
	STRUCTURAL COLUMN
	FOUNDATION WALL
	EXISTING EXTERIOR WALLS
	NEW EXTERIOR WALLS
	EXISTING INTERIOR WALLS
	NEW INTERIOR WALLS
	STRUCTURAL WALLS
	NEW STRUCTURAL BEAMS
	WINDOWS
SUPPLY	SUPPLY REGISTER
RETURN	RETURN GRILLE
A 30x60	DOOR TYPE DOOR SIZE
DOOR LEGEND	
A. PANEL DOOR	
B. FIRE DOOR w/ SELF CLOSER (45 MIN)	
C. FIRE DOOR w/ SELF CLOSER (20 MIN)	
D. EXTERIOR DOOR	
E. BIFOLD CLOSET	
F. SLIDING DOOR	
G. POCKET DOOR	

NOTE: ALL SMOKE ALARMS TO BE INTERCONNECTED



LEAD DESIGNER & CONSULTANT
KEN BEKENDAM
kenbekendam@gmail.com
C: (905)-961-0647
(855) - KINGHMS (546-4467)
LEAD ENGINEER
ROBERT MENDEZ P. ENG. 100054193
robertmendez@yahoo.com
C: (416)-807-1572
www.legalsecondsuites.com



ADDRESS:
13 GIBSON AVENUE
HAMILTON, ON.
PROPOSED SECOND FLOOR
UNIT #2

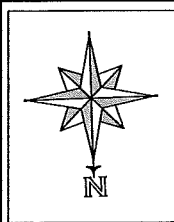

SCALE:
1/4" = 1'
PROJECT:
2 UNIT
CONVERSION

DATE:
SEPT 2020
SHEET#:
A1.07

SPRAY FOAM DETAIL

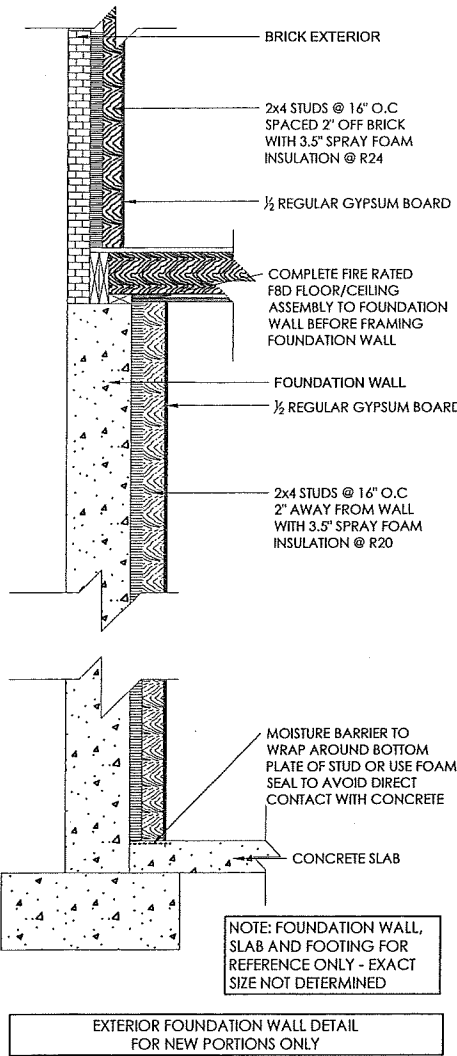

BATT INSULATION DETAIL

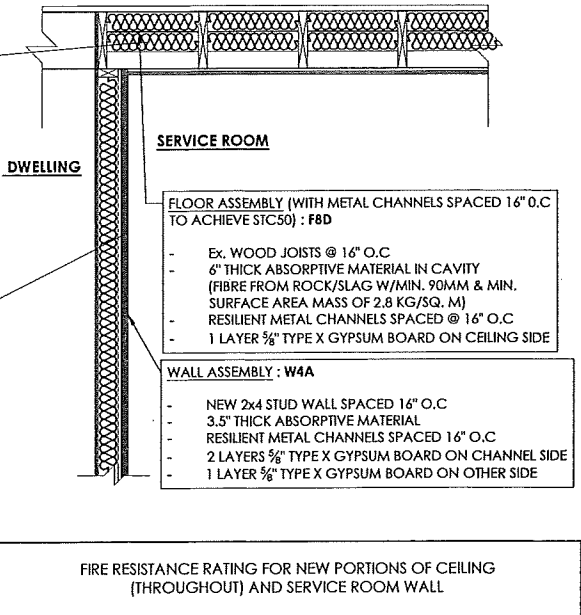
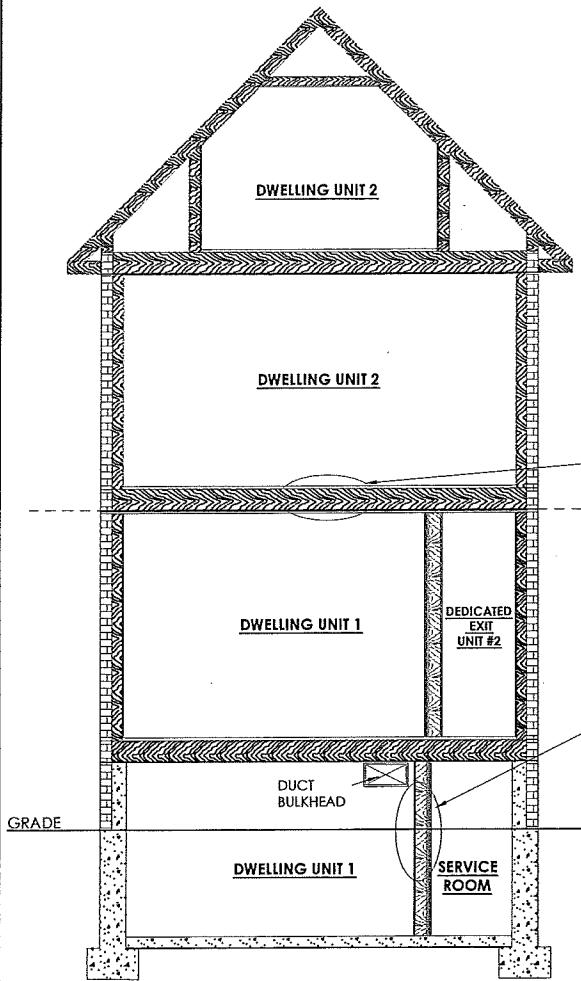
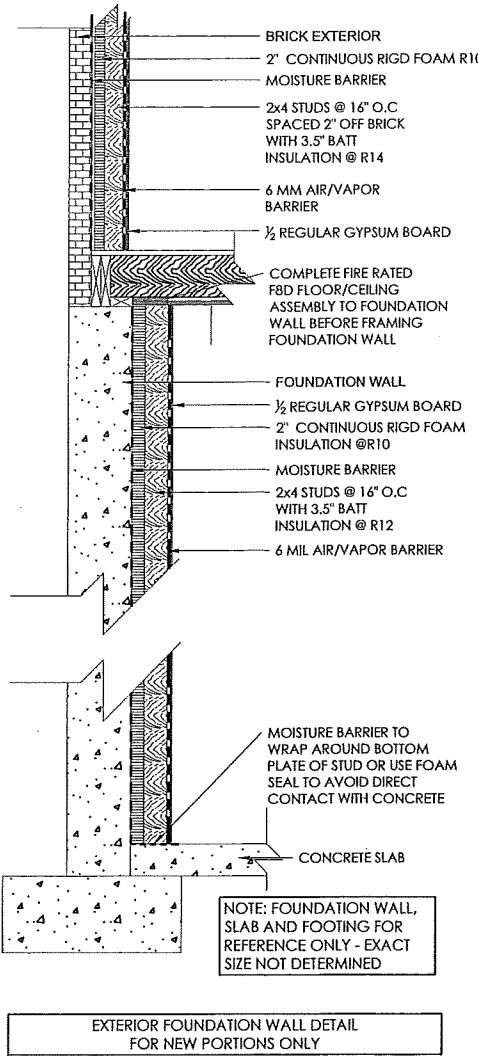

LEAD DESIGNER &
CONSULTANT

KEN BEKENDAM
kenbekendam@gmail.com
C: (905)-961-0647
(855) - KINGHMS (546-4467)

LEAD ENGINEER

ROBERT MENDEZ P. ENG. 100054193
robertmendez@yahoo.com
C: (416)-807-1572

www.legalsecondsuites.com



ADDRESS:

13 GIBSON AVENUE
HAMILTON, ON.

CROSS SECTION 1 OF 2



SCALE:

-

PROJECT:

2 UNIT
CONVERSION

DATE:

SEPT 2020

SHEET#:

A4.01

2 UNIT CONVERSION

13 GIBSON AVENUE - HAMILTON, ON.



EXISTING BUILDING IMAGE

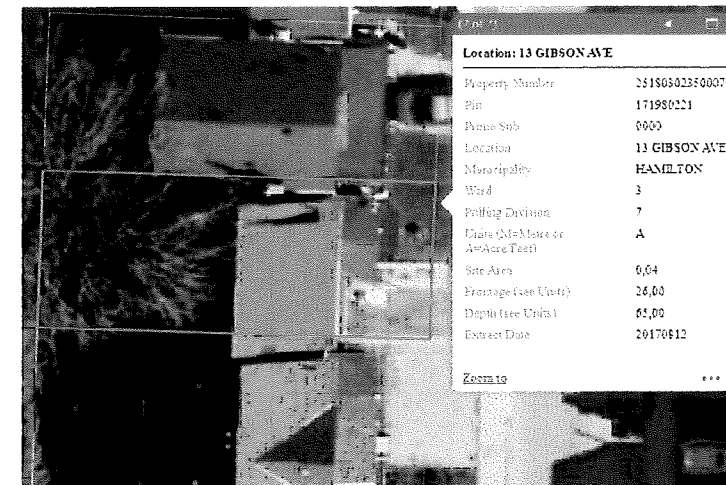

AERIAL MAP

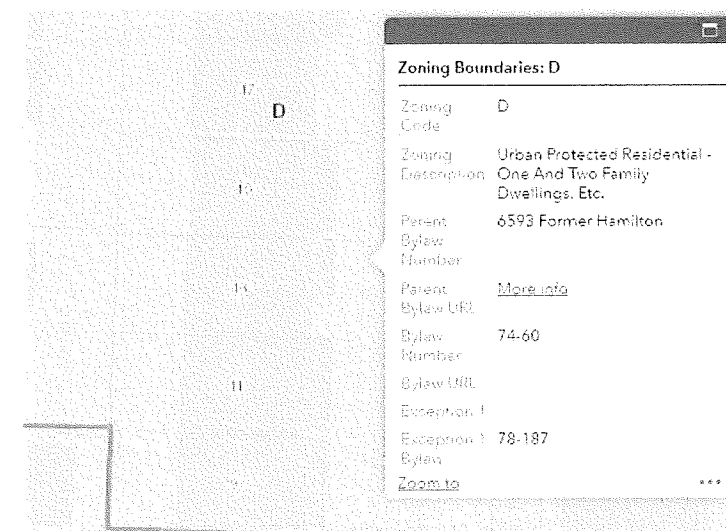

ZONING MAP



LEAD DESIGNER &
CONSULTANT

KEN BEKENDAM
kenbekendam@gmail.com
C: (905)-961-0647
(855) - KINGHMS (546-4467)

LEAD ENGINEER

ROBERT MENDEZ P. ENG. 100054193
robertmendez@yahoo.com
C: (416)-807-1572

www.legalsecondsuites.com



**LEGAL
SECOND
SUITES**

ADDRESS:

**13 GIBSON AVENUE
HAMILTON, ON.**

TITLE PAGE

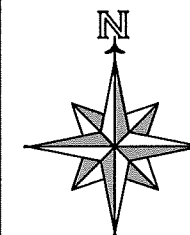

SCALE:

-

PROJECT:

**2 UNIT
CONVERSION**

DATE:

SEPT 2020

SHEET#:

A0.01

SITE INFORMATION & STATISTICS			
ADDRESS	13 GIBSON AVENUE - HAMILTON - ON.		
ZONING TYPE	D		
LOT AREA	157.00 SQ M (1690.00 SQ FT)		
LOT FRONTAGE	7.92m (26.00')		
FLOOR AREAS	ALLOWED	EXISTING	PROPOSED
BASEMENT			NO CHANGE
MAIN FLOOR			NO CHANGE
SECOND FLOOR			NO CHANGE
THIRD FLOOR			NO CHANGE
SETBACKS			
FRONT			NO CHANGE
SIDE			NO CHANGE
BACK			NO CHANGE
SIDE			NO CHANGE

- GENERAL NOTES:
1. ALL CONSTRUCTION TO COMPLY WITH THE REVISED ONTARIO BUILDING CODE 2012.
 2. ALL DIMENSIONS ARE MEASURED TO ROUGH FRAMING OR TO MASONRY SURFACES UNLESS OTHERWISE NOTED.
 3. ALL DOORS AND WINDOW OPENINGS ARE MEASURED TO ROUGH FRAMING OR MASONRY OPENINGS.
 4. CONTRACTOR IS TO VERIFY WINDOW OPENINGS WITH WINDOW MANUFACTURER PRIOR TO COMMENCING WORK.
 5. READ ARCHITECTURAL DRAWINGS IN CONJUNCTION WITH STRUCTURAL, MECHANICAL AND ELECTRICAL DRAWINGS.
 6. ELEVATION REFERENCES ARE BASED ON 100'-0" = 131.70m GEODETIC ELEVATIONS AS NOTED ON A1 SITE PLAN.
 7. ALL DIMENSIONS MUST BE CHECKED AGAINST THE ARCHITECTURAL DRAWINGS AND THE FIELD CONDITIONS BEFORE COMMENCING FABRICATION. AND INCONSISTENCIES ARE TO BE REPORTED TO THE CONSULTANT BEFORE PROCEEDING WITH THE WORK.
 8. THE CONTRACTOR SHALL PROPERLY SUPERVISE THE WORK AND ENSURE THAT THE WORK IS INSTALLED TO THE CORRECT LINES AND LEVELS, THAT THE CONNECTIONS AND DETAILS CONFIRM TO THE DRAWING DETAILS AND SHALL COORDINATE THE INTERFACING OF ALL WORK WITH ALL SUB-TRADES.
 9. PROVIDE POSITIVE FRONT YARD SLOPE TO MUNICIPAL SEWER FOR WATER RUN-OFF.
 10. CONTRACTOR TO BE RESPONSIBLE FOR VERIFYING THE LOCATIONS OF ALL EXISTING UNDERGROUND AND ABOVE UTILITIES AND SERVICES. VARIOUS UTILITIES CONCERNED TO BE GIVEN REQUIRED ADVANCING NOTICE PRIOR TO ANY DIGGING, FOR STAKE OUT.
 11. REFER TO LANDSCAPING PLAN FOR PLANTING CONFIRM LAYOUT WITH LANDSCAPE CONTRACTOR
 12. DESIGNER NOT RESPONSIBLE FOR ACCURACY OF SURVEY DRAWING.

EXISTING STRUCTURE NOTE:
OWNER AND CONTRACTOR IS FULLY RESPONSIBLE FOR VERIFYING ALL EXISTING STRUCTURAL CONDITIONS PRIOR TO ANY WORK, ANY AND ALL DISCREPANCIES SHALL BE REPORTED TO THE OWNER PRIOR TO ANY WORK, OWNER AND CONTRACTOR IS FULLY RESPONSIBLE FOR SHORING EXISTING STRUCTURE PRIOR TO ANY WORK.

BUILDING CODE COMPLIANCE NOTE:
THESE DRAWINGS DO NOT REPRESENT A COMPREHENSIVE AND EXHAUSTIVE GUIDE FOR COMPLIANCE WITH THE ONTARIO BUILDING CODE. IT IS ASSUMED THAT THE CONTRACTOR HAS REASONABLY SUFFICIENT KNOWLEDGE OF THE ONTARIO BUILDING CODE IN ORDER TO PERFORM ALL WORK AS PER THESE DRAWINGS IN SUCH A WAY THAT WILL COMPLY WITH ALL ASPECTS OF THE O.B.C. AND WILL NOT CONTRAVENE ANY OTHER APPLICABLE LAWS.

SITE PLAN:
BASED ON HAMILTON SITE MAPS AND MEASUREMENTS ON SITE
DESIGNER ASSUMES NO RESPONSIBILITY FOR ACCURACY OF HAMILTON MAPS.
THIS SITE SHALL NOT BE USED FOR ANY OTHER PURPOSES.
NO WORK TO ENCROACH ONTO ADJOINING PROPERTIES

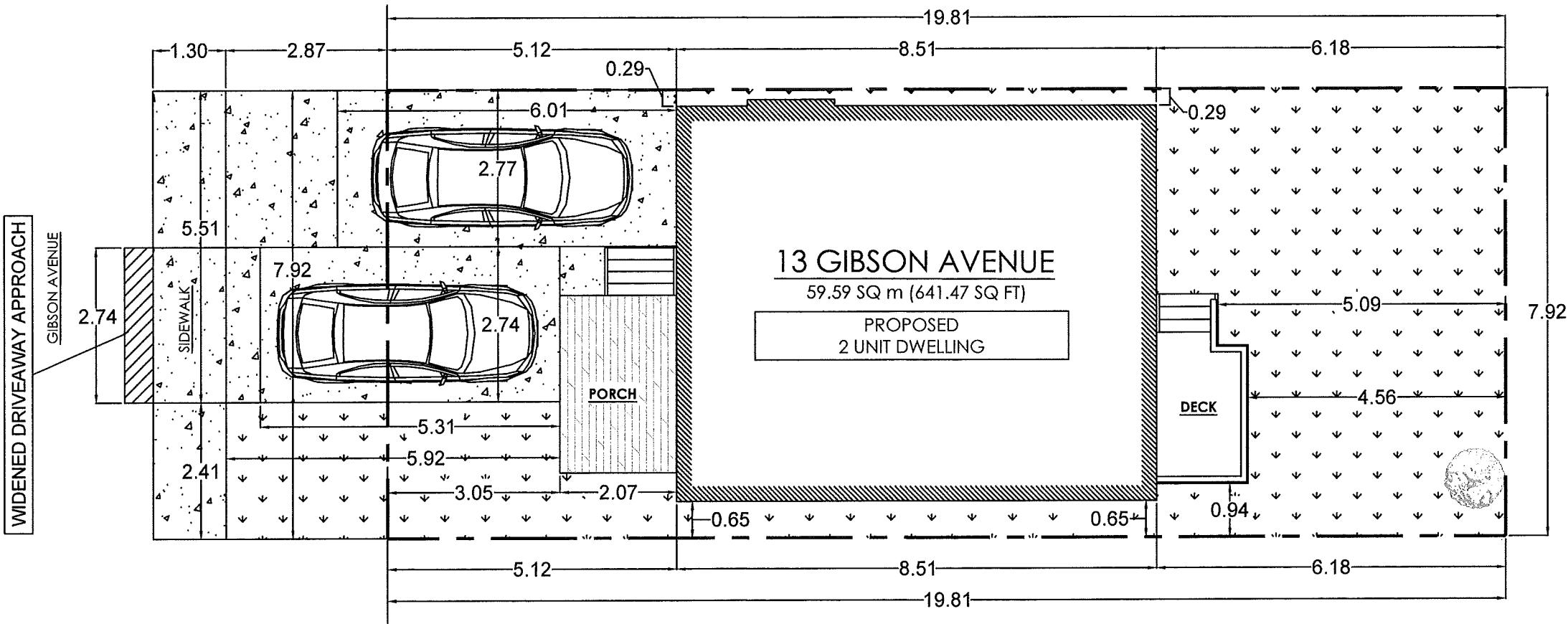



KING HOMES
DESIGN | BUILD | MANAGE

LEAD DESIGNER & CONSULTANT

KEN BEKENDAM
kenbekendam@gmail.com
C: (905)-961-0647
(855) - KINGHMS (546-4467)

LEAD ENGINEER

ROBERT MENDEZ P. ENG. 100054193
robertmendez@yahoo.com
C: (416)-807-1572



**LEGAL
SECOND
SUITES**

www.legalsecondsuites.com

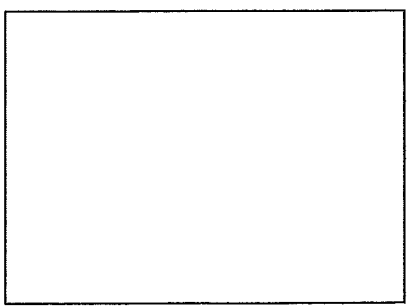

ADDRESS:

**13 GIBSON AVENUE
HAMILTON, ON.**

SITE PLAN METRIC

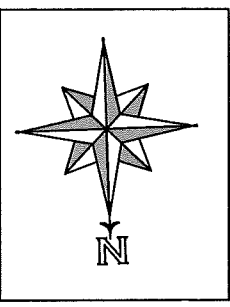

SCALE:

$\frac{1"}{8} = 1'$

PROJECT:

**2 UNIT
CONVERSION**

DATE:

SEPT 2020

SHEET#:

SP1.01

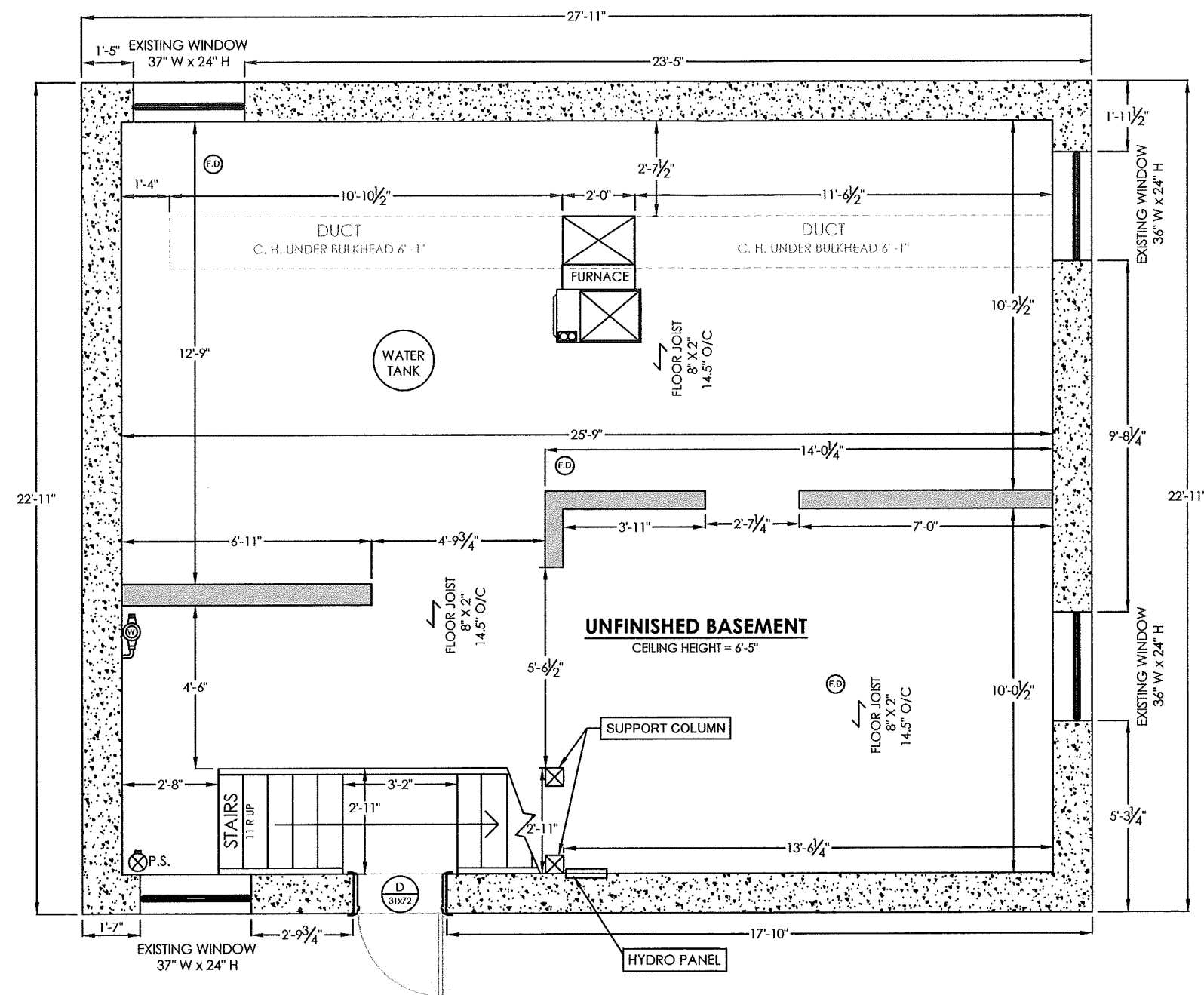

PLANS LEGEND	
	BATH
	EXHAUST FAN
	SPECIFICATION TAG
	SMOKE ALARM
	CARBON MONOXIDE ALARM
	CEILING HEIGHT
	STRUCTURAL BEAM OR WALL
	PLUMBING STACK
	WATER METER
	FLOOR DRAIN
	STRUCTURAL COLUMN
	FOUNDATION WALL
	EXISTING EXTERIOR WALLS
	NEW EXTERIOR WALLS
	EXISTING INTERIOR WALLS
	NEW INTERIOR WALLS
	STRUCTURAL WALLS
	NEW STRUCTURAL BEAMS
	WINDOWS
	SUPPLY REGISTER
	RETURN GRILLE
DOOR LEGEND	
	DOOR TYPE DOOR SIZE
A.	PANEL DOOR
B.	FIRE DOOR w/ SELF CLOSER (45 MIN)
C.	FIRE DOOR w/ SELF CLOSER (20 MIN)
D.	EXTERIOR DOOR
E.	BIFOLD CLOSET
F.	SLIDING DOOR
G.	POCKET DOOR



LEAD DESIGNER &
CONSULTANT

KEN BEKENDAM
kenbekendam@gmail.com
C: (905)-961-0647
(855) - KINGHMS (546-4467)

LEAD ENGINEER

ROBERT MENDEZ P. ENG. 100054193
robertmendez@yahoo.com
C: (416)-807-1572

www.legalsecondsuites.com



LEGAL
SECOND
SUITES

ADDRESS:

13 GIBSON AVENUE
HAMILTON, ON.

EXISTING BASEMENT

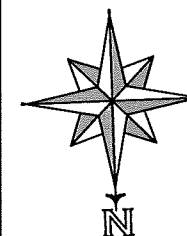

SCALE:

$\frac{1}{4}" = 1'$

PROJECT:

2 UNIT
CONVERSION

DATE:

SEPT 2020

SHEET#:

A1.01

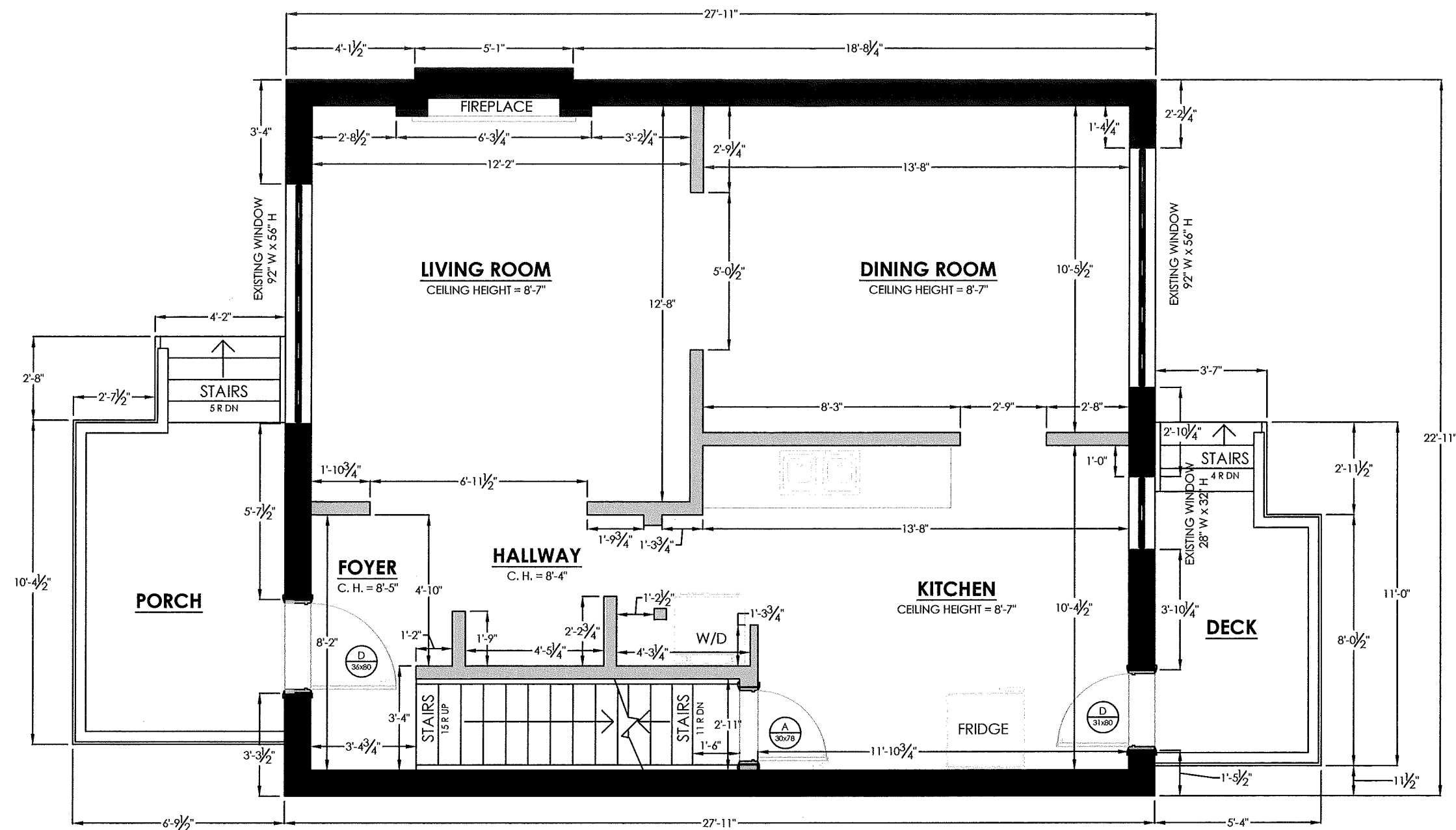

PLANS LEGEND	
BATH	ROOM NAME
E.F.	EXHAUST FAN
2	SPECIFICATION TAG
SA	SMOKE ALARM
C.M.A.	CARBON MONOXIDE ALARM
C.H. = 8'-10"	CEILING HEIGHT
	STRUCTURAL BEAM OR WALL
P.S.	PLUMBING STACK
	WATER METER
F.D.	FLOOR DRAIN
	STRUCTURAL COLUMN
	FOUNDATION WALL
	EXISTING EXTERIOR WALLS
	NEW EXTERIOR WALLS
	EXISTING INTERIOR WALLS
	NEW INTERIOR WALLS
	STRUCTURAL WALLS
	NEW STRUCTURAL BEAMS
	WINDOWS
SUPPLY	SUPPLY REGISTER
RETURN	RETURN GRILLE
DOOR LEGEND	
A	DOOR TYPE
30x60	DOOR SIZE
A. PANEL DOOR	
B. FIRE DOOR w/ SELF CLOSER (45 MIN)	
C. FIRE DOOR w/ SELF CLOSER (20 MIN)	
D. EXTERIOR DOOR	
E. BIFOLD CLOSET	
F. SLIDING DOOR	
G. POCKET DOOR	



DESIGN | BUILD | MANAGE

LEAD DESIGNER & CONSULTANT

KEN BEKENDAM
kenbekendam@gmail.com
C: (905)-961-0647
(855) - KINGHMS (546-4467)

LEAD ENGINEER

ROBERT MENDEZ P. ENG. 100054193
robertmendez@yahoo.com
C: (416)-807-1572



LEGAL
SECOND
SUITES

www.legalsecondsuites.com

ADDRESS:

13 GIBSON AVENUE
HAMILTON, ON.

EXISTING GROUND FLOOR

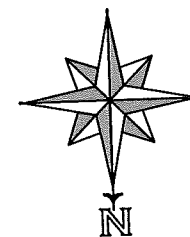

SCALE:

1/4" = 1'

PROJECT:

2 UNIT
CONVERSION

DATE:

SEPT 2020

SHEET#:

A1.02

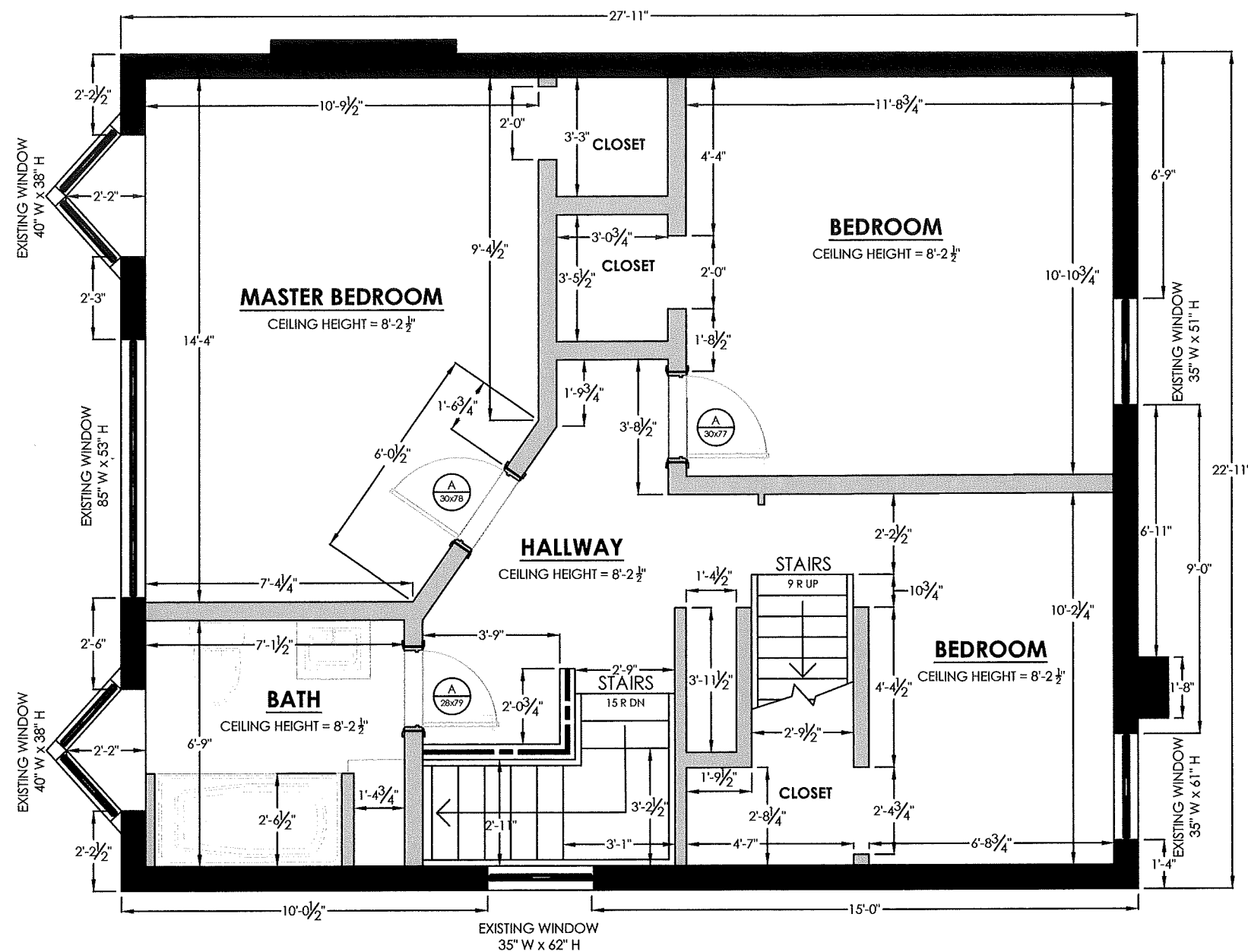

BATH	ROOM NAME
E.F.	EXHAUST FAN
2	SPECIFICATION TAG
SA	SMOKE ALARM
C.M.A.	CARBON MONOXIDE ALARM
C.H. = 8'-10'	CEILING HEIGHT
	STRUCTURAL BEAM OR WALL
P.S.	PLUMBING STACK
	WATER METER
F.D.	FLOOR DRAIN
	STRUCTURAL COLUMN
	FOUNDATION WALL
	EXISTING EXTERIOR WALLS
	NEW EXTERIOR WALLS
	EXISTING INTERIOR WALLS
	NEW INTERIOR WALLS
	STRUCTURAL WALLS
	NEW STRUCTURAL BEAMS
	WINDOWS
SUPPLY	SUPPLY REGISTER
RETURN	RETURN GRILLE
A-30x60	DOOR TYPE DOOR SIZE
A. PANEL DOOR B. FIRE DOOR w/ SELF CLOSER (45 MIN) C. FIRE DOOR w/ SELF CLOSER (20 MIN) D. EXTERIOR DOOR E. BIFOLD CLOSET F. SLIDING DOOR G. POCKET DOOR	

DOOR LEGEND



KING HOMES
DESIGN | BUILD | MANAGE

LEAD DESIGNER &
CONSULTANT

KEN BEKENDAM
kenbekendam@gmail.com
C: (905)-961-0647
(855) - KINGHMS (546-4467)

LEAD ENGINEER

ROBERT MENDEZ P. ENG. 100054193
robertmendez@yahoo.com
C: (416)-807-1572

www.legalsecondsuites.com



**LEGAL
SECOND
SUITES**

ADDRESS:

**13 GIBSON AVENUE
HAMILTON, ON.**

EXISTING SECOND FLOOR

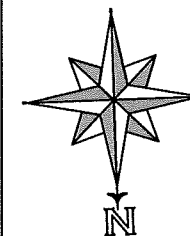

SCALE:

$\frac{1}{4}" = 1'$

PROJECT:

**2 UNIT
CONVERSION**

DATE:

SEPT 2020

SHEET#:

A1.03

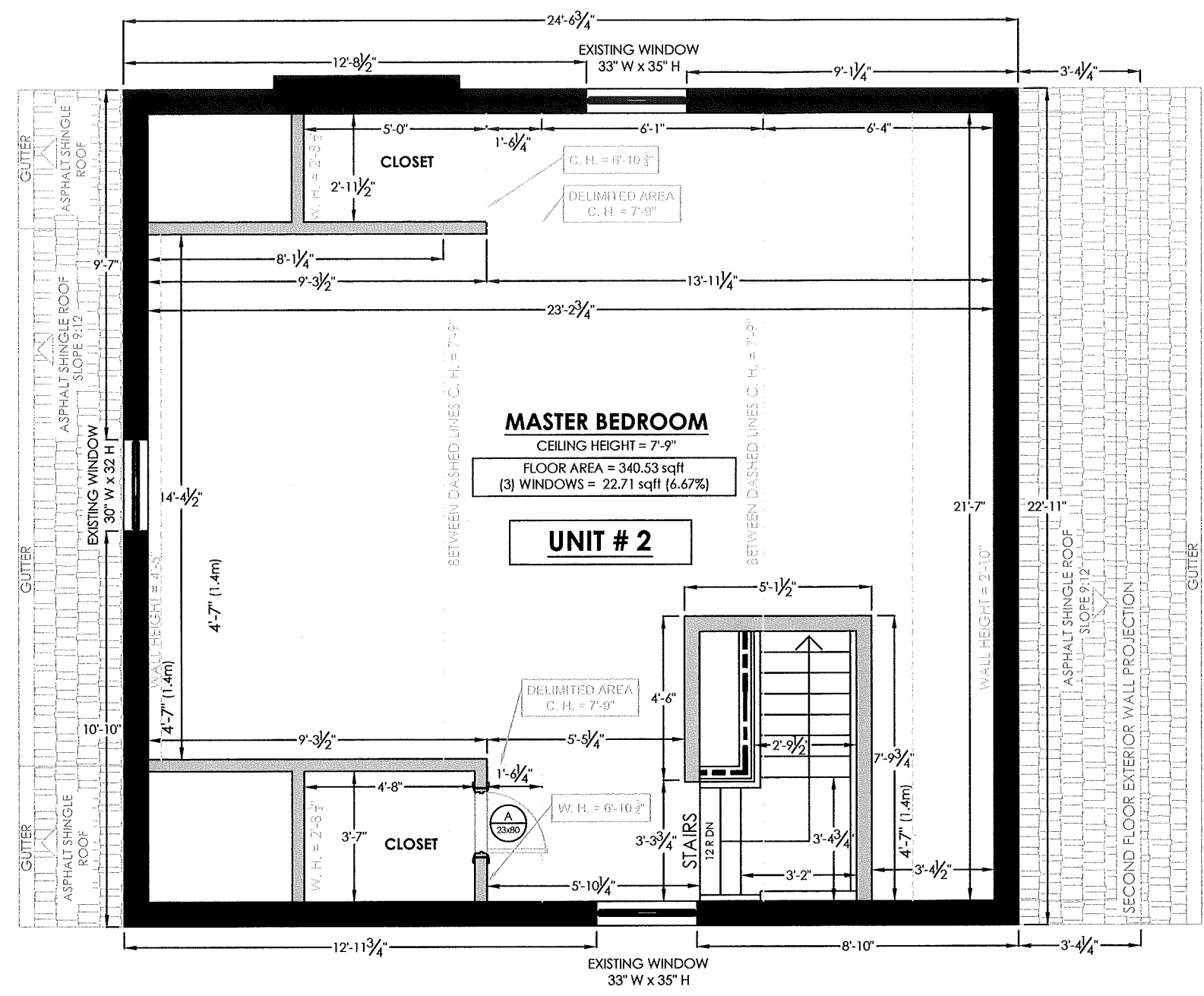

NOTE: NO CHANGES TO THIS FLOOR

NOTE: ALL SMOKE ALARMS
TO BE INTERCONNECTED

PLANS LEGEND	BATH	ROOM NAME
	[E.F.]	EXHAUST FAN
	[2]	SPECIFICATION TAG
	[SA]	SMOKE ALARM
	[C.M.A.]	CARBON MONOXIDE ALARM
	C.H. = 8'-10"	CEILING HEIGHT
	[S.B.]	STRUCTURAL BEAM OR WALL
	[P.S.]	PLUMBING STACK
	[W.M.]	WATER METER
	[F.D.]	FLOOR DRAIN
	[S.C.]	STRUCTURAL COLUMN
	[F.W.]	FOUNDATION WALL
	[E.E.W.]	EXISTING EXTERIOR WALLS
	[N.E.W.]	NEW EXTERIOR WALLS
	[E.I.W.]	EXISTING INTERIOR WALLS
DOOR LEGEND	[N.I.W.]	NEW INTERIOR WALLS
	[S.W.]	STRUCTURAL WALLS
	[N.S.B.]	NEW STRUCTURAL BEAMS
	[W.]	WINDOWS
	[S.R.]	SUPPLY REGISTER
	[R.G.]	RETURN GRILLE
	[A]	DOOR TYPE
	[30x60]	DOOR SIZE
	A. PANEL DOOR	
	B. FIRE DOOR w/ SELF CLOSER (45 MIN)	
	C. FIRE DOOR w/ SELF CLOSER (20 MIN)	
	D. EXTERIOR DOOR	
	E. BIFOLD CLOSET	
	F. SLIDING DOOR	
	G. POCKET DOOR	



KING HOMES
DESIGN | BUILD | MANAGE

LEAD DESIGNER & CONSULTANT

KEN BEKENDAM
kenbekendam@gmail.com
C: (905)-961-0647
(855) - KINGHMS (546-4467)

LEAD ENGINEER

ROBERT MENDEZ P. ENG. 100054193
robertmendez@yahoo.com
C: (416)-807-1572

LEGAL SECOND SUITES

www.legalsecondsuites.com

ADDRESS:

**13 GIBSON AVENUE
HAMILTON, ON.**

**EXISTING / PROPOSED ATTIC
UNIT #2**

SCALE:

1/4" = 1'

PROJECT:

**2 UNIT
CONVERSION**

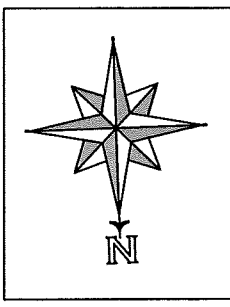

DATE:

SEPT 2020

SHEET#:

A1.04

DATE:

SEPT 2020

SHEET#:

A1.04

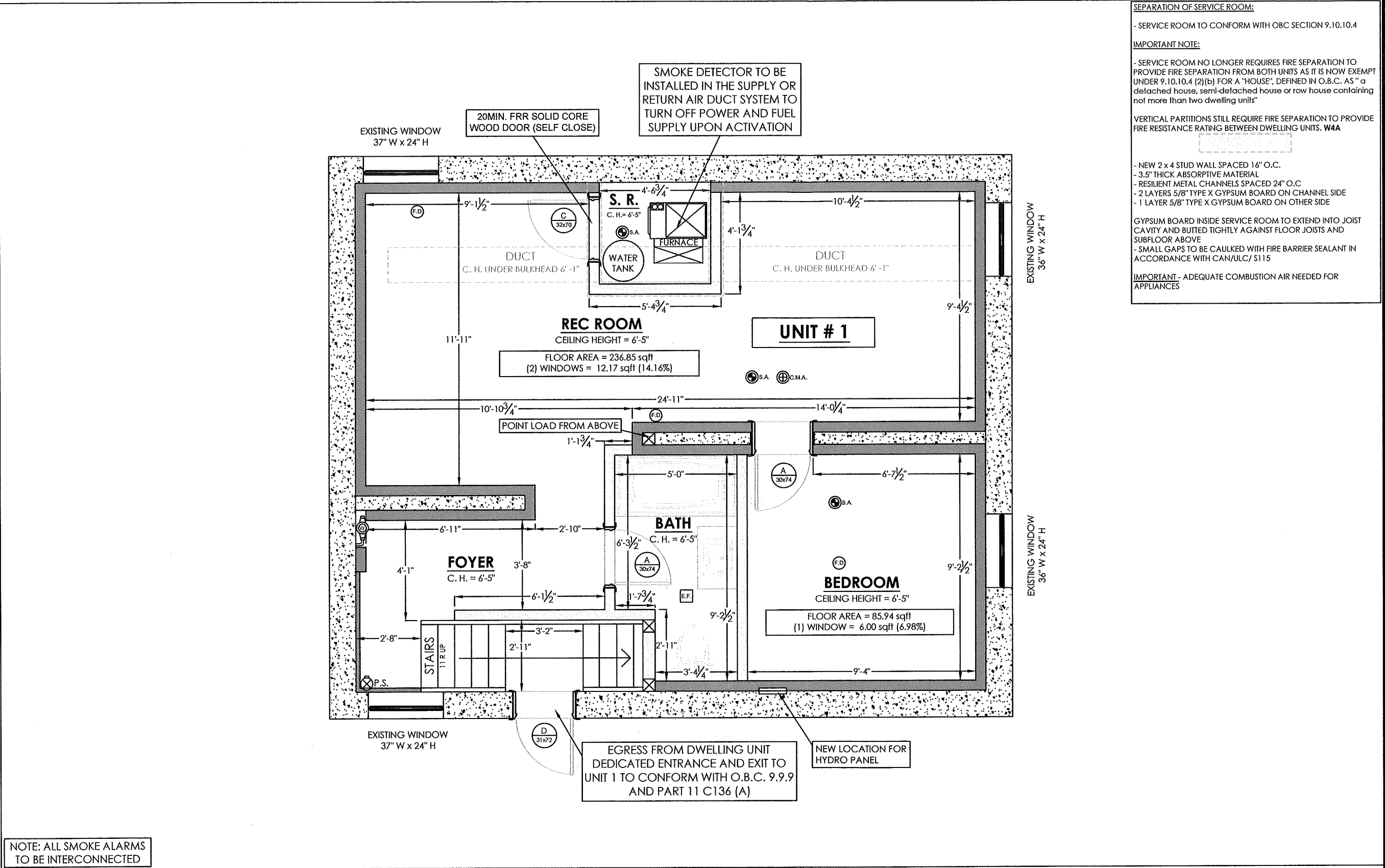

SEPARATION OF SERVICE ROOM:

- SERVICE ROOM TO CONFORM WITH OBC SECTION 9.10.10.4

IMPORTANT NOTE:

- SERVICE ROOM NO LONGER REQUIRES FIRE SEPARATION TO PROVIDE FIRE SEPARATION FROM BOTH UNITS AS IT IS NOW EXEMPT UNDER 9.10.10.4 (2)(b) FOR A "HOUSE", DEFINED IN O.B.C. A5 "a detached house, semi-detached house or row house containing not more than two dwelling units"

VERTICAL PARTITIONS STILL REQUIRE FIRE SEPARATION TO PROVIDE FIRE RESISTANCE RATING BETWEEN DWELLING UNITS. **W4A**

NEW 2 x 4 STUD WALL SPACED 16" O.C.

- 3.5" THICK ABSORPTIVE MATERIAL
- RESILIENT METAL CHANNELS SPACED 24" O.C
- 2 LAYERS 5/8" TYPE X GYPSUM BOARD ON CHANNEL SIDE
- 1 LAYER 5/8" TYPE X GYPSUM BOARD ON OTHER SIDE

GYPSUM BOARD INSIDE SERVICE ROOM TO EXTEND INTO JOIST CAVITY AND BUTTED TIGHTLY AGAINST FLOOR JOISTS AND SUBFLOOR ABOVE

- SMALL GAPS TO BE CAULKED WITH FIRE BARRIER SEALANT IN ACCORDANCE WITH CAN/ULC/ S115

IMPORTANT - ADEQUATE COMBUSTION AIR NEEDED FOR APPLIANCES

ELETRONIC STAMP	
PLANS LEGEND	BATH
	ROOM NAME
	EXHAUST FAN
	SPECIFICATION TAG
	SMOKE ALARM
	CARBON MONOXIDE ALARM
	CEILING HEIGHT
	STRUCTURAL BEAM OR WALL
	PLUMBING STACK
	WATER METER
	FLOOR DRAIN
	STRUCTURAL COLUMN
	FOUNDATION WALL
	EXISTING EXTERIOR WALLS
	NEW EXTERIOR WALLS
DOOR LEGEND	EXISTING INTERIOR WALLS
	NEW INTERIOR WALLS
	STRUCTURAL WALLS
	NEW STRUCTURAL BEAMS
	WINDOWS
	SUPPLY REGISTER
	RETURN GRILLE
	DOOR TYPE
	DOOR SIZE
	A. PANEL DOOR
	B. FIRE DOOR w/ SELF CLOSER (45 MIN)
	C. FIRE DOOR w/ SELF CLOSER (20 MIN)
	D. EXTERIOR DOOR
	E. BIFOLD CLOSET
	F. SLIDING DOOR
	G. POCKET DOOR



KING HOMES
DESIGN | BUILD | MANAGE

LEAD DESIGNER & CONSULTANT

KEN BEKENDAM
kenbekendam@gmail.com
C: (905)-961-0647
(855) - KINGHMS (546-4467)

LEAD ENGINEER

ROBERT MENDEZ P. ENG. 100054193
robertmendez@yahoo.com
C: (416)-807-1572

LEGAL SECOND SUITES

ADDRESS:

13 GIBSON AVENUE
HAMILTON, ON.

PROPOSED BASEMENT
UNIT #1

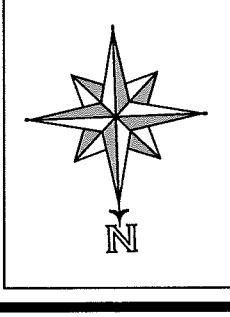

SCALE:

1/4" = 1'

PROJECT:

2 UNIT CONVERSION

DATE:

SEPT 2020

SHEET#:

A1.05

www.legalsecondsuites.com

A1.06

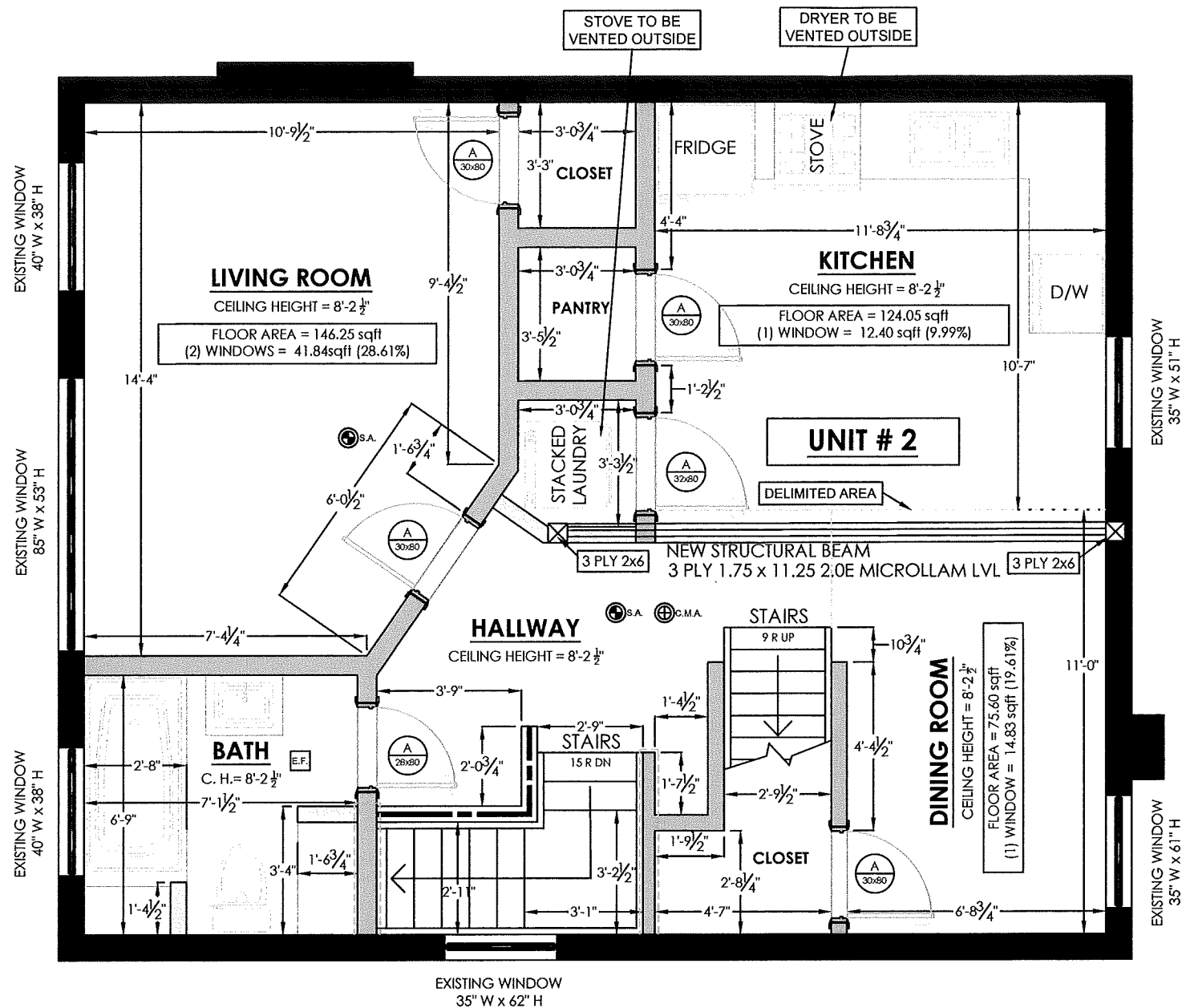

SEPARATION BETWEEN UNITS:

NEW SEPARATION BETWEEN UNITS TO HAVE A FIRE RESISTANCE RATING OF 30 MINS AS PER O.B.C. 9.10.9.14 AND PART 11 COMPLIANCE - C152 AND STC50

BASEMENT CEILING (SEPARATING SECOND SUITE: F8D NEW PORTIONS ONLY)

- EX. WOOD JOISTS @ 16" O.C.
- 6" THICK ABSORPTIVE MATERIAL IN CAVITY (FIBRE FROM ROCK/SLAG W/ MIN 90mm & MIN. SURFACE AREA MASS OF 2.8 KG/SQ. M)
- RESILIENT METAL CHANNELS SPACED @ 16" O.C.
- 1 LAYER 5/8" TYPE X GYPSUM BOARD ON CEILING SIDE

NEW SHARED PARTITIONS: W4A

- NEW 2 x 4 STUD WALL SPACED 16" O.C.
- 3.5" THICK ABSORPTIVE MATERIAL
- RESILIENT METAL CHANNELS SPACED 24" O.C.
- 2 LAYERS 5/8" TYPE X GYPSUM BOARD ON CHANNEL SIDE
- 1 LAYER 5/8" TYPE X GYPSUM BOARD ON OTHER SIDE

EXISTING SHARED PARTITIONS:

EX. 1/2" REGULAR GYPSUM BOARD TO REMAIN AS IS
- ADDITIONAL LAYER OF 5/8" TYPE X TO BE APPLIED OVER EXISTING

EX. LATH AND PLASTER TO REMAIN AS IS
- MEETS A 30 MIN FRR AS PER ONTARIO FIRE MARSHALL
- WITH INTERCONNECTED SMOKE DETECTORS IN EACH DWELLING UNIT

EXISTING CEILING (15 MIN FRR BETWEEN DWELLING UNITS)

- EX. 1/2" REGULAR GYPSUM BOARD OR PLASTER TO REMAIN
- AS PER PART 11 C143 1. HUD REHABILITATION GUIDELINES, "GUIDELINE ON FIRE RATINGS OF ARCHAIC MATERIALS AND ASSEMBLES"
- WITH INTERCONNECTED SMOKE DETECTORS IN EACH DWELLING UNIT

FOR PIPE AND WIRE PENETRATIONS:

- USE FIRE RATED FOAM TESTED IN ACCORDANCE WITH CAN/ULC-S115 (EG. HILTI FIRE FOAM CP 620 OR 3M FIRE BARRIER SEALANT CP 25WB+)

FOR HVAC DUCTING:

- ADDRESSED WITH IN-DUCT SMOKE DETECTOR:
- SEE NOTE NEAR FURNACE ON FLOOR PLAN

FOR SERVICE ITEMS IN FIRE SEPARATION (VALVES, METERS, ELECTRICAL BOXES, ETC.):

- USE ULC RATED FIRE-RATED ACCESS PANELS (MIN. 45 MINS.)

PLANS LEGEND	
BATH	ROOM NAME
E.F.	EXHAUST FAN
2	SPECIFICATION TAG
SA	SMOKE ALARM
C.M.A.	CARBON MONOXIDE ALARM
C.H. = 8'-10"	CEILING HEIGHT
	STRUCTURAL BEAM OR WALL
P.S.	PLUMBING STACK
	WATER METER
F.D.	FLOOR DRAIN
	STRUCTURAL COLUMN
	FOUNDATION WALL
	EXISTING EXTERIOR WALLS
	NEW EXTERIOR WALLS
	EXISTING INTERIOR WALLS
	NEW INTERIOR WALLS
	STRUCTURAL WALLS
	NEW STRUCTURAL BEAMS
	WINDOWS
SUPPLY	SUPPLY REGISTER
RETURN	RETURN GRILLE
DOOR LEGEND	
A	DOOR TYPE
30x80	DOOR SIZE
A. PANEL DOOR	
B. FIRE DOOR w/ SELF CLOSER (45 MIN)	
C. FIRE DOOR w/ SELF CLOSER (20 MIN)	
D. EXTERIOR DOOR	
E. BIFOLD CLOSET	
F. SLIDING DOOR	
G. POCKET DOOR	

NOTE: ALL SMOKE ALARMS TO BE INTERCONNECTED



LEAD DESIGNER & CONSULTANT
KEN BEKENDAM
kenbekendam@gmail.com
C: (905)-961-0647
(855) - KINGHMS (546-4467)

LEAD ENGINEER
ROBERT MENDEZ P. ENG. 100054193
robertmendez@yahoo.com
C: (416)-807-1572

www.legalsecondsuites.com



ADDRESS:
**13 GIBSON AVENUE
HAMILTON, ON.**

**PROPOSED SECOND FLOOR
UNIT #2**

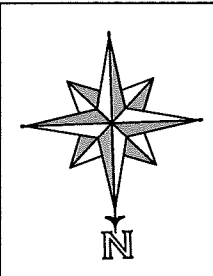

SCALE:
1/4" = 1'

PROJECT:
**2 UNIT
CONVERSION**

DATE:
SEPT 2020

SHEET#:
A1.07

SPRAY FOAM DETAIL

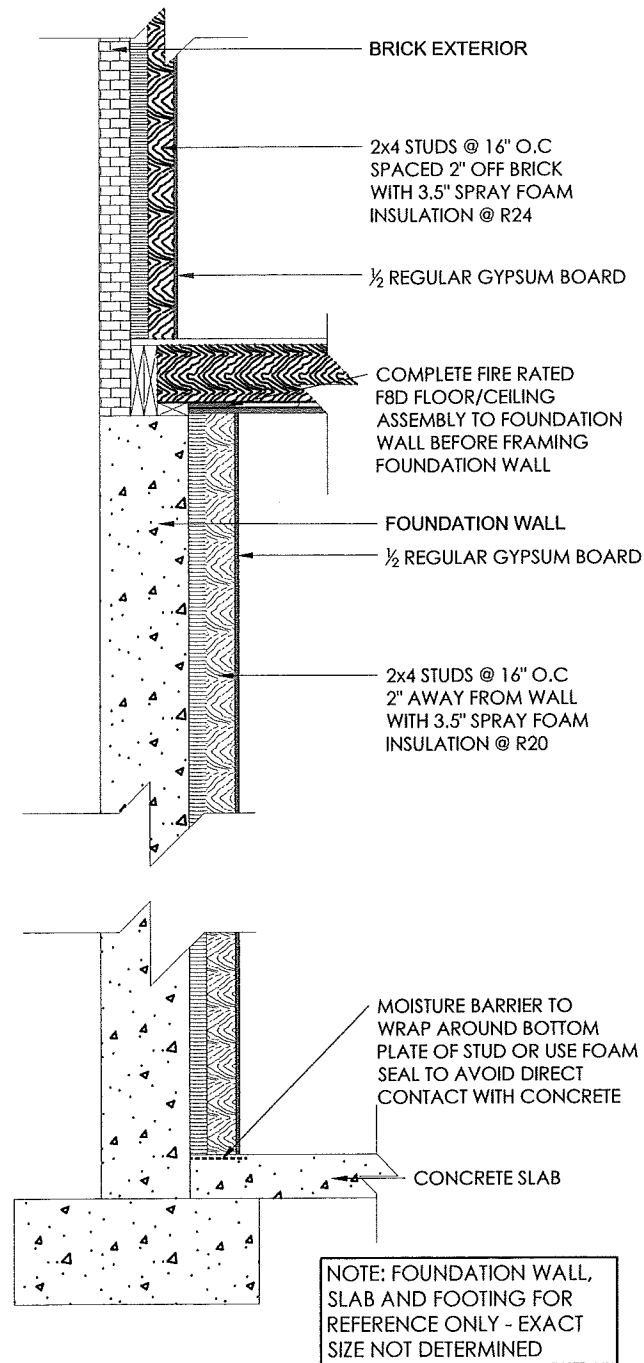

EXTERIOR FOUNDATION WALL DETAIL
FOR NEW PORTIONS ONLY

BATT INSULATION DETAIL

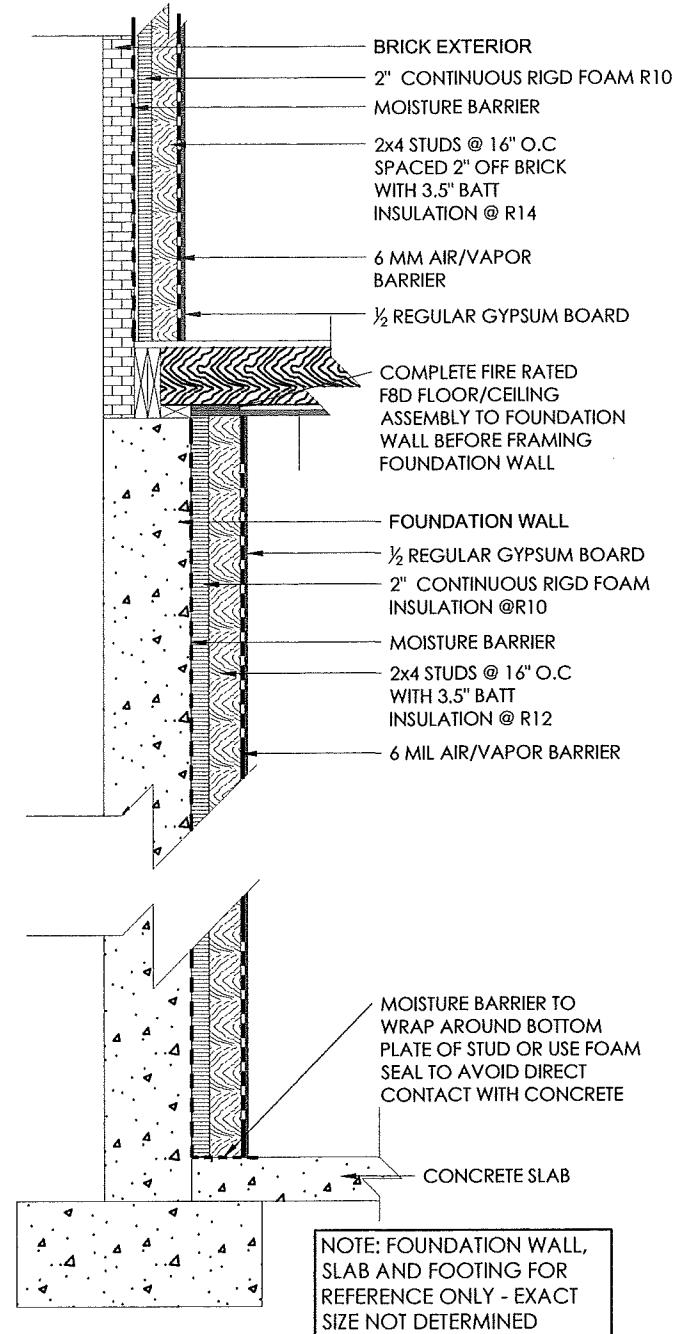

EXTERIOR FOUNDATION WALL DETAIL
FOR NEW PORTIONS ONLY

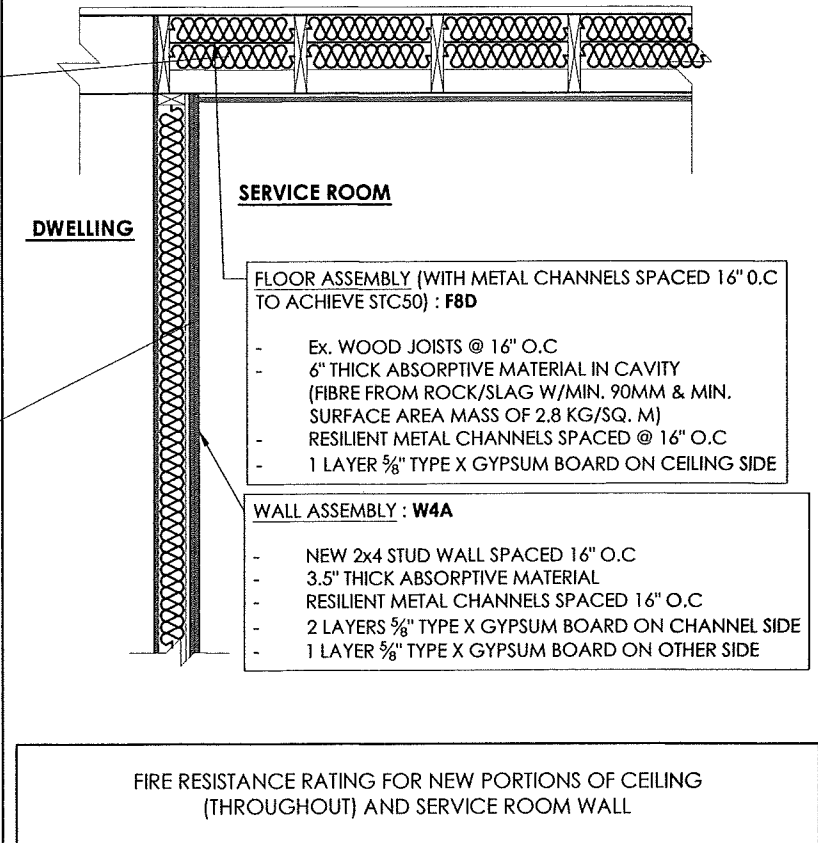
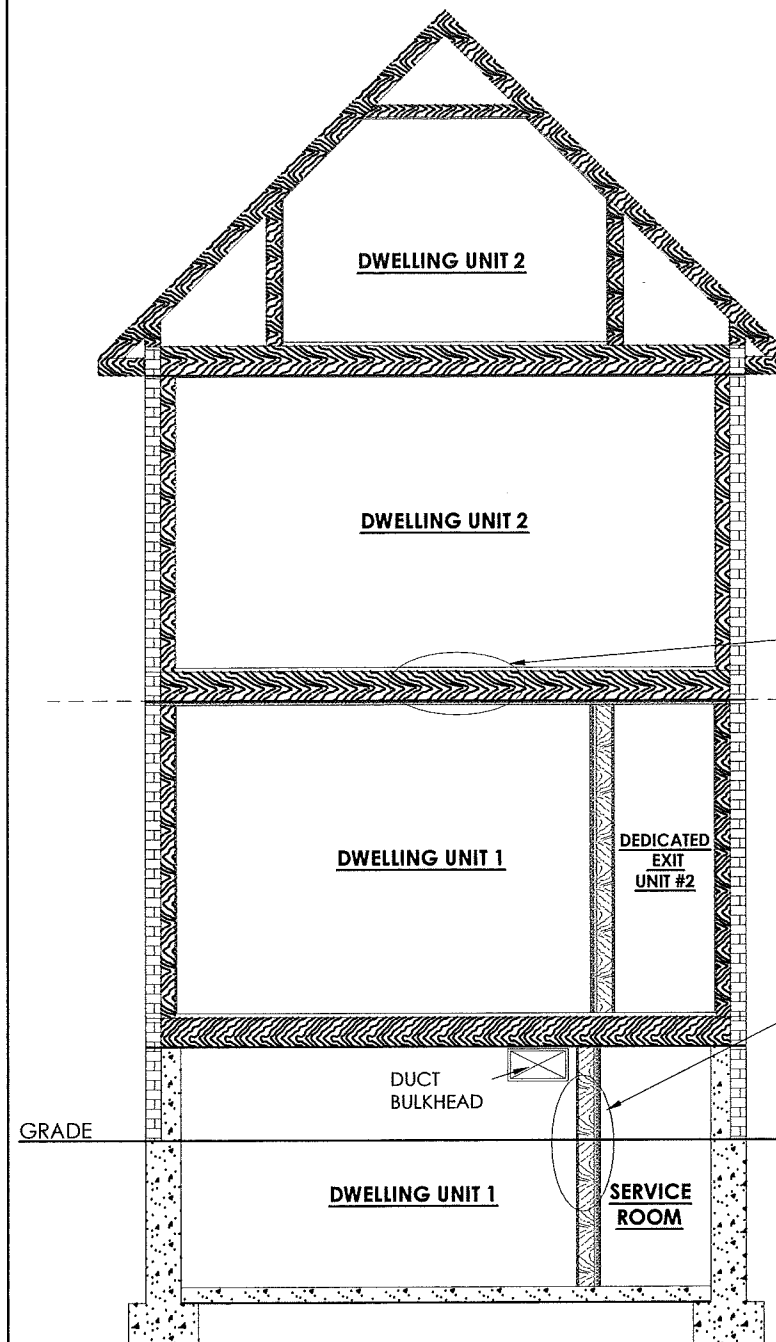

LEAD DESIGNER &
CONSULTANT

KEN BEKENDAM
kenbekendam@gmail.com
C: (905)-961-0647
(855) - KINGHMS (546-4467)

LEAD ENGINEER

ROBERT MENDEZ P. ENG. 100054193
robertmendez@yahoo.com
C: (416)-807-1572

www.legalsecondsuites.com



LEGAL
SECOND
SUITES

ADDRESS:

13 GIBSON AVENUE
HAMILTON, ON.

CROSS SECTION 1 OF 2

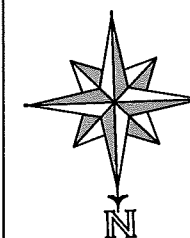

SCALE:

PROJECT:

2 UNIT
CONVERSION

DATE:

SEPT 2020

SHEET#:

A4.01

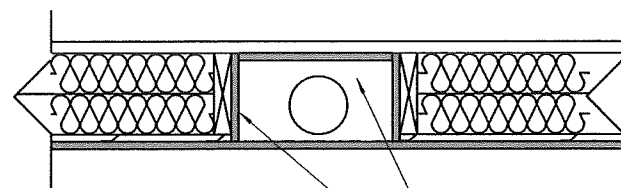

1 LAYER $\frac{5}{8}$ " TYPE X GYPSUM BOARD SURROUNDING VENT PIPE
NOTE: OPTION OF USING FIRE DAMPER FOR BATH FANS

FOR VENTS (BATH FANS, KITCHEN EXHAUSTS, & CLOTHES DRYERS)

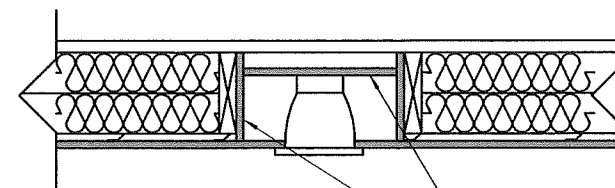

1 LAYER $\frac{5}{8}$ " TYPE X GYPSUM BOARD SURROUNDING RECESSED LIGHTING (POTLIGHTS)

FOR RECESSED LIGHTS

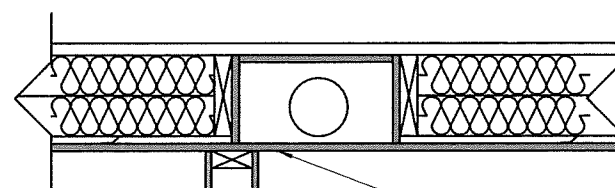

GYPSUM BOARD OF FIRE RATED CEILING TO BE CONTINUOUS ABOVE INTERIOR FRAMED WALLS

$\frac{1}{2}$ " REGULAR GYPSUM BOARD

FOR INTERIOR PARTITIONS

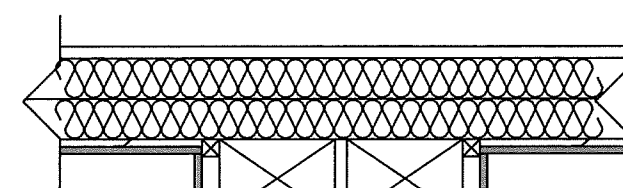

1 LAYER OF $\frac{5}{8}$ " TYPE X GYPSUM BOARD BELOW AND AROUND DUCTS

FOR DUCTS

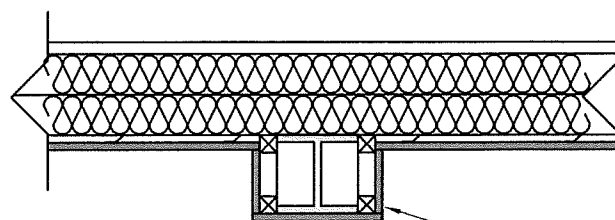

1 LAYER OF $\frac{5}{8}$ " TYPE X GYPSUM BOARD AROUND BEAM

FOR BEAM

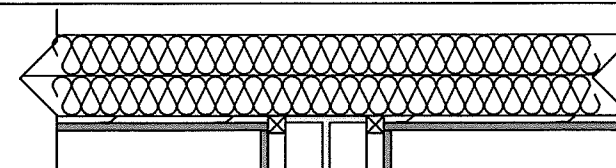

1 LAYER OF $\frac{5}{8}$ " TYPE X GYPSUM BOARD AROUND BEAM AND COLUMN CONNECTION

FOR STRUCTURAL BEAMS, COLUMNS & WALLS



KING HOMES
DESIGN | BUILD | MANAGE

LEAD DESIGNER & CONSULTANT

KEN BEKENDAM
kenbekendam@gmail.com
C: (905)-961-0647
(855) - KINGHMS (546-4467)



**LEGAL
SECOND
SUITES**

LEAD ENGINEER ROBERT MENDEZ P. ENG. 100054193
robertmendez@yahoo.com

C: (416)-807-1572

www.legalsecondsuites.com

ADDRESS:

**13 GIBSON AVENUE
HAMILTON, ON.**

CROSS SECTION 2 OF 2

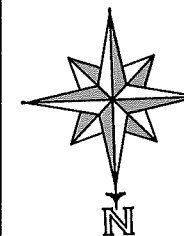

SCALE:

-

PROJECT:

**2 UNIT
CONVERSION**

DATE:

SEPT 2020

SHEET#:

A4.02

GENERAL NOTES:

- ALL CONSTRUCTION TO COMPLY WITH THE CURRENT ONTARIO BUILDING CODE (REVISED 2012 OBC – DEC 19, 2017).
 - ALL DIMENSIONS ARE MEASURED TO ROUGH FRAMING, MASONRY, OR CONCRETE SURFACES U.O.N.
 - ALL DOORS AND WINDOW OPENINGS ARE MEASURED TO ROUGH FRAMING OR MASONRY OPENING.
 - CONTRACTOR SHALL VERIFY WINDOW OPENINGS WITH THE MANUFACTURER PRIOR TO WORK.
 - READ ARCHITECTURAL DRAWINGS IN CONJUNCTION WITH ELECTRICAL PLANS SUPPLIED BY LICENSED ELECTRICAL CONTRACTOR.
 - ALL DIMENSIONS MUST BE CHECKED AGAINST THE ARCHITECTURAL DRAWINGS AND FIELD CONDITIONS BEFORE COMMENCING FABRICATION.
 - THE CONTRACTOR SHALL PROPERLY SUPERVISE THE WORK AND ENSURE THAT THE WORK IS INSTALLED TO THE CORRECT LINES AND LEVELS, THAT THE CONNECTIONS AND DETAILS CONFORM TO THE DRAWING DETAILS AND SHALL COORDINATE THE INTERFACING OF ALL WORK WITH ALL SUB-TRADES.
 - PROVIDE POSITIVE FRONT YARD SLOPE TO MUNICIPAL SEWER FOR WATER RUN-OFF.
 - CONTRACTOR TO BE RESPONSIBLE FOR VERIFYING THE LOCATIONS OF ALL EXISTING UNDERGROUND AND ABOVE UTILITIES AND SERVICES. VARIOUS UTILITIES CONCERNED TO BE GIVEN REQUIRED ADVANCE NOTICE PRIOR TO ANY DIGGING, FOR STAKE OUT.
 - THE CONTRACTOR IS NOT RESPONSIBLE FOR ACCURACY OF SURVEY DRAWING.
 - EXISTING DRAINAGE PATTERNS TO REMAIN. ANY NEW SUMP PUMP INSTALLATIONS TO DISCHARGE IN REAR YARD. BUILDING FROM THESE SHALL PROCEED ONLY WHEN MARKED "ISSUED FOR CONSTRUCTION."
- EXISTING STRUCTURE NOTE:
- OWNER AND CONTRACTOR ARE FULLY RESPONSIBLE FOR VERIFYING ALL EXISTING GENERAL AND STRUCTURAL CONDITIONS PRIOR TO ANY WORK. ANY AND ALL DISCREPANCIES SHALL BE REPORTED TO SUITE ADDITIONS INC. PRIOR TO ANY WORK.
 - OWNER AND CONTRACTOR IS FULLY RESPONSIBLE FOR SHORING EXISTING STRUCTURE PRIOR TO ANY WORK IF REQUIRED.

CODE REFERENCES AND SPECIFICATIONS

1. FIRE PROTECTION MEASURES

ALL FIRE PROTECTION MEASURES MUST COMPLY WITH OBC 9.10. (U.O.N.)

2. CEILING HEIGHTS

CEILING HEIGHTS SHALL COMPLY WITH OBC 9.5.3.1. AND PART 11 – C102 OF TABLE 11.5.1.1.C.

PART 9:

BASEMENT SPACE - 2 100 mm (6'-10 3/4") over at least 75% of the basement area except that under beams and ducts the clearance is permitted to be reduced to 1 950 mm (6'-4 7/8")

PART 11 (COMPLIANCE ALTERNATIVE):

- In a house,
- (a) minimum room height shall not be less than 1 950 mm (6'-4 7/8") over the required floor area and in any location that would normally be used as a means of egress, or
 - (b) minimum room height shall not be less than 2 030 mm (6'-8") over at least 50% of the required floor area, provided that any part of the floor having a clear height of less than 1 400 mm (4'-7 1/8") shall not be considered in computing the required floor area.

3. EGRESS FROM DWELLING UNIT

EGRESS FROM DWELLING UNIT SHALL COMPLY WITH OBC 9.9.9 AND PART 11 COMPLIANCE – C136 OF TABLE 11.5.1.1.C.

PART 9:

9.9.9.1. Travel Limit to Exits or Egress Doors

- (1) Except as provided in Sentences (2) and (3), every dwelling unit containing more than 1 storey shall have exits or egress doors located so that it shall not be necessary to travel up or down more than 1 storey to reach a level served by,
 - (a) an egress door to a public corridor, enclosed exit stair or exterior passageway, or
 - (b) an exit doorway not more than 1 500 mm above adjacent ground level.
- (2) Where a dwelling unit is not located above or below another suite, the travel limit from a floor level in the dwelling unit to an exit or egress door is permitted to exceed 1 storey where that floor level is served by an openable window or door,
 - (a) providing an unobstructed opening of not less than 1 000 mm in height and 550 mm in width, and
 - (b) located so that the sill is not more than,
 - (i) 1 000 mm above the floor, and
 - (ii) 7 m above adjacent ground level.
- (3) The travel limit from a floor level in a dwelling unit to an exit or egress door is permitted to exceed 1 storey where that floor level has direct access to a balcony.

9.9.9.2. Two Separate Exits

- (1) Except as provided in Sentence 9.9.7.3.(1), where an egress door from a dwelling unit opens onto a public corridor or exterior passageway it shall be possible from the location where the egress door opens onto the corridor or exterior passageway to go in opposite directions to two separate exits unless the dwelling unit has a second and separate means of egress.

9.9.9.3. Shared Egress Facilities

- (1) A dwelling unit shall be provided with a second and separate means of egress where an egress door from the dwelling unit opens onto,
 - (a) an exit stairway serving more than one suite,
 - (b) a public corridor,
 - (i) serving more than one suite, and
 - (ii) served by a single exit,
 - (c) an exterior passageway,
 - (i) serving more than one suite,
 - (ii) served by a single exit stairway or ramp, and
 - (iii) more than 1.5 m above adjacent ground level, or
 - (d) a balcony,
 - (i) serving more than one suite,
 - (ii) served by a single exit stairway or ramp, and
 - (iii) more than 1.5 m above adjacent ground level.

PART 11 (COMPLIANCE ALTERNATIVE):

- In a house, exit requirements are acceptable if at least one of the following conditions exists:
- (a) a door, including a sliding door, that opens directly to the exterior from a dwelling unit, serves only that dwelling unit and has reasonable access to ground level, and the dwelling units are equipped with smoke alarms installed in conformance with Subsection 9.10.19.,
 - (b) an exit that is accessible to more than one dwelling unit and provides the only means of egress from each dwelling unit, provided that the means of egress is separated from the remainder of the building and common areas by a fire separation having a 30 min fire-resistance rating and provided further that the required access to exit from any dwelling unit cannot be through another dwelling unit, service room or other occupancy, and both dwelling units and common areas are provided with smoke alarms that are installed in conformance with Subsection 9.10.19. and are interconnected, or
 - (c) access to an exit from one dwelling unit which leads through another dwelling unit where,
 - (i) an additional means of escape is provided through a window that conforms to the following:
 - (A) the sill height is not more than 1 000 mm above or below adjacent ground level,
 - (B) the window can be opened from the inside without the use of tools,
 - (C) the window has an individual unobstructed open portion having a minimum area of 0.38 m² with no dimension less than 460 mm
 - (D) the sill height does not exceed 900 mm above the floor or fixed steps,
 - (E) where the window opens into a window well, a clearance of not less than 1 000 mm shall be provided in front of the window, and
 - (F) smoke alarms are installed in every dwelling unit and in common areas in conformance with Subsection 9.10.19. and are interconnected,
 - (ii) an additional means of escape is provided through a window that conforms to the following:
 - (A) the window is a casement window not less than 1 060 mm high, 560 mm wide, with a sill height not more than 900 mm above the inside floor,
 - (B) the sill height of the window is not more than 5 m above adjacent ground level, and
 - (C) smoke alarms are installed in every dwelling unit and in common areas in conformance with Subsection 9.10.19. and are interconnected, or (iii) the building is sprinklered and the dwelling units are equipped with smoke alarms installed in conformance with Subsection 9.10.19.

4. EGRESS FROM BEDROOMS

EGRESS FROM BEDROOMS SHALL COMPLY WITH OBC 9.9.10.1

PART 9:

- (1) Except where a door on the same floor level as the bedroom provides direct access to the exterior, every floor level containing a bedroom in a suite shall be provided with at least one outside window that,
 - (a) is openable from the inside without the use of tools,
 - (b) provides an individual, unobstructed open portion having a minimum area of 0.35 m² with no dimension less than 380 mm, and
 - (c) maintains the required opening described in Clause (b) without the need for additional support.
- (2) Except for basement areas, the window required in Sentence (1) shall have a maximum sill height of 1000 mm above the floor.
- (3) When sliding windows are used, the minimum dimension described in Sentence (1) shall apply to the openable portion of the window.
- (4) Where the sleeping area within a live/work unit is on a mezzanine with no obstructions more than 1 070 mm above the floor, the window required in Sentence (1) may be provided on the main level of the live/work unit provided the mezzanine is not more than 25% of the area of the live/work unit or 20 m², whichever is less, and an unobstructed direct path of travel is provided from the mezzanine to this window.
- (5) Where a window required in Sentence (1) opens into a window well, a clearance of not less than 550 mm shall be provided in front of the window.
- (6) Where the sash of a window referred to in Sentence (5) swings towards the window well, the operation of the sash shall not reduce the clearance in a manner that would restrict escape in an emergency.
- (7) Where a protective enclosure is installed over the window well referred to in Sentence (5), such enclosure shall be openable from the inside without the use of keys, tools or special knowledge of the opening mechanism.

ELETRONIC STAMP

5. SMOKE ALARMS

SMOKE ALARMS SHALL COMPLY WITH OBC 9.10.19. AND PART 11 COMPLIANCE – C175 OF TABLE 11.5.1.1.C.

PART 9:

9.10.19.1. Required Smoke Alarms

- (2) Smoke alarms conforming to CAN/ULC-S531, "Smoke Alarms", shall be installed in each dwelling unit and in each sleeping room not within a dwelling unit.
 - (3) Smoke alarms required in Sentence (1) shall have a visual signalling component conforming to the requirements in 18.5.3. (Light, Color and Pulse Characteristics) of NFPA 72, "National Fire Alarm and Signaling Code".
 - (4) The visual signalling component required in Sentence (2) need not, (a) be integrated with the smoke alarm provided it is interconnected to it, (b) be on battery backup, or (c) have synchronized flash rates, when installed in a dwelling unit.
 - (5) The luminous intensity for visual signalling components required in Sentence (2) that are installed in sleeping rooms shall be a minimum of 175 cd.
 - (6) Smoke alarms required in Sentence (1) shall be installed on or near the ceiling.
- 9.10.19.3. Location of Smoke Alarms
- (1) Within dwelling units, sufficient smoke alarms shall be installed so that,
 - (a) there is at least one smoke alarm installed on each storey, including basements, and
 - (b) on any storey of a dwelling unit containing sleeping rooms, a smoke alarm is installed,
 - (i) in each sleeping room, and
 - (ii) in a location between the sleeping rooms and the remainder of the storey, and if the sleeping rooms are served by a hallway, the smoke alarm shall be located in the hallway.
 - (2) Within a house that contains an interior shared means of egress or common area, a smoke alarm shall be installed in each shared means of egress and common area.
 - (3) A smoke alarm required in Sentences (1) and (2) shall be installed in conformance with CAN/ULC-S553, "Installation of Smoke Alarms".

9.10.19.4. Power Supply

- (1) Except as provided in Sentences (2) and (3), smoke alarms required in Sentences 9.10.19.1.(1) and 9.10.19.3.(2) shall,
 - (a) be installed with permanent connections to an electrical circuit,
 - (b) have no disconnect switch between the overcurrent device and the smoke alarm, and
 - (c) in case the regular power supply to the smoke alarm is interrupted, be provided with a battery as an alternative power source that can continue to provide power to the smoke alarm for a period of not less than 7 days in the normal condition, followed by 4 min of alarm.

9.10.19.5. Interconnection of Smoke Alarms

- (1) Where more than one smoke alarm is required in a dwelling unit, the smoke alarms shall be wired so that the activation of one alarm will cause all alarms within the dwelling unit to sound.

PART 11 (COMPLIANCE ALTERNATIVE):

Smoke alarms may be battery operated.



LEAD DESIGNER & CONSULTANT

KEN BEKENDAM
kenbekendam@gmail.com
C: (905)-961-0647
(855) - KINGHMS (546-4467)

LEAD ENGINEER

ROBERT MENDEZ P. ENG. 100054193
robertmendez@yahoo.com
C: (416)-807-1572



LEGAL
SECOND
SUITES

www.legalsecondsuites.com

ADDRESS:

13 GIBSON AVENUE
HAMILTON, ON.

CONSTRUCTION NOTES 1 OF 2

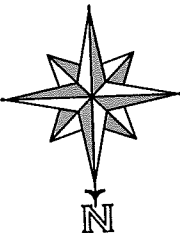

SCALE:

-

DATE:

SEPT 2020

PROJECT:

2 UNIT
CONVERSION

SHEET#:

A0.02

6. CARBON MONOXIDE ALARMS

CARBON MONOXIDE ALARMS SHALL COMPLY WITH OBC 9.33.4. AND PART 11 COMPLIANCE – C197 OF TABLE 11.5.1.1.C.

PART 9:

9.33.4.1. Application

- (1) This Subsection applies to every building that,
- (a) contains a residential occupancy, and
- (b) contains a fuel-burning appliance or a storage garage.

9.33.4.2. Location of Carbon Monoxide Alarms

- (1) Where a fuel-burning appliance is installed in a suite of residential occupancy, a carbon monoxide alarm shall be installed adjacent to each sleeping area in the suite.
- (2) Where a fuel-burning appliance is installed in a service room that is not in a suite of residential occupancy, a carbon monoxide alarm shall be installed,
- (a) adjacent to each sleeping area in every suite of residential occupancy that is adjacent to the service room, and
- (b) in the service room.
- (3) Where a storage garage is located in a building containing a residential occupancy, a carbon monoxide alarm shall be installed adjacent to each sleeping area in every suite of residential occupancy that is adjacent to the storage garage.
- (4) Where a storage garage serves only the dwelling unit to which it is attached or built in, a carbon monoxide alarm shall be installed adjacent to each sleeping area in the dwelling unit.
- (5) A carbon monoxide alarm shall be mechanically fixed,
- (a) at the manufacturer's recommended height, or
- (b) in the absence of specific instructions, on or near the ceiling.

9.33.4.3. Installation and Conformance to Standards

- (1) The carbon monoxide alarm required by Article 9.33.4.2. shall,
- (a) except as permitted in Sentence (2), be permanently connected to an electrical circuit and shall have no disconnect switch between the overcurrent device and the carbon monoxide alarm,
- (b) be wired so that its activation will activate all carbon monoxide alarms within the suite, where located within a suite of residential occupancy,
- (c) be equipped with an alarm that is audible within bedrooms when the intervening doors are closed, where located adjacent to a sleeping area, and
- (d) conform to,
- (i) CAN/CSA-6.19, "Residential Carbon Monoxide Alarming Devices", or
- (ii) UL 2034, "Single and Multiple Station Carbon Monoxide Alarms".
- (2) Where the building is not supplied with electrical power, carbon monoxide alarms are permitted to be battery operated.

PART 11 (COMPLIANCE ALTERNATIVE):.

Carbon monoxide alarms may be battery operated or plugged into an electrical outlet.

7. FIRE-RESISTANCE RATINGS FOR WALLS, COLUMNS AND ARCHES

FIRE-RESISTANCE RATINGS FOR WALLS, COLUMNS AND ARCHES SHALL COMPLY WITH OBC 9.10.8.3 AND PART 11 COMPLIANCE - C147 OF TABLE 11.5.1.1.C.

PART 9:

- (1) Except as otherwise provided in this Subsection, all load bearing walls, columns and arches in the storey immediately below a floor or roof assembly shall have a fire-resistance rating of not less than that required for the supported floor or roof assembly.

PART 11 (COMPLIANCE ALTERNATIVE):.

- (a) Except as provided in (b) and (c), 30 min rating is acceptable.
- (b) In a house, 15 min horizontal fire separation is acceptable where,
- (i) smoke alarms are installed in every dwelling unit and in common areas in conformance with Subsection 9.10.19., and
- (ii) smoke alarms are interconnected.
- (c) In a house, the fire-resistance rating of the fire separation is waived where the building is sprinklered.

8. SEPARATION OF SERVICE ROOMS

SEPARATION OF SERVICE ROOMS SHALL COMPLY WITH OBC 9.10.10.4

PART 9:

9.10.10.1. Appliances and Equipment to be Located in a Service Room

- (1) Except as provided in Sentences (2) and (3) and Article 9.10.10.5., fuel-fired appliances shall be located in a service room separated from the remainder of the building by a fire separation having not less than a 1 h fire-resistance rating.
- (2) Except as required in the appliance installation standards referenced in Sentences 6.2.1.4.(1) and 9.33.1.2.(1), fuel fired spaceheating appliances, space-cooling appliances and service water heaters need not be separated from the remainder of the building as required in Sentence (1) where the equipment serves,
- (a) not more than one room or suite,
- (b) a house, or
- (c) a building, other than a house, with a building area of not more than 400 m² and a building height of not more than 2 storeys.
- (3) Sentence (1) does not apply to fireplaces and cooking appliances.

9. SEPARATION OF RESIDENTIAL SUITES

SEPARATION OF RESIDENTIAL SUITES SHALL COMPLY WITH OBC 9.10.9.14 AND PART 11 COMPLIANCE - C152 OF TABLE 11.5.1.1.C.

PART 9:

- (1) Except as provided in Sentences (2) and (3) and Article 9.10.21.2., suites in residential occupancies shall be separated from adjacent rooms and suites by a fire separation having a fire-resistance rating of not less than 45 min.
- (2) Sleeping rooms in boarding, lodging or rooming houses where sleeping accommodation is provided for not more than 8 boarders or lodgers shall be separated from the remainder of the floor area by a fire separation having a fire-resistance rating of not less than 30 min where the sleeping rooms form part of the proprietor's residence and do not contain cooking facilities.
- (3) Except as provided in Sentences (4) and (5), dwelling units that contain 2 or more storeys including basements shall be separated from the remainder of the building by a fire separation having a fire-resistance rating of not less than 1 h.
- (4) Except as provided in Sentence (5), dwelling units in a house shall be separated from each other and common areas by a fire separation having a fire-resistance rating of not less than 45 min.
- (5) The fire-resistance rating of the fire separation required in Sentence (4) is permitted to be waived where the house is sprinklered.

PART 11 (COMPLIANCE ALTERNATIVE):

- (a) Except as provided in (b) and (c), 30 min fire separation is acceptable.
- (b) In a house, 15 min horizontal fire separation is acceptable where,
- (i) smoke alarms are installed in every dwelling unit and in common areas in conformance with Subsection 9.10.19., and
- (ii) smoke alarms are interconnected.
- (c) In a house, the fire-resistance rating of the fire separation is waived where the building is sprinklered.

10. CLOSURES (DOORS):

CLOSURES SHALL COMPLY WITH OBC 9.10.13.1 AND PART 11 COMPLIANCE - C155 OF TABLE 11.5.1.1.C.

PART 9:

- (1) Except as provided in Article 9.10.13.2., openings in required fire separations shall be protected with a closure conforming to Table 9.10.13.1. and shall be installed in conformance with NFPA 80, Fire Doors and Other Opening Protectives, unless otherwise specified in this Part.

PART 11 (COMPLIANCE ALTERNATIVE):

Existing functional closures are acceptable subject to C.A.'s C8 and C156.

- (a) Existing functional and sound doors in existing buildings that are either hollow metal or kalamein and containing wired glass at least 6 mm thick and conforming to Sentence 3.1.8.14.(2) are permitted in lieu of doors not required to exceed 45 min,
- (b) all existing functional and sound hollow metal or kalamein doors which carry existing 1.5 h labels are acceptable in lieu of current 1.5 h labels and may contain wired glass panels not exceeding 0.0645 m², at least 6 mm thick and conforming to Sentence 3.1.8.14.(2), and
- (c) every fire door, window assembly or glass block used as a closure in a required fire separation shall be installed in conformance with good engineering practice. In a house, existing unlabelled doors at least 45 mm solid core wood or metal clad are acceptable. For existing closures, ratings of 20 min will not be required where the entire floor area is sprinklered.

11. LAUNDRY FIXTURES

LAUNDRY FIXTURES SHALL COMPLY WITH OBC 9.31.4.2.

PART 9:

- (1) Laundry facilities or a space for laundry facilities shall be provided in every dwelling unit or grouped elsewhere in the building in a location conveniently accessible to occupants of every dwelling unit.

12. NATURAL VENTILATION

NATURAL VENTILATION SHALL COMPLY WITH OBC 9.32.2.1 AND PART 11 COMPLIANCE - C194 OF TABLE 11.5.1.1.C.

PART 9:

- (1) The unobstructed openable ventilation area to the outdoors for rooms and spaces in a residential occupancy ventilated by natural means shall conform to Table 9.32.2.1.

PART 11 (COMPLIANCE ALTERNATIVE):

In a house, rooms or spaces to be ventilated by natural means in accordance with Subsection 9.32.2. or by providing adequate mechanical ventilation.

ELETRONIC STAMP

13. ELECTRICAL FACILITIES

ELECTRICAL FACILITIES SHALL COMPLY WITH OBC 9.34.

14. INTERCONNECTION OF SYSTEMS

INTERCONNECTION OF SYSTEMS SHALL COMPLY WITH OBC 6.2.3.9 AND PART 11 COMPLIANCE – C91 OF TABLE 11.5.1.1.C.

PART 6:

- (1) In a residential occupancy, air from one suite shall not be circulated to any other suite or to a public corridor or public stairway.

PART 11 (COMPLIANCE ALTERNATIVE):

In a building containing not more than four dwelling units or residential suites, the existing heating or air-conditioning system may be altered to serve more than one dwelling unit or suite, provided smoke alarms are installed in each dwelling unit or suite and provided a smoke detector is installed in the supply or return air duct system serving the entire building which would turn off the fuel supply and electrical power to the heating system upon activation of such detector.

15. PENETRATIONS

PIPING, TUBING, DUCTS, CHIMNEYS, WIRING, CONDUIT, ELECTRICAL OUTLET BOXES AND OTHER SIMILAR SERVICE EQUIPMENT THAT PENETRATE A FIRE SEPARATION MUST BE NON COMBUSTIBLE AND FIRE STOPPED.

16. PLUMBING

ALL PLUMBING MUST CONFORM TO O.REG.332/12, DIV. B PART 7 OF THE BUILDING CODE

17. HANDRAILS AND GUARDRAILS

INSTALL HANDRAILS AND GUARDRAILS IN ACCORDANCE WITH 9.8.7. AND 9.8.8 OF THE BUILDING CODE RESPECTIVELY



DESIGN | BUILD | MANAGE

LEAD DESIGNER & CONSULTANT

KEN BEKENDAM
kenbekendam@gmail.com
C: (905)-961-0647
(855) - KINGHMS (546-4467)

LEAD ENGINEER

ROBERT MENDEZ P. ENG. 100054193
robertmendez@yahoo.com
C: (416)-807-1572

www.legalsecondsuites.com



LEGAL
SECOND
SUITES

ADDRESS:

13 GIBSON AVENUE
HAMILTON, ON.

CONSTRUCTION NOTES 2 OF 2

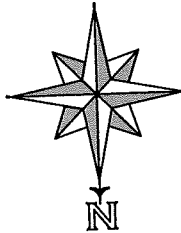

SCALE:

-

DATE:

SEPT 2020

PROJECT:

2 UNIT
CONVERSION

SHEET#:

A0.03



Ken Bekendam <kenbekendam@gmail.com>

13 Gibson Ave, Hamilton - Boulevard Parking Agreement

Lavallee, David <David.Lavallee@hamilton.ca>
To: Ken Bekendam <kenbekendam@gmail.com>

Thu, Sep 24, 2020 at 1:45 PM

Hi Ken

I received and reviewed your application.

The request meets all our requirements, except the 50% landscaping bylaw for the front yard as you know.

Once you receive the approved minor variance from the Committee Of Adjustment, email me a copy of it. Then we will provide you the approval letter for the 2 blvd parking spaces in the front yard.

Thanks.

David Lavallee
Parking Investigator
Hamilton Municipal Parking System
Transportation Planning & Parking
Planning & Economic Development, City of Hamilton
80 Main St. W. Hamilton, ON L8P 1H6
Tel: 905 546 2424 x 4578

[Quoted text hidden]



Hamilton

Planning and Economic Development Department
Planning Division

Committee of Adjustment
City Hall
5th floor 71 Main Street West
Hamilton, Ontario L8P 4Y5

Phone (905) 546-2424 ext.4221
Fax (905) 546-4202

**PLEASE FILL OUT THE FOLLOWING PAGES AND
RETURN TO THE CITY OF HAMILTON PLANNING
DEPARTMENT.**

20-187220

FOR OFFICE USE ONLY.

APPLICATION NO. Hm/A-20:210 DATE APPLICATION RECEIVED Oct. 7/20

PAID _____ DATE APPLICATION DEEMED COMPLETE _____

SECRETARY'S
SIGNATURE _____

**CITY OF HAMILTON
COMMITTEE OF ADJUSTMENT
HAMILTON, ONTARIO**

The Planning Act

Application for Minor Variance or for Permission

The undersigned hereby applies to the Committee of Adjustment for the City of Hamilton under Section 45 of the *Planning Act*, R.S.O. 1990, Chapter P.13 for relief, as described in this application, from the Zoning By-law.

1. Name of Owner Christopher Micucci

2.

3. Name of Agent Ken Bekendam

4.

Note: Unless otherwise requested all communications will be sent to the agent, if any.

5. Names and addresses of any mortgagees, holders of charges or other encumbrances:

n/a Postal Code _____

_____ Postal Code _____

6. Nature and extent of relief applied for:

Lot area reduction to 157 SQM

Parking reduction to 0 spaces

Landscape area reduction to 24%

7. Why it is not possible to comply with the provisions of the By-law?

Existing lot conditions

8. Legal description of subject lands (registered plan number and lot number or other legal description and where applicable, street and street number):

13 Gibson Ave, Hamilton

9. PREVIOUS USE OF PROPERTY

Residential ☒ Industrial ☐ Commercial ☐

Agricultural ☐ Vacant ☐

Other

9.1 If Industrial or Commercial, specify use

9.2 Has the grading of the subject land been changed by adding earth or other material, i.e. has filling occurred?

Yes ☐ No ☐ Unknown ☒

9.3 Has a gas station been located on the subject land or adjacent lands at any time?

Yes ☐ No ☐ Unknown ☒

9.4 Has there been petroleum or other fuel stored on the subject land or adjacent lands?

Yes ☐ No ☐ Unknown ☒

9.5 Are there or have there ever been underground storage tanks or buried waste on the subject land or adjacent lands?

Yes ☐ No ☐ Unknown ☒

9.6 Have the lands or adjacent lands ever been used as an agricultural operation where cyanide products may have been used as pesticides and/or sewage sludge was applied to the lands?

Yes ☐ No ☐ Unknown ☒

9.7 Have the lands or adjacent lands ever been used as a weapon firing range?

Yes ☐ No ☐ Unknown ☒

9.8 Is the nearest boundary line of the application within 500 metres (1,640 feet) of the fill area of an operational/non-operational landfill or dump?

Yes ☐ No ☐ Unknown ☒

9.9 If there are existing or previously existing buildings, are there any building materials remaining on site which are potentially hazardous to public health (eg. asbestos, PCB's)?

Yes _____ No _____ Unknown x _____

9.10 Is there any reason to believe the subject land may have been contaminated by former uses on the site or adjacent sites?

Yes _____ No _____ Unknown x _____

9.11 What information did you use to determine the answers to 9.1 to 9.10 above?

Existing Residential Use

9.12 If previous use of property is industrial or commercial or if YES to any of 9.2 to 9.10, a previous use inventory showing all former uses of the subject land, or if appropriate, the land adjacent to the subject land, is needed.

Is the previous use inventory attached? Yes _____ No _____

ACKNOWLEDGEMENT CLAUSE

I acknowledge that the City of Hamilton is not responsible for the identification and remediation of contamination on the property which is the subject of this Application – by reason of its approval to this Application.

Sept 18th, 2020

Date

Signature Property Owner

Christopher Micucci

Print Name of Owner

10. Dimensions of lands affected:

Frontage

Depth

Area

Width of street

See Site Plan

11. Particulars of all buildings and structures on or proposed for the subject lands: (Specify ground floor area, gross floor area, number of stories, width, length, height, etc.)

Existing:

See Site Plan

Proposed:

See Site Plan

12. Location of all buildings and structures on or proposed for the subject lands; (Specify distance from side, rear and front lot lines)

Existing:

See Site Plan

Proposed: See Site Plan

13. Date of acquisition of subject lands:
2020

14. Date of construction of all buildings and structures on subject lands:
unknown

15. Existing uses of the subject property: Residential

16. Existing uses of abutting properties: Residential

17. Length of time the existing uses of the subject property have continued:
unknown

18. Municipal services available: (check the appropriate space or spaces)

Water x Connected x

Sanitary Sewer x Connected x

Storm Sewers x

19. Present Official Plan/Secondary Plan provisions applying to the land:

20. Present Restricted Area By-law (Zoning By-law) provisions applying to the land:
D - One & Two Family Dwellings

21. Has the owner previously applied for relief in respect of the subject property?
Yes No x

If the answer is yes, describe briefly.

22. Is the subject property the subject of a current application for consent under Section 53 of the *Planning Act*?

Yes No x

23. The applicant shall attach to each copy of this application a plan showing the dimensions of the subject lands and of all abutting lands and showing the location, size and type of all buildings and structures on the subject and abutting lands, and where required by the Committee of Adjustment such plan shall be signed by an Ontario Land Surveyor.

NOTE: It is required that two copies of this application be filed with the secretary-treasurer of the Committee of Adjustment together with the maps