

**6 STOREY RESIDENTIAL / COMMERCIAL
MINIMUM 306sq.m. GFA COMMERCIAL USE**

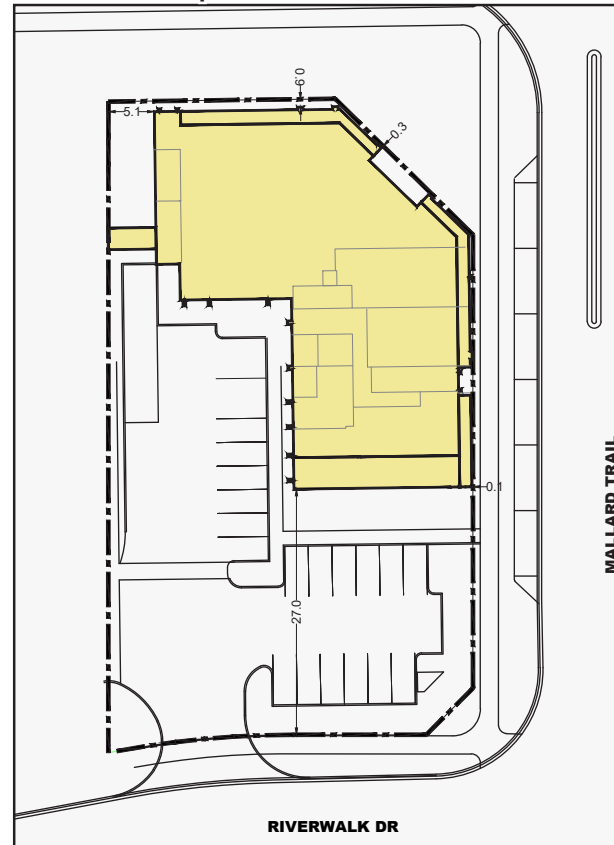

**2 STOREY COMMERCIAL
MINIMUM 950sq.m. GFA COMMERCIAL USE**

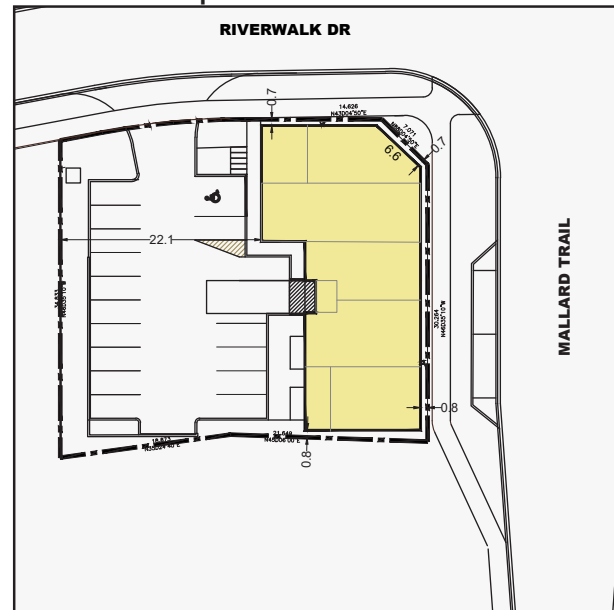

**2 STOREY RESIDENTIAL PROJECT
MINIMUM 306sq.m. GFA**

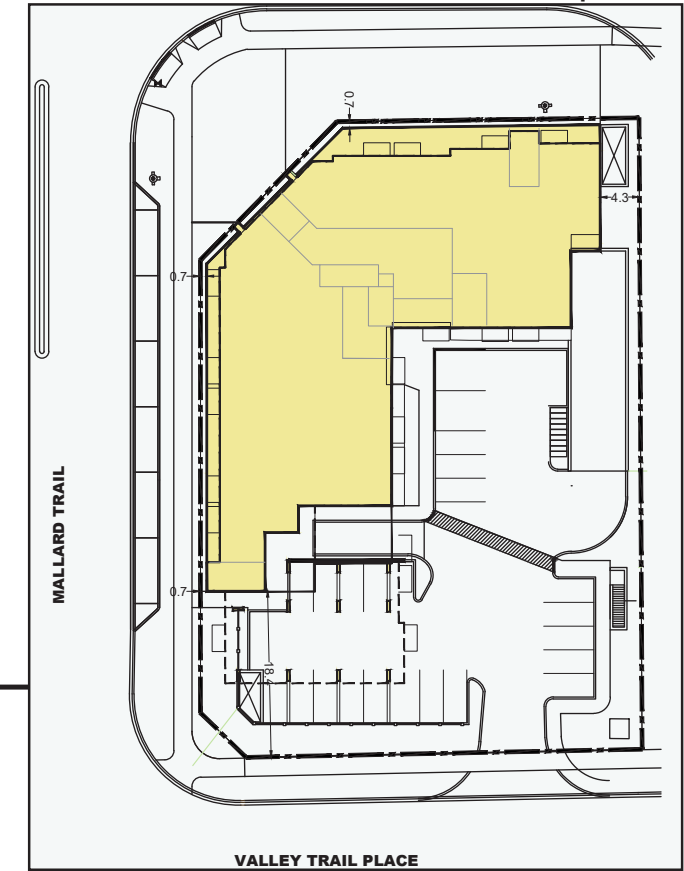

**3 STOREY RESIDENTIAL/COMMERCIAL
WITH ROOFTOP AMENITY
MIN 418sq.m. GFA COMMERCIAL USE**

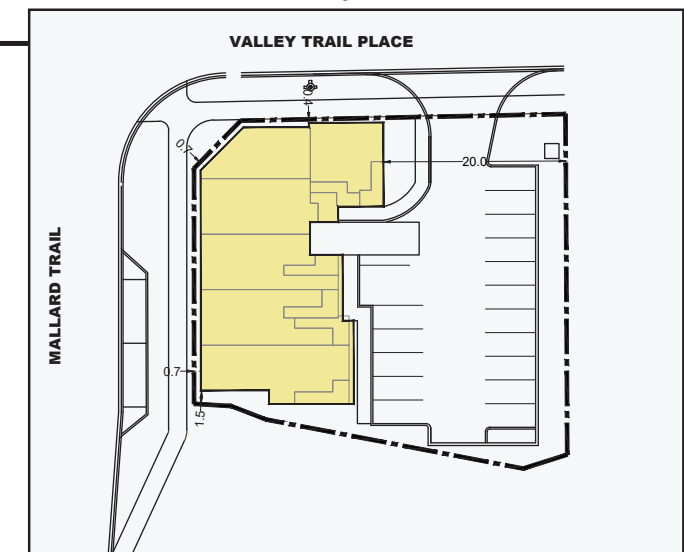

Concept Plan
Source: KNYMH (2020); Google Aerial Imagery (2018)

Figure
5