

CITY OF HAMILTON

PUBLIC WORKS DEPARTMENT *Environment & Sustainable Infrastructure Division*

TO: Chair and Members Public Works Committee	WARD(S) AFFECTED: CITY WIDE
COMMITTEE DATE: October 3, 2011	
SUBJECT/REPORT NO: School Board Funded Flashing Beacons - (PW11076) - (City Wide)	
SUBMITTED BY: Gerry Davis, CMA General Manager Public Works Department	PREPARED BY: Sue Russell (905) 546-2424, Extension 5660
SIGNATURE:	

RECOMMENDATION

- (a) That a “40 km/h when flashing” part-time speed limit be implemented on:
 - (i) Kitty Murray Lane abutting Immaculate Conception Catholic Elementary School
 - (ii) Braeheid Avenue abutting Guy B. Brown Elementary School
 - (iii) Skinner Avenue abutting St. Thomas Catholic Elementary School
 - (iv) Barton Street abutting Winona Elementary School;
- (b) That the associated costs for purchasing and installing the flashing beacon equipment be charged to Project ID# 4041020030;
- (c) That Appendix “A” respecting a By-law to amend the City of Hamilton Traffic By-law 01-215 attached to Report PW11076 be passed.

EXECUTIVE SUMMARY

The City’s Speed Limit Policy supports the use of part-time reduced speed limits on major roadways abutting schools. This program increases driver awareness of children travelling to and from school and thus has the potential to improve student safety. In new neighbourhood developments it has become a condition of subdivision approval that developers provide sufficient funds to cover the cost of implementing the school zone flashing beacons at the new school locations. In existing neighbourhoods, where a school is being reconstructed, the school boards are providing funds to cover the cost of implementing beacons where appropriate for the reconstructed school.

**SUBJECT: School Board Funded Flashing Beacons
(PW11076) - (City Wide) - Page 2 of 4**

Sufficient funds have been provided by developers and school boards for the implementation of the school zone flashers at three new schools and one reconstructed school. The subject schools are scheduled to be opened at various periods over the next year.

Alternatives for Consideration - See Page 3

FINANCIAL / STAFFING / LEGAL IMPLICATIONS

Financial: Sufficient funds have been deposited into and are available in School Board Flasher account # 4041020030 to cover the cost of purchasing and installing the flasher equipment and signs. It is estimated that total costs, including equipment and installation cost will be approximately \$15,000 per school location.

Staffing: The installation will be carried out internally by City staff.

Legal: The installation is supported by the City's Policy for Setting Speed Limits on City of Hamilton Roadways.

HISTORICAL BACKGROUND

The City's Policy for Setting Speed Limits on City of Hamilton Roadways supports the use of part-time reduced speed limits on major roadways abutting schools. Currently, staff have an evolving list of over 25 potential locations. The cost of implementing this program is approximately \$15,000 per location. At present, no funds have been designated in the capital budget for any of the existing schools on the list. As part of the development process, Traffic Planning staff have requested that developers of new school properties provide the funding for implementing this program on the roadway abutting a new school. As well, school boards have begun providing funds for schools which have undergone reconstruction. To date, funding has been provided for the implementation of the program at three new school locations and one reconstructed school location. The locations are as follows (see Appendix "B" for maps):

- Immaculate Conception Elementary School, Kitty Murray Lane, Ward 12
- Guy B. Brown School, Braeheid Avenue, Ward 15
- St. Thomas Catholic Elementary School, Skinner Avenue, Ward 15
- Winona Elementary School, Barton Street at Lewis Road, Ward 11

Two of the school locations are scheduled to be opened this year. The remaining two schools are scheduled to be opened in January 2012.

POLICY IMPLICATIONS

The subject recommendation is in keeping with the Council approved policy for "Setting Speed Limits on City of Hamilton Roadways".

The Part-time Reduced Speed Limits in School Zones Program is consistent with Vision 2020, the Corporate Strategic Plan and Public Works Business Plan "Innovative Now". This program provides a service that our communities can connect with and trust; a cleaner, greener, more connected and walkable city.

This program is also consistent with the goals of the Hamilton Strategic Road Safety Program of improving safety for vulnerable users. This program attempts to make roadways safer thus encouraging school age children to walk to school.

RELEVANT CONSULTATION

Hamilton Police Services are fully supportive of this program and will provide enforcement in school areas as necessary.

The Ward Councillors of the subject schools have been advised and are in favour of the proposal to install the Part-time Reduced Speed Limits in School Zones Program at the subject schools in their Ward.

ANALYSIS / RATIONALE FOR RECOMMENDATION

The recommendation is in keeping with the approved policy and therefore, staff supports implementing a part-time reduced speed limit on roadways abutting schools.

This program increases driver awareness of children travelling to and from school thus has the potential to improve student safety.

ALTERNATIVES FOR CONSIDERATION

The alternative would be to not implement a part-time speed limit adjacent to the schools.

CORPORATE STRATEGIC PLAN

Focus Areas: 1. Skilled, Innovative and Respectful Organization, 2. Financial Sustainability, 3. Intergovernmental Relationships, 4. Growing Our Economy, 5. Social Development, 6. Environmental Stewardship, 7. Healthy Community

Skilled, Innovative & Respectful Organization

- ♦ More innovation, greater teamwork, better client focus
- ♦ An enabling work environment - respectful culture, well-being and safety, effective communication

Financial Sustainability

- ♦ Financially Sustainable City by 2020
- ♦ Delivery of municipal services and management capital assets/liabilities in a sustainable, innovative and cost effective manner
- ♦ Address infrastructure deficiencies and unfunded liabilities

Intergovernmental Relationships

- ♦ Maintain effective relationships with other public agencies

Growing Our Economy

- ♦ An improved customer service

Social Development

- ♦ People participate in all aspects of community life without barriers or stigma

Environmental Stewardship

- ♦ Aspiring to the highest environmental standards

Healthy Community

- ♦ This program has the potential to improve student safety when travelling to school
- ♦ Plan and manage the built environment
- ♦ An engaged Citizenry

APPENDICES / SCHEDULES

Appendix "A": By-law to amend the City of Hamilton Traffic By-law 01-215

Appendix "B": Location Maps

Authority: Item: Name of Committee
Report:
CM: Date

Bill No.

CITY OF HAMILTON

BY-LAW NO. 11-

To Amend By-law No. 01-215 Being a By-law To Regulate Traffic

WHEREAS sections 8, 9 and 10 of the Municipal Act, 2001, S.O. 2001, c. 25, authorize the City of Hamilton to pass by-laws as necessary or desirable for the public and municipal purposes, and in particular paragraphs 4 through 8 of subsection 10(2) authorize by-laws respecting: assets of the municipality, the economic, social and environmental well-being of the municipality; health, safety and well-being of persons; the provision of any service or thing that it considers necessary or desirable for the public; and the protection of persons and property;

AND WHEREAS on the 18th day of September, 2001, the Council of the City of Hamilton enacted By-law No. 01-215 to regulate traffic;

AND WHEREAS it is necessary to amend By-law No. 01-215.

NOW THEREFORE the Council of the City of Hamilton enacts as follows:

1. Schedule 3 (Flashing School Zones – Reduced Speed Limit) of By-law No. 01-215, as amended, is hereby further amended by adding to Section "A" (Ancaster) thereof the following item, namely:

"Kitty Murray	97m north of Garner to 32m south of Roelfson	40	8:30 a.m. to 9:15 a.m.
---------------	--	----	------------------------

by adding to Section "C" (Flamborough) thereof the following items, namely:

"Braeheid	Riley to 36 m north of Fenton	40	8:05 a.m. to 8:50 a.m.
-----------	-------------------------------	----	------------------------

Skinner	Burke to 150m east of McKnight	40	8:25 a.m. to 9:10 a.m.
---------	--------------------------------	----	------------------------

by adding to Section "F" (Stoney Creek) thereof the following item, namely:

"Barton	365m west of Lewis to 150m east of Lewis	40	7:30 a.m. to 8:15 a.m.
---------	--	----	------------------------

2. Schedule 2 (Speed Limits) of By-law No. 01-215, as amended, is hereby further amended by deleting from Section "C" (Flamborough) thereof the following item, namely:

"Braeheid Ave.	Riley St. 30 m northwest of Fenton Dr.	40km/h"
----------------	--	---------

3. Subject to the amendments made in this By-law, in all other respects, By-law No. 01-215, including all Schedules thereto, as amended, is hereby confirmed unchanged.
4. This By-law shall come into force and take effect on the date of its passing and enactment.

PASSED and ENACTED this day of , 2011.

R. Bratina

Mayor

Rose Caterini

City Clerk

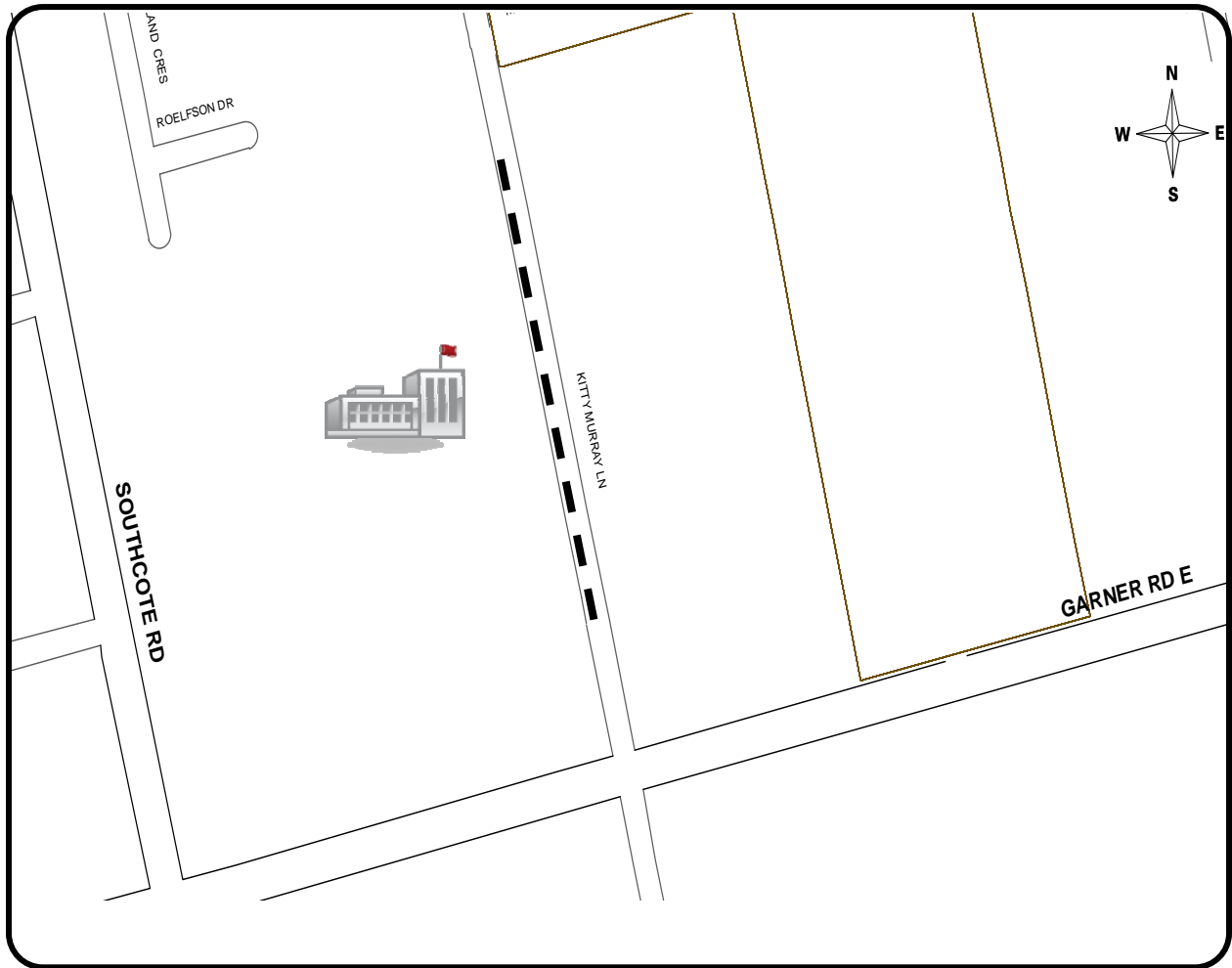

KEY MAP

HAMILTON
WARD 12

Immaculate Conception
Catholic Elementary
School

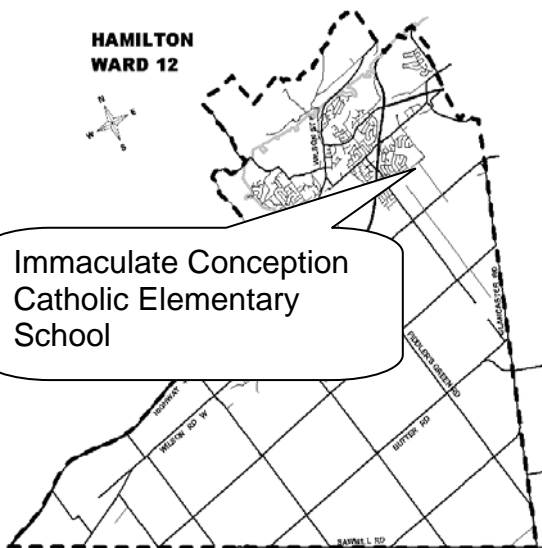

LOCATION PLAN

PART-TIME REDUCED SPEED

Immaculate Conception Catholic Elementary
School
Kitty Murray Lane
CITY OF HAMILTON
Public Works Department

LEGEND

SUBJECT ROAD
Proposed Part-time 40 km/h Zone

SCALE
NOT TO SCALE

DATE
2011-09-27

REFERENCE FILE NO: PW11076

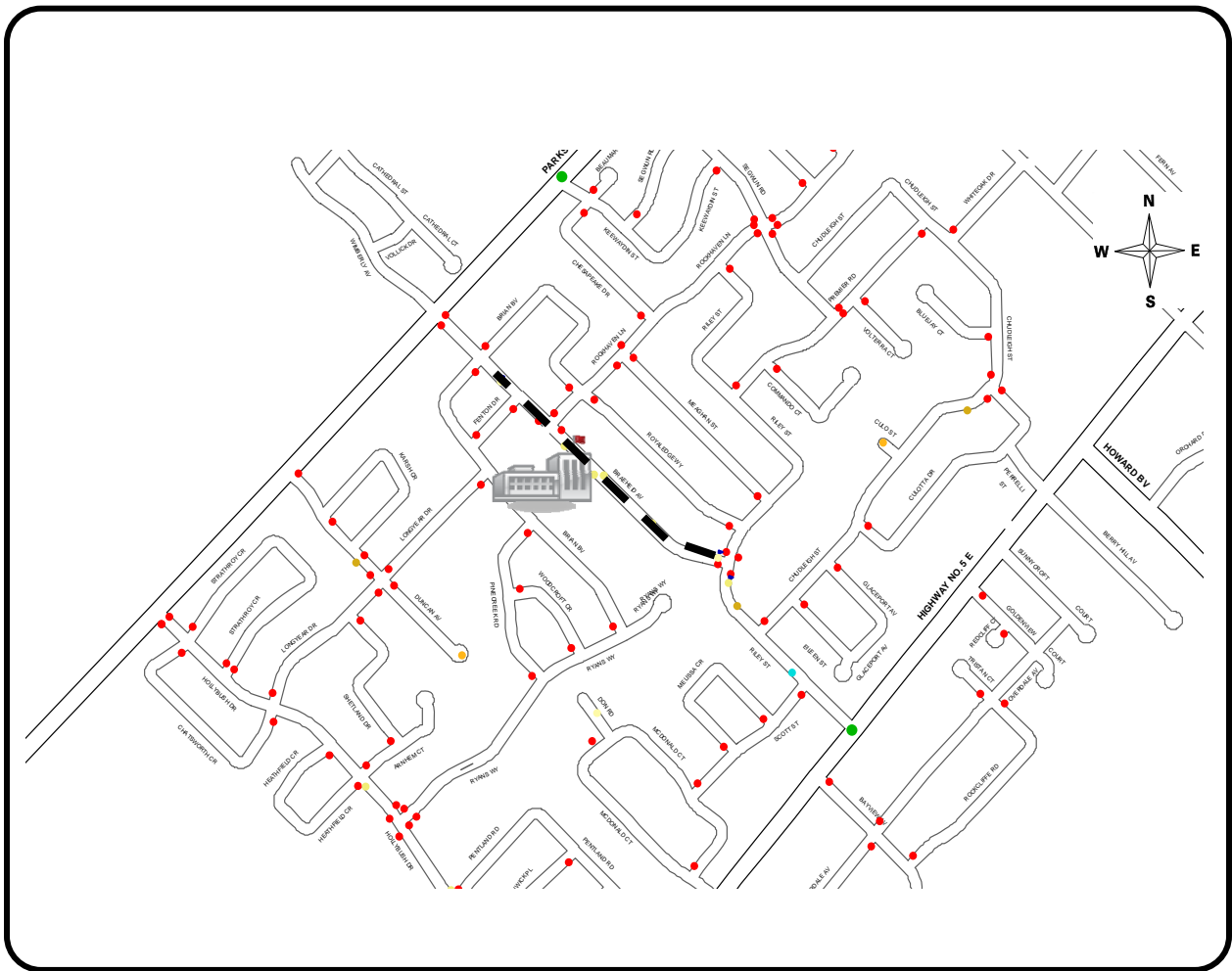

KEY MAP

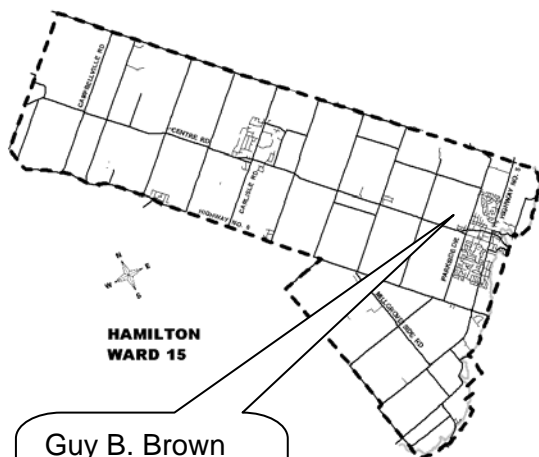

Guy B. Brown
Elementary
School

LOCATION PLAN

PART-TIME REDUCED SPEED

Guy B. Brown Elementary School
Braeheid Avenue
CITY OF HAMILTON
Public Works Department

LEGEND

SUBJECT ROAD
Proposed Part-time 40 km/h Zone

SCALE
NOT TO SCALE

DATE
2011-09-27

REFERENCE FILE NO: PW11076

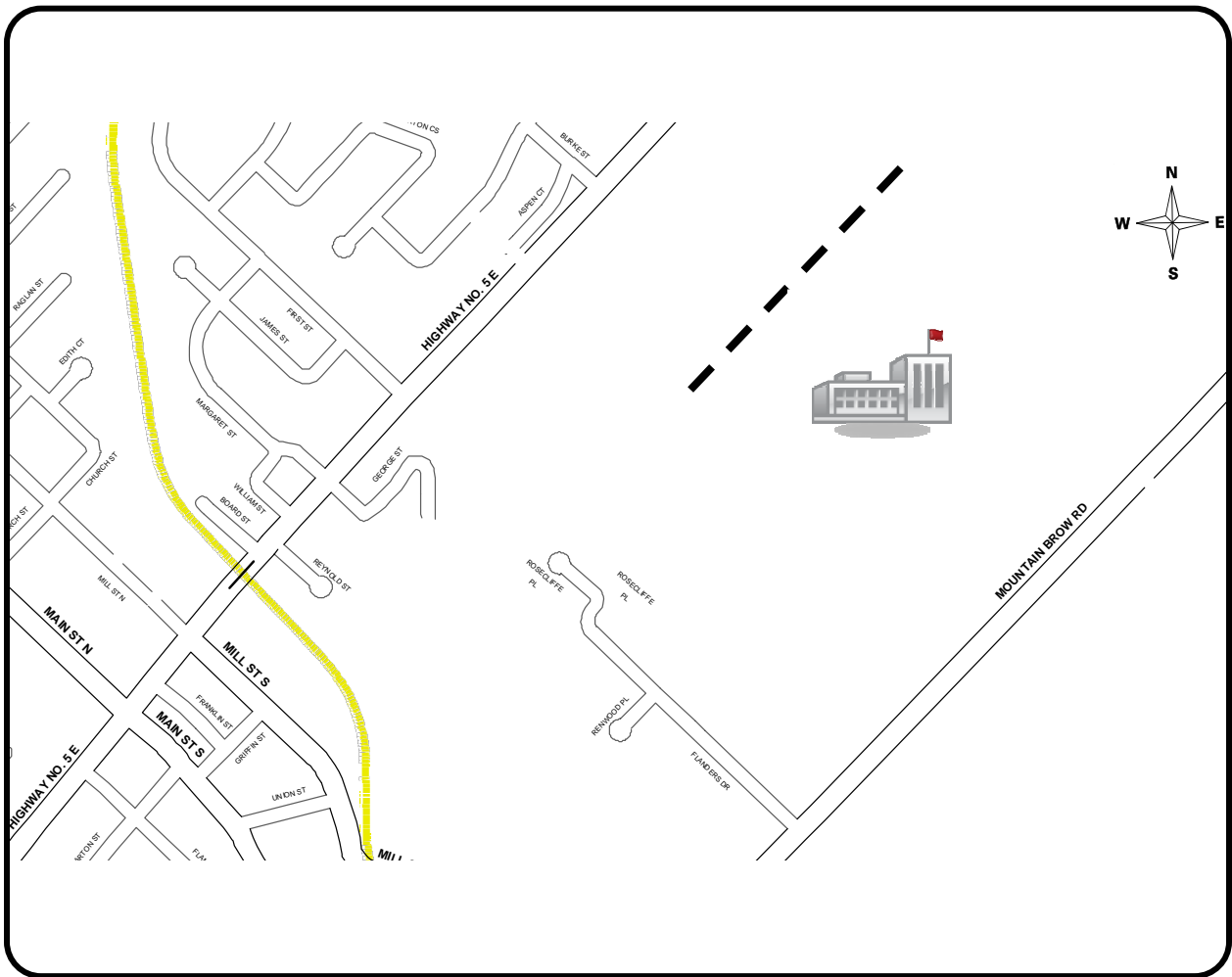

KEY MAP

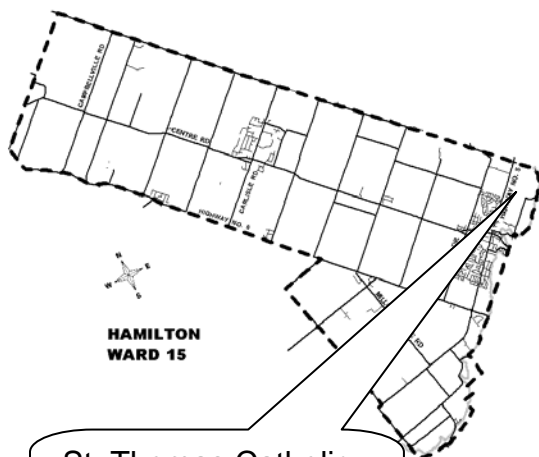

St. Thomas Catholic
Elementary School

LOCATION PLAN

PART-TIME REDUCED SPEED

St. Thomas Catholic Elementary School
Skinner Avenue
School Area
CITY OF HAMILTON
Public Works Department

LEGEND

Current map of area not available

SUBJECT ROAD
Proposed Part-time 40 km/h Zone

SCALE
NOT TO SCALE

DATE
2011-09-27

REFERENCE FILE NO: PW11076

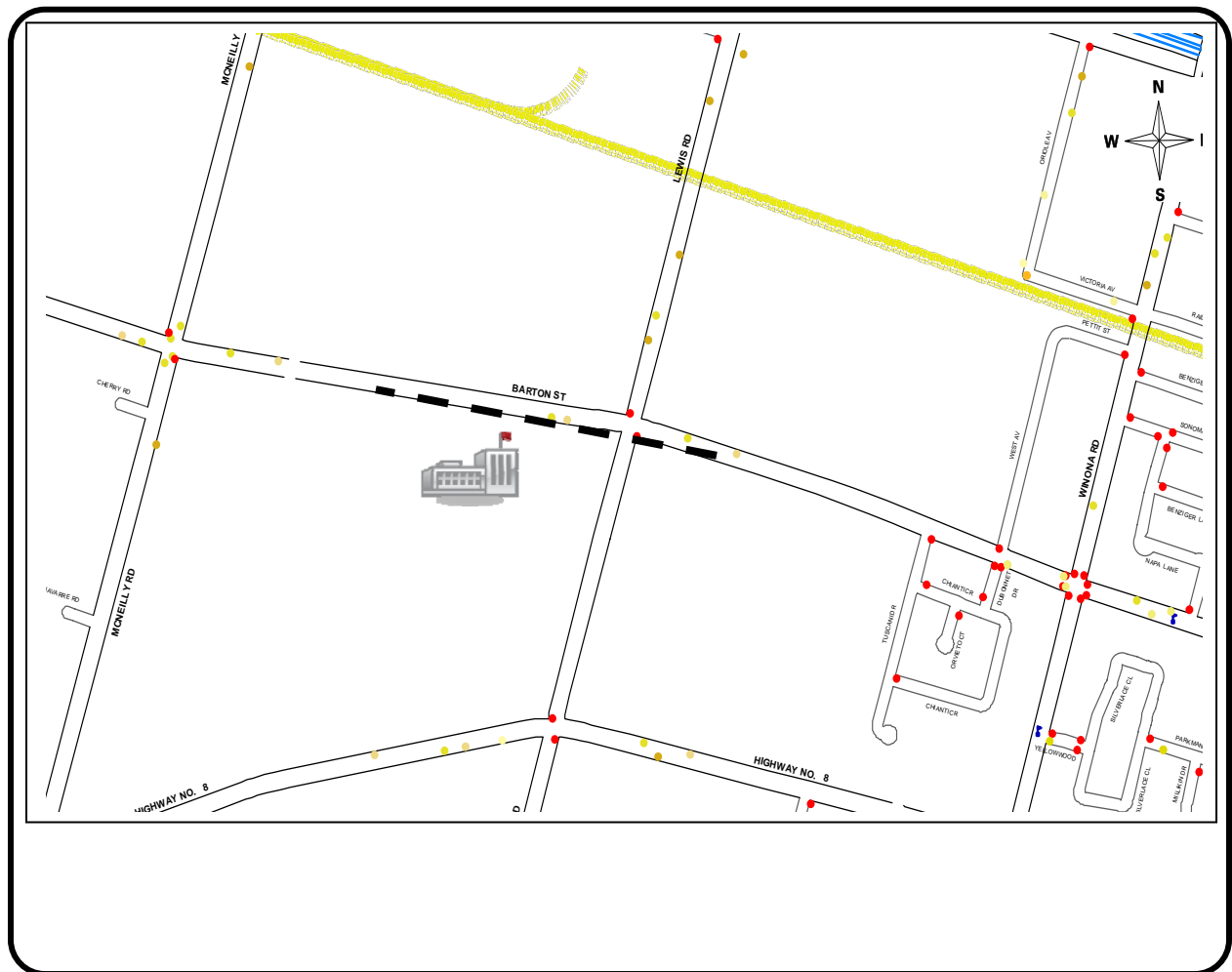

KEY MAP

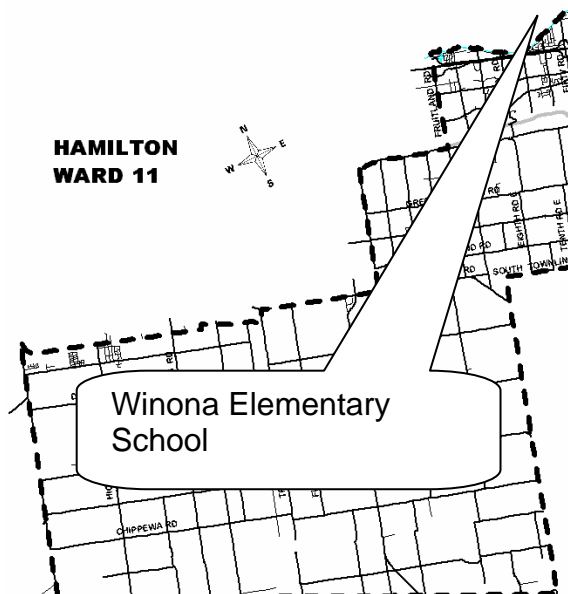

LOCATION PLAN

PART-TIME REDUCED SPEED

Winona Elementary School
Barton Street
School Area
CITY OF HAMILTON
Public Works Department

LEGEND

SUBJECT ROAD
Proposed Part-time 40 km/h Zone

SCALE
NOT TO SCALE

DATE
2011-09-27

REFERENCE FILE NO: PW11076